

## TS 510

Spare Parts  
Pieces de rechange  
Piezas de repositesto

TS 510 (Electric)

PART NO.	POS.	DESCRIPTION	PART NO.	POS.	DESCRIPTION
539 30 00-74	H	Collar, Set - 1/2" ID	542 03 20-72*	F	Impeller, G-300
539 99 05-80	B1	HWHSTS .250-20 x .75 Type F	502 62 13-03*	F	Water Pump 230V, 50Hz
542 00 08-06	B1	Motor, 3HP, 208-230/460/ 60Hz 3-Ph	542 03 20-88*	F	Water Pump 115V G-300
542 00 09-23	B1	Motor, 5HP, 208-230/460/ 60Hz 3-Ph	542 03 20-93*	F	Volute, G-300
542 00 09-25	B1	Motor, 5HP, 575/ 60Hz 3-Ph	542 03 20-94*	F	Gaskets
542 00 12-57	C1	Motor, 7.5HP, 575/ 60Hz 3-Ph	542 03 20-95*	F	O-Ring #032 G-300
542 00 12-65	C1	Motor, 7.5HP, 230/460/ 60Hz 3-Ph	542 03 21-22*	F	RHSTS, 8-18 x .5 Type BT
542 00 12-70	C1	Motor, 7.5HP, 230/380/ 50Hz 3-Ph	542 03 21-23*	F	FLHSTS, 8-18 x .5 Type F
542 02 00-10*	D2	Key, Woodruff #405	542 03 22-40*	D2	Crank Handle Assembly
542 02 00-12*	D2	CB, .250-20 x 1.00	542 03 23-42*	D1	Drain Hose, 1-7/8 ID x 14"
542 02 00-22*	D1	CB, .375-16 x 2.50	542 03 23-66*	A,E	Nut, Keys .313
542 02 00-24*	D2	CB, .625-11 x 2.50	542 03 23-72*	D1	Curtain, Splash - TS510
542 02 00-62*	A,B1	Key, Square .188 x 1.25 Lg	542 03 24-71*	D1	Bar, Bearing Clamp
542 02 01-36*	D1	Nut, Std Hex .375-16	542 03 24-75*	D1	Washer, Cotton .094 x .375 x 1.25
542 02 01-69*	D2	Nut, Jam Thin .312-18	542 03 25-01*	A	Shim, Brass .005 Thick
542 02 01-71*	G	Nut, Jam Hex Hd .375-24 RH	542 03 25-02*	A	Shim, Brass .015 Thick
542 02 01-75*	D2	Nut, Hex Jam Thin .625-11	542 03 25-03*	A	Shim, Brass .020 Thick
542 02 01-77*	A	Nut, Jam Hex Hd .500-13	542 03 25-41*	B2	Cover, Dust Proof Switch Box
542 02 01-94*	B	Locknut, Fiber #10-24	542 03 25-70*	D2	Screw, Adjustment
542 02 01-95*	A,C2,D2,E,H	Locknut, Fiber .25-20	542 03 25-80*	D2	Stop Sleeve
542 02 01-97*	D2	Locknut, Fiber .3125-18	542 03 26-05*	F	Water Pump Assy 115V/50-60Hz G300
542 02 01-99*	A,B1,C1,D2	Locknut, Fiber .375-16	542 03 26-06*	F	Water Pump Assy 230V/50-60Hz G300
542 02 02-01*	H	Locknut, Fiber .500-13	542 03 26-60*	D1	Bearing Clamp
542 02 02-11*	D2	Nut, Acorn .5-13	542 03 40-02*	H	Wheel, 10" x 2.375 x .625 Bore
542 02 02-61*	D2	Clamp, Hose A22	542 04 01-39*	D2	Fitting, Grease 1/8 NPT
542 02 03-01*	A,E	HHCS, .25-20 X .625 Gr 5	542 04 01-84*	D2	Boot, Rubber, 4" Lg
542 02 03-16*	A	HHCS, .312-24 x 1.00	542 04 61-28	G	Decal: Warning (Blade Guard Size)
542 02 03-23*	B1,C1	HHCS, .375-16 x 1.00	542 04 63-26*	B1	Decal: 3-Wire Grounded Plug
542 02 03-52*	H	HHCS, .5-13 x 5	542 04 63-27*	B1	Decal: Cord Usages
542 02 03-61*	H	HHCS, .625-11 x 3.75	542 04 87-40*	H	HHCS, .375-16 x 1.25 Gr5
542 02 03-70*	A,C2	HHCS, .250-20 x .75	542 05 01-71*	F	Screen, LRS
542 02 03-74*	D1	HHCS, .312-18 x 3.00	542 06 01-05*	B1	Pulley 2G3V3.15 - .75 w/SS
542 02 03-78*	A	HHCS, .500-20 x 1.00	542 06 01-06*	B1	Pulley 2G3V2.8 - w/1108 T-Lok - .75
542 02 03-80*	A	HHCS, .375-11 x 1.75	542 06 01-39*	B1	Pulley 2G3V2.65 - .875 w/SS
542 02 04-24*	G	RHMS, #10-32 X .375 Brass	542 06 03-05*	D2	Bolt, Eye .313-18NC X 1.00
542 02 04-25*	G	RHMS, #10-32 X .5 Brass	542 06 04-60*	D1	Yoke End
542 02 04-45*	E	FLHMS, .25-20 x .75	542 06 04-65*	D1	Pin, Clevis .375 Dia
542 02 05-09*	D2	HHCS, .375-16 X 2.00 Gr 5	542 09 05-78*	G	Water Valve, 1/4NPT M x 1/4NPT F
542 02 05-41*	C1	SHSS, Cup Pt .250-20 x .375	542 13 92-59	C1	Pulley: 3G3VX2.65 - 1108
542 02 05-48*	A	SHSS, Cup Pt #10-24 x .375	542 13 92-73	A	Brg w/seal, 20ID x 47OD x 14mm
542 02 05-50*	B1	SHSS, Cup .313-18 x .375	542 13 95-68	A	Grip, Handle
542 02 06-11*	G	Pin, Cotter .094 x .625	542 13 95-81*	D2	Spring, Foot Pedal
542 02 06-12*	D1,D2	Pin, Cotter .094 x .75	542 16 00-80*	D2	Pin, Snapper .375 Dia
542 02 07-01*	G	Pop Rivet, USM #D88BS	542 16 01-64*	D2	Pin, Clevis .50 Dia x 1.13 Lg
542 02 07-41*	A,B1	Washer, Flat .250 Dia	542 16 11-76*	G	Elbow, 90° Barb 3/8Hose x 1/4NPT
542 02 07-42*	A,D1	Washer, Flat .313 Dia	542 16 14-90*	F	Plate, Front
542 02 07-43*	B1,C1,D1	Washer, Flat .375 Dia	542 16 15-81*	B2	Switch 30A,250v
542 02 07-62*	D2,G	Washer, Flat .250 SAE	542 16 17-76*	F	Tubing, Vinyl 3/8 ID x 42"
542 02 07-63*	E	Washer, Flat .312 SAE	542 16 21-54*	D2	Pin, Clevis
542 02 07-64	D1,H	Washer, Flat .375 Dia	542 16 36-83*	B1	V-Belt 3VX530
542 02 07-66*	D2	Washer, Flat .500 SAE	542 16 74-85*	C2	Lock Nut M4 x 7.0
542 02 07-67*	H	Washer, Flat .625 SAE	542 16 77-42*	H	Spacer, 3/8 ID x 11/16ly, Plastic
542 02 07-85*	A	Lockwasher, Split .313	542 16 20-42	B1	Motor, 5HP, 220-240/ 50Hz 1-Ph
542 02 08-13*	G	Fit., 1/4 NPT Street Elbow Br	542 16 20-53	C1	Hub, Tapper-Lock 1108 x .875
542 03 00-71*	B2	Switch Assy, 3-5HP, 3-Phase - compl	542 16 26-85*	H	FLHCS, 1/4-20 x 1.08
542 03 03-51*	E	Guide, Measuring Assembly	542 16 96-22	B1	Motor, 5HP 208-230V 60Hz 1-Ph
542 03 03-86*	D1	Drain Plug Assembly	542 16 96-56	B1	Motor, 3HP, 115/208-230V 60Hz 1-Ph
542 03 05-80*	A	Bearing, Head Pivot	542 17 00-38*	E	Vinyl Tubing, 3/8 ID
542 03 06-54*	F	Insert, Hose Barb	542 17 03-10	B1	Motor, 5HP, 220-380/ 50Hz 3-Ph
542 03 08-22*	E	Wheel, Cart	542 17 69-33*	C2	Ring, Sealing, 3/4"
542 03 08-40*	G	Link, Stay-Level	542 17 69-53*	B2,C2	Lock Nut, 3/4" Conduit
542 03 08-60*	G	Track, Stay Level Blade Guard	542 17 73-83*	A	Wrench, 1/2 x 3/4
542 03 08-65*	G	Water Tube Assembly - 14"	542 17 75-88*	G	Decal: Warning - Large
542 03 08-70*	G	Manifold, Water	542 17 76-96*	A	Drawbolt, .375 - 16
542 03 08-75*	G	Gasket, Water Manifold	542 17 77-21*	D1	Knob, .313 - 18 x 1.75
542 03 08-84*	D1	Skid, 2 x 4 x 47.5 Lg	542 17 78-94*	E	Wood Insert
542 03 08-91*	G	Tube, Water Assy - 20"	542 17 79-04*	E	RHWS #8-32 x 1.25 Phillip
542 03 09-02*	B1	Pulley 2G3V3.15 - w/1210 T-Lok - .875	542 17 79-73*	A	Collar, Inner
542 03 09-06*	B1	Pulley 2G3V2.25 - .875 w/SS	542 17 79-76*	E	Decal, Ruler Set, TS 510
542 03 09-16*	C1	Pulley 3G3V3.0 - .875 w/SS	542 18 00-54*	A	Shield, Blade Guard, Galvanized
542 03 09-19*	C1	Pulley 3G3V2.25- .875 w/SS & Key	542 18 00-55*	A	Guard, Inner, Blade Belts
542 03 09-21*	B1	Pulley 2G3V3.35 - .75 w/SS	542 18 08-09*	B2	Cable, 12-5 x 35" Lg.
542 03 09-30*	C1	V-Belt: 3VX530 (Set of 3)	542 18 08-10	B2	Switch Assy, 3-5HP, 1-Phase - compl
542 03 09-31*	B1	Pulley 2G3V3.0 - .875 w/SS	542 18 08-10*	B2	Switch Assy, 3-5HP, 1-Phase - compl
542 03 09-51*	A	Flange, Outer	542 18 08-14*	B2	Switch Box, 3/4 NPT
542 03 10-37*	G	Quick Disconnect Body	542 18 08-15*	B2	Connector, cable, 90° x 3/4 NPT
542 03 10-39*	G	Stud, QD Ball	542 18 09-87*	E	Knob, Tee 5/16-18 x 1.00

NOTE: Part No's. that have an ASTERISK (\*) suffix may not be active 9-digit numbers. The '542' prefix has been added to current 6-digit part numbers and '0' to 7 and 8-digit numbers.

**TS 510 (Electric)**

<b>PART NO.</b>	<b>POS.</b>	<b>DESCRIPTION</b>	<b>PART NO.</b>	<b>POS.</b>	<b>DESCRIPTION</b>
542 18 20-18*	C2	Cord, Type S0 12GA (3.17' )			
542 18 20-18*	C2	Cord, Type S0 12GA (3.5' )			
542 18 20-24*	C2	Strain Relief, Water Tight 3/4			
542 18 60-00	E	Cart, Conveyor w/ Rubber Top			
542 18 60-57*	E	Backstop, Conveyor Cart, TS510			
542 18 62-52	C2	Starter, Motor 575V - 3Ph			
542 18 92-47*	B1,C1	Decal: Water Pump Outlet			
542 19 00-69	C2	Bracket, Switch Box - PC Blk			
542 19 01-02	C2	Starter, Motor 460V - 3Ph			
542 19 01-03	C2	Starter, Motor 230V - 3Ph			
542 19 04-18	E	Cart Assy, Conveyor			
542 19 04-34	D2	Bearing, 2-Bolt Flange .500 ID			
542 19 07-26	D1	Decal: Husqvarna Target GM - TS510			
542 19 07-33	A,D1	Decal: Husqvarna, 9.8"			
542 19 07-34	A	Decal: Husqvarna, 5"			
542 19 50-17*	A	Blade Shaft, TS 510			
542 19 52-36	C1	Pulley, 3G3V3.35 - .75 w/SS			
542 19 71-01	C2	Cable Tie, Plastic 8" X .094			
542 19 72-90*	C2	Washer, Flat MK			
542 19 72-93*	C2	PHMS, MK x 16 Gr. 4.8			
542 20 53-38	D1	Bracket, Tilt Arm, PC H. Grey			
542 20 53-42	A	Arbor Housing, PC H. Grey			
542 20 53-44	D1	Frame Weldment, PC H. Orange			
542 20 53-50	D2	Tilt Frame Weldment, PC H. Grey			
542 20 53-52	D2	Foot Pedal Wldmt, PC H. Grey			
542 20 53-64	D2	Tilt Adjust Yoke PC H. Grey			
542 20 53-80	A	Belt Guard, PC H. Orange			
542 20 53-81	A	Head Platform Wldmt, PC H. Grey			
542 20 53-82	D2	Adj. Nut Weld Assy. PC H. Grey			
542 20 53-84	A	Handle, Tubing, PC H. Grey			
542 20 54-31	H	Lever Weldment, PC H. Orange			
542 20 54-32	H	Handle Lever, H. Orange			
542 20 54-33	H	Stop Plat, PC H. Orange			
542 20 54-35	G	Blade Guard Assy - compl 20"			
542 20 54-36	G	Blade Guard Assy - compl 14"			
<b>MISC ITEMS &amp; SPECIAL KITS</b>			<b>LEGEND</b>		
542 20 11-05	N/S	OM Op Inst: TS 510 (Electric)	BHMS		Button Head Machine Screw
542 20 11-14	N/S	IPL Parts List: TS 510 (Electric)	FLHMS		FLat Head Machine Screw
			FLHSTS		Flat Head Self-Tapping Screw
			HHCS		Hex Head Cap Screw
000 A0 30-00	H	Instr Sheet: Wheel-Around Kit	HWHSTS		Hex Washer Head Self-Tapping Screw
			RHMS		Round Head Machine Screw
542 20 54-37	A	Kit, Bladeshaft Assy - TS 510E	RHSTS		Round Head Self-Tapping Screw
542 03 00-49*	E	Kit, Conveyor Cart Wheel	RHWS		Round Head Wood Screw
542 03 21-24*	F	Kit, Repair Water Pump G-300	SBHMS		Socket Button Head Machine Screw
542 03 40-00	H	Kit, Wheel Around - TS 310	SHCS		Socket Head Cap Screw
			SHSS		Scocker Head Set Screw
			STS		Self-Tapping Screw
			PHCS		Pan Head Cap Screw
			PHMS		Pan Head Machine Screw
			PHSTS		Pan Head Self-Tapping Screw
			FT		Full Thread
			Gr		Grade

NOTE: Part No's. that have an ASTERISK (\*) suffix may not be active 9-digit numbers. The '542' prefix has been added to current 6-digit part numbers and '0' to 7 and 8-digit numbers.

# A Head Platform

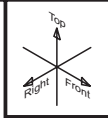

12.06.06

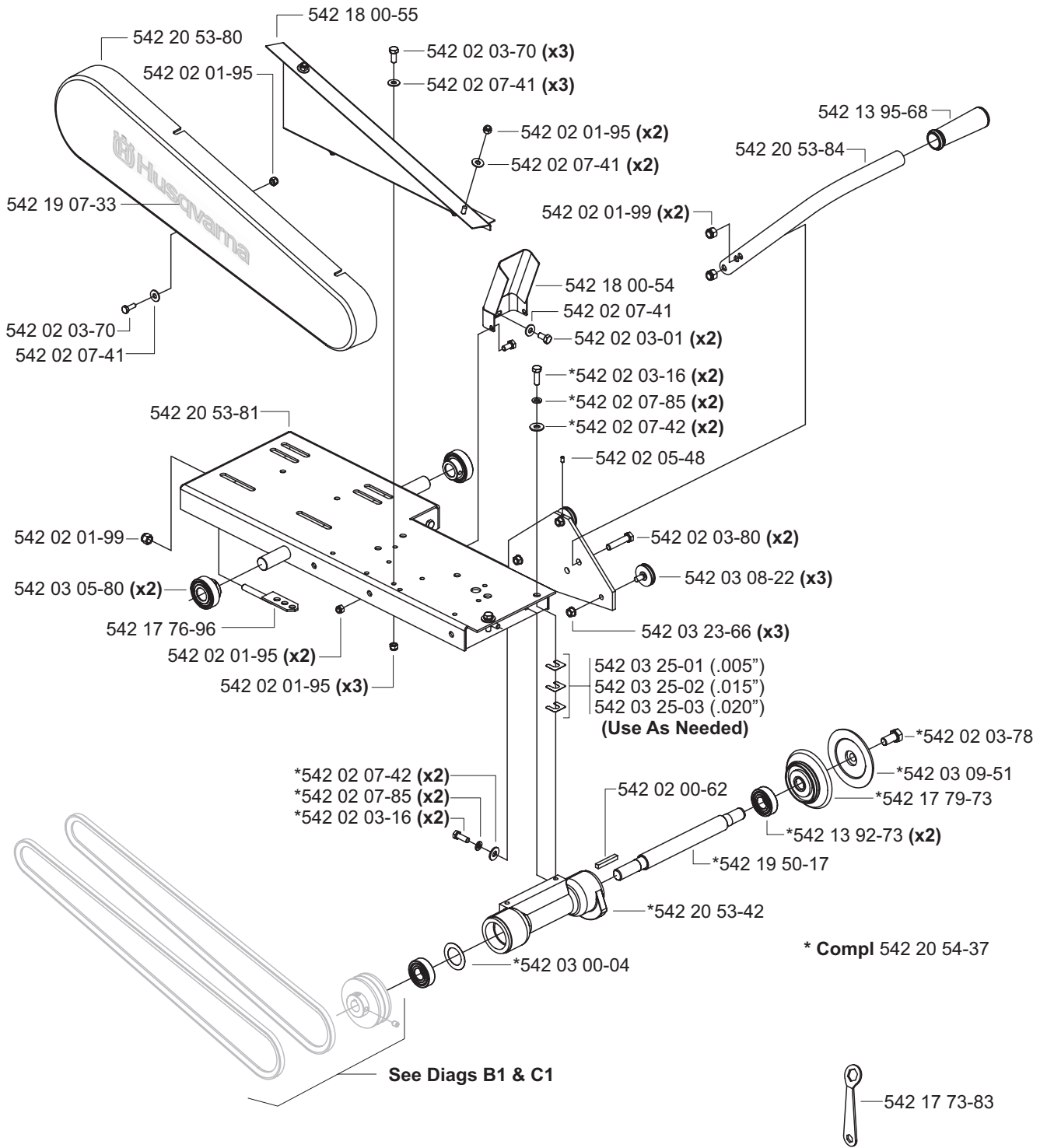

542 19 07-33



# B1 Motor, Pulleys & Belts

**\*\* 3 - 5 HP 1-Phase \*\***  
**\*\* 3 - 5 HP 3-Phase \*\***

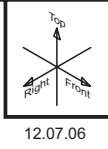

12.07.06

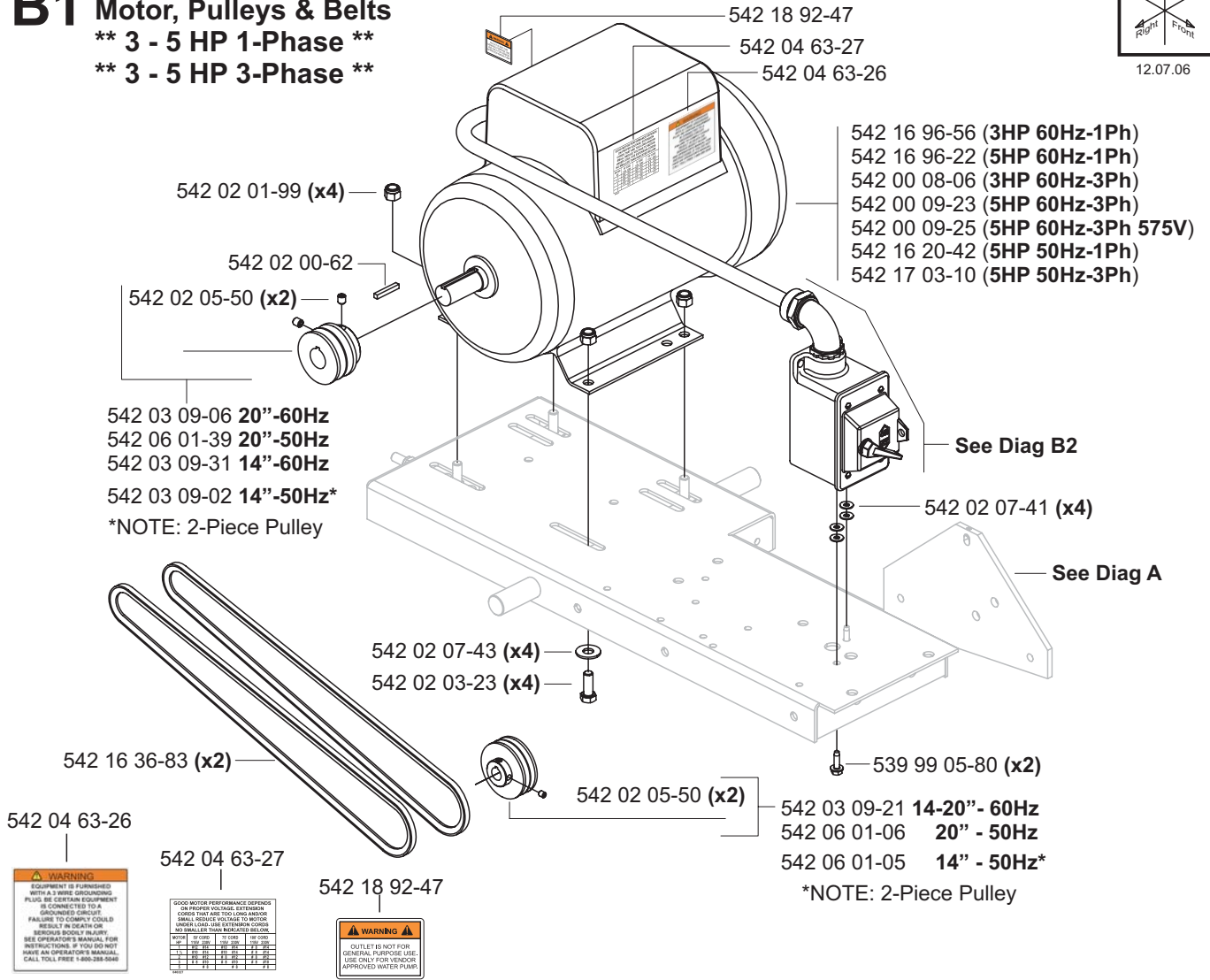

# B2 Motor Switch

\*542 18 08-10 Compl (1-Phase)  
 \*\*542 03 00-71 Compl (3-Phase)

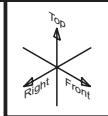

08.18.06

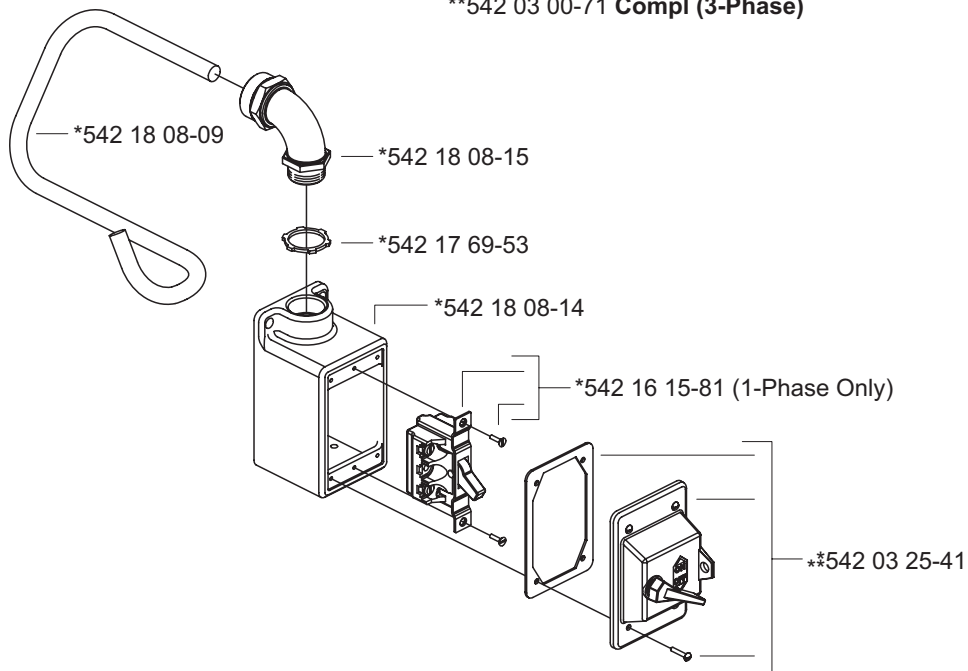

# C1 Motor, Pulleys & Belts

\*\* 7.5 HP 3-Phase \*\*

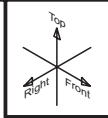

12.07.06

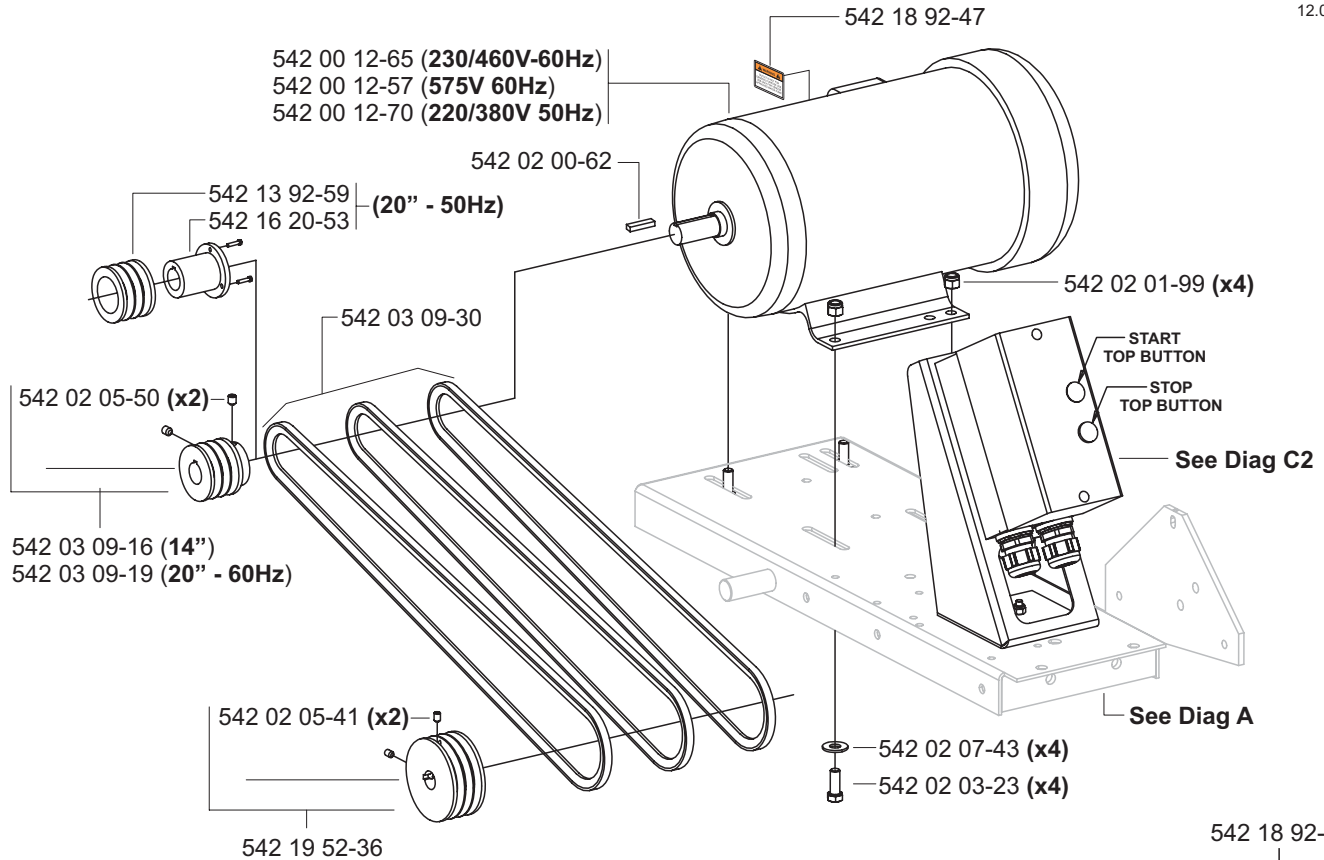

542 18 92-47



# C2 Motor Switch

\*\* 7.5 HP 3-Phase \*\*

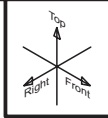

12.07.06

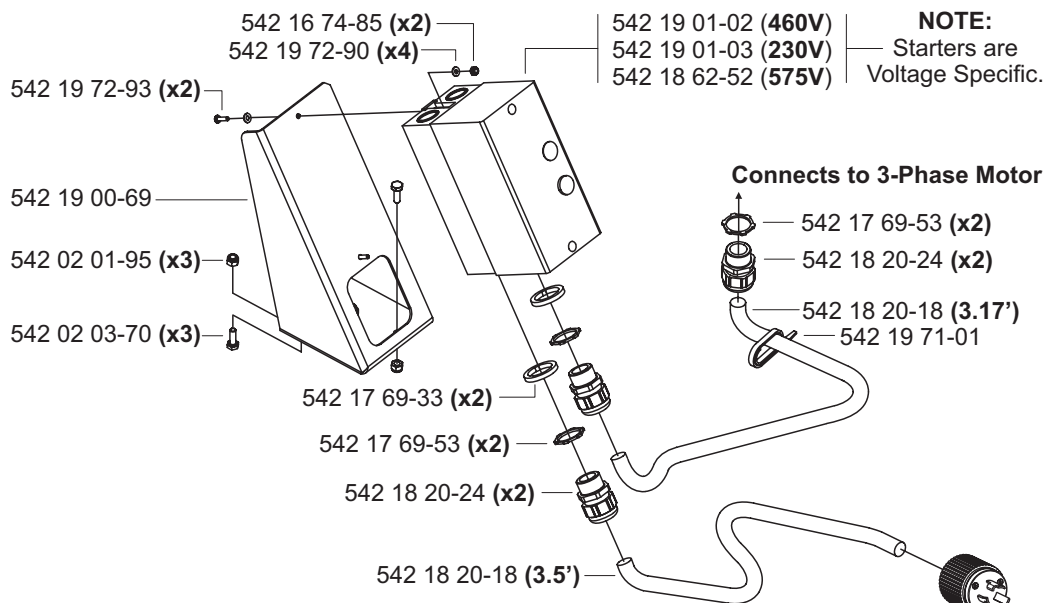

**NOTE:**  
Starters are Voltage Specific.  
542 19 01-02 (460V)  
542 19 01-03 (230V)  
542 18 62-52 (575V)

**Connects to 3-Phase Motor**

- 542 17 69-53 (x2)
- 542 18 20-24 (x2)
- 542 18 20-18 (3.17')
- 542 19 71-01

**NOTE:**  
Plug, Customer Supplied

# D1 Frame

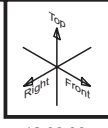

12.06.06

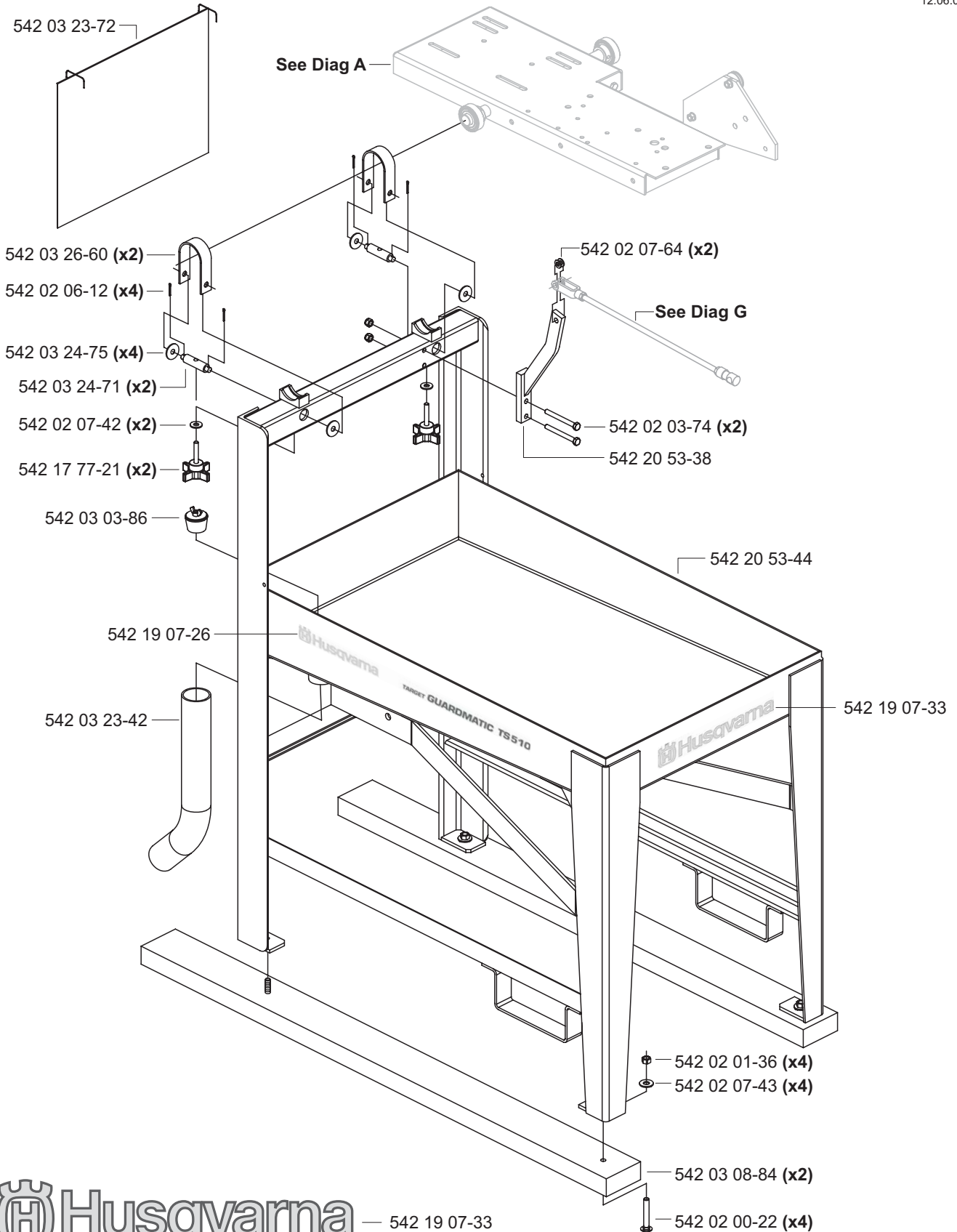

 Husqvarna — 542 19 07-33

 Husqvarna

TARGET **GUARDMATIC TS510** — 542 19 07-26

# D2 Foot Pedal

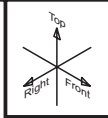

08.18.06

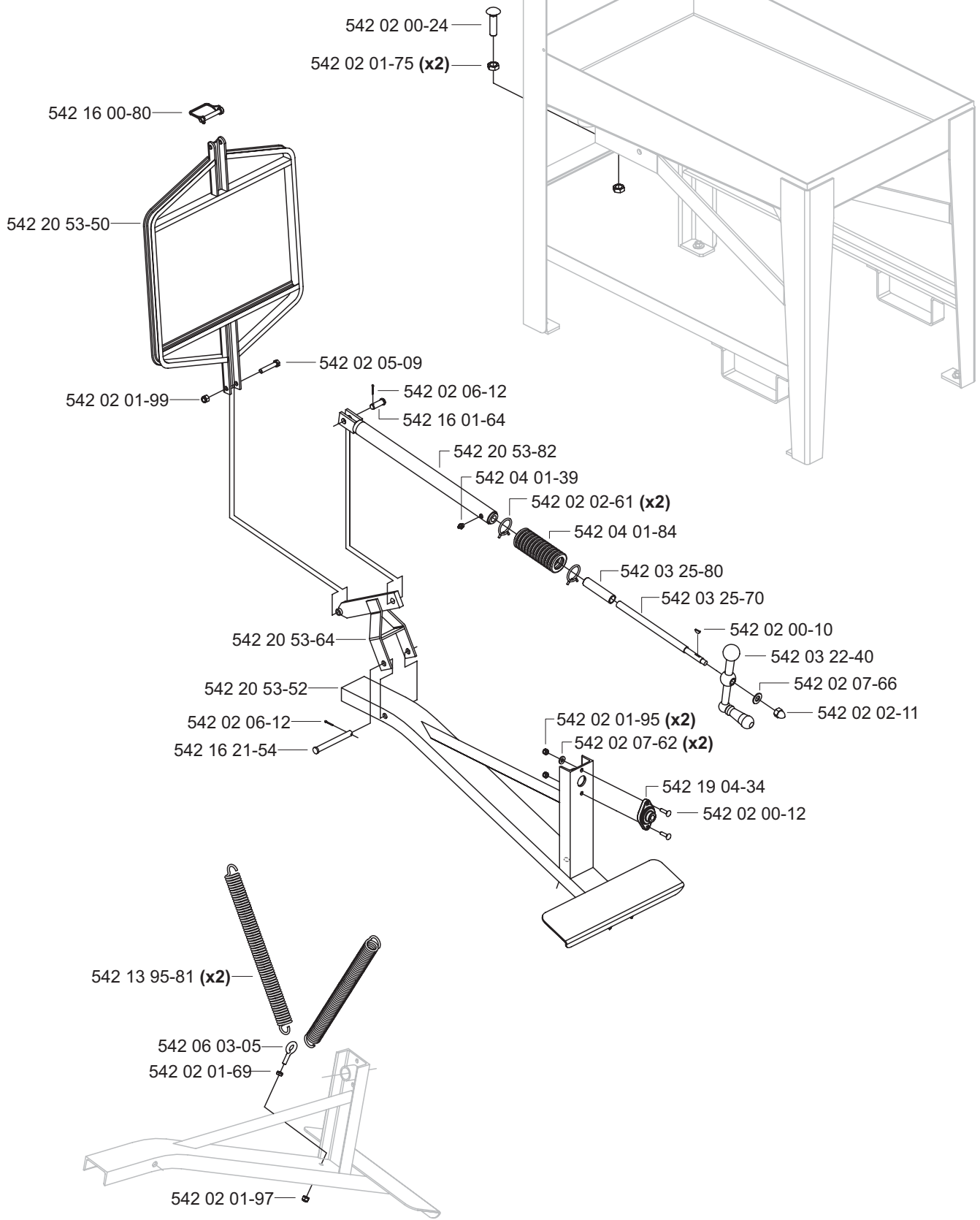



# E Conveyor Cart

\*542 19 04-18 Compl

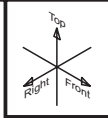

12.07.06

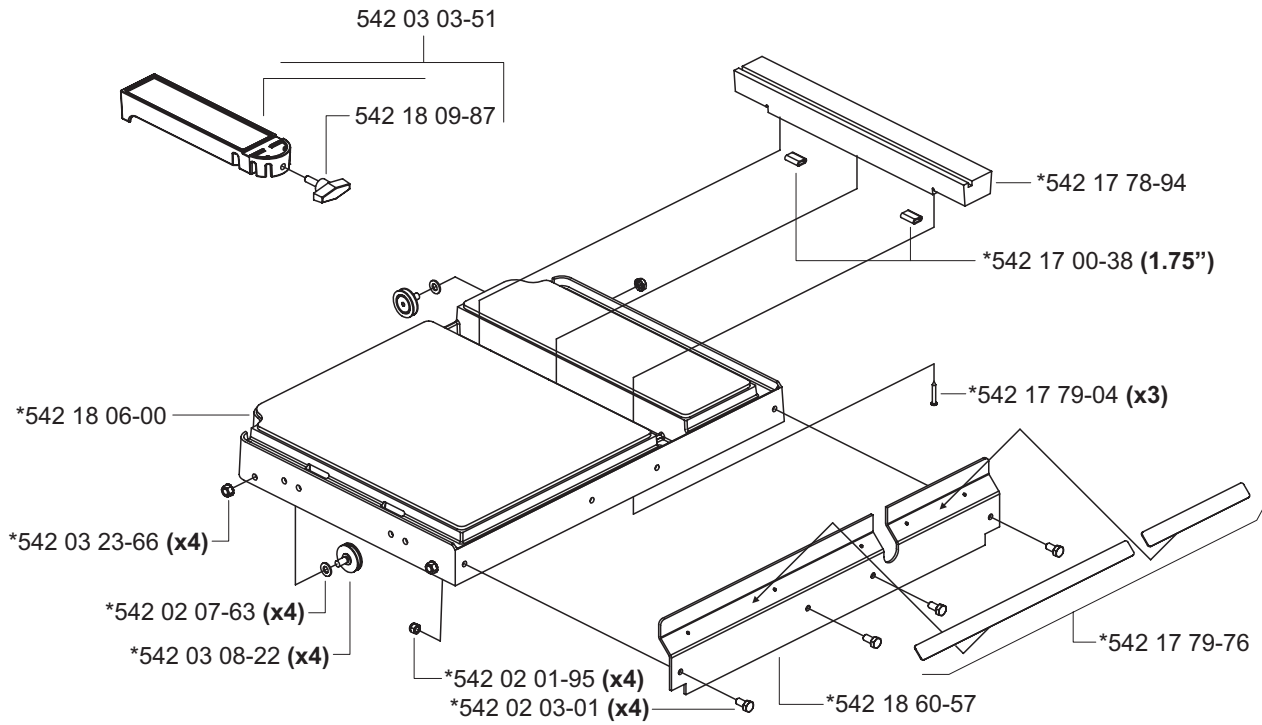

542 03 00-49 - Wheel Kit

# F Water Pump

\*542 03 26-05 Compl (115V/50-60Hz)

\*\*542 03 26-06 Compl (230V/50-60Hz)

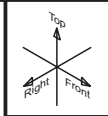

11.28.06

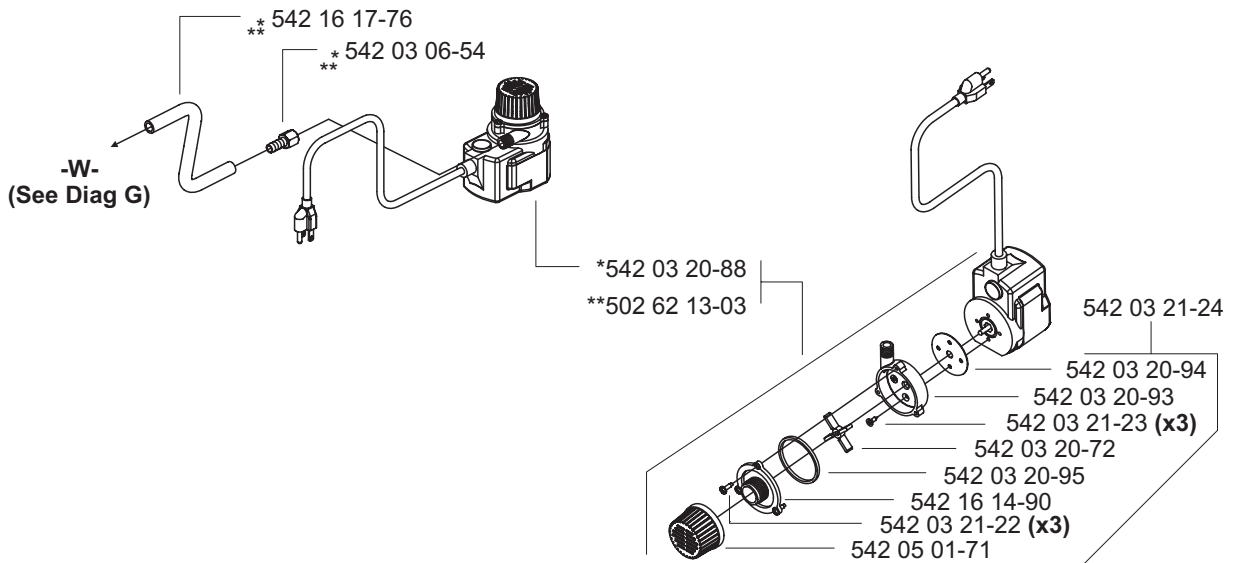

# G Blade Guards

542 20 54-35 Compl - 20"  
 542 20 54-36 Compl - 14"

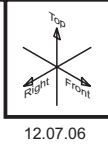

12.07.06

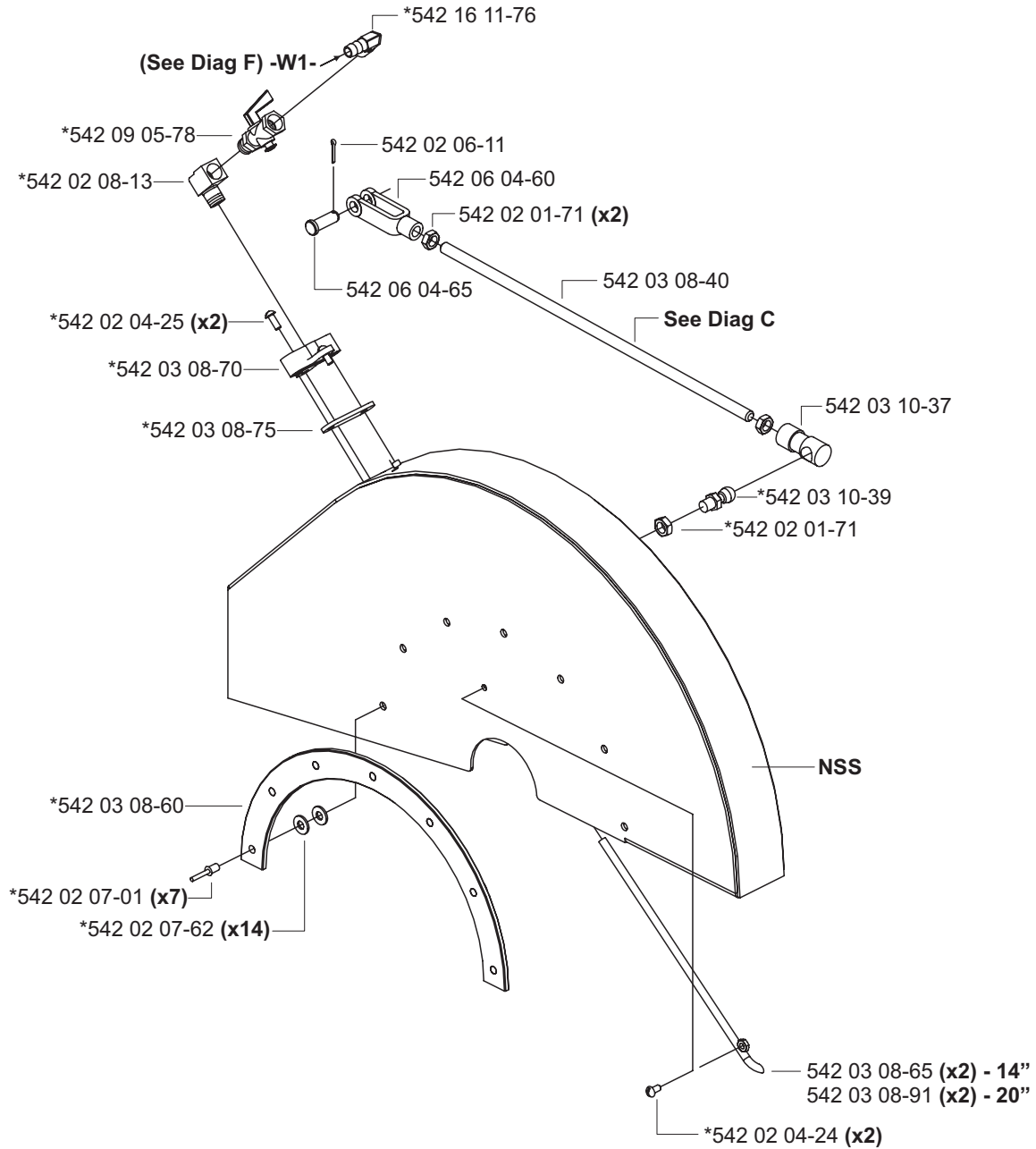

**WARNING**

- Read and understand the entire operators manual before using this machine.
- If you DO NOT have an Operators Manual, Call Toll Free 1-800-288-5040
- Machinery Hazard
  - Always keep all guards in place.
  - Always keep all parts of your body away from all moving parts.
- Always use only in well ventilated areas.
- DO NOT operate near combustible material.

Always wear approved equipment.

542 17 75-88

542 04 61-28

**WARNING**

EQUIPMENT IS FURNISHED WITH A 3 WIRE GROUNDING PLUG. BE CERTAIN EQUIPMENT IS CONNECTED TO A GROUNDING CIRCUIT. FAILURE TO COMPLY COULD RESULT IN DEATH OR SERIOUS BODILY INJURY. SEE OPERATOR'S MANUAL FOR INSTRUCTIONS. IF YOU DO NOT HAVE AN OPERATOR'S MANUAL, CALL TOLL FREE 1-800-288-5040

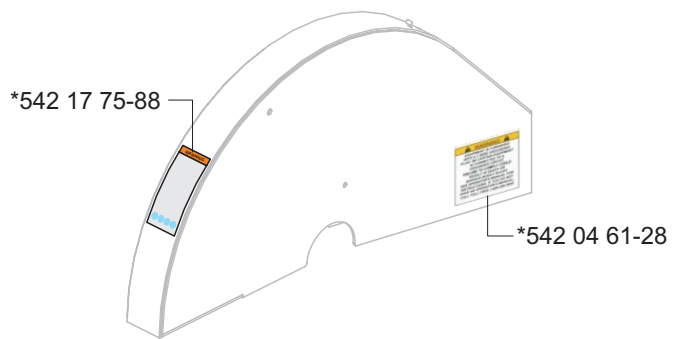

NSS - Not Sold Separately

# H Wheel-Around Kit

542 03 40-00 Compl

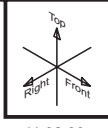

11.02.06

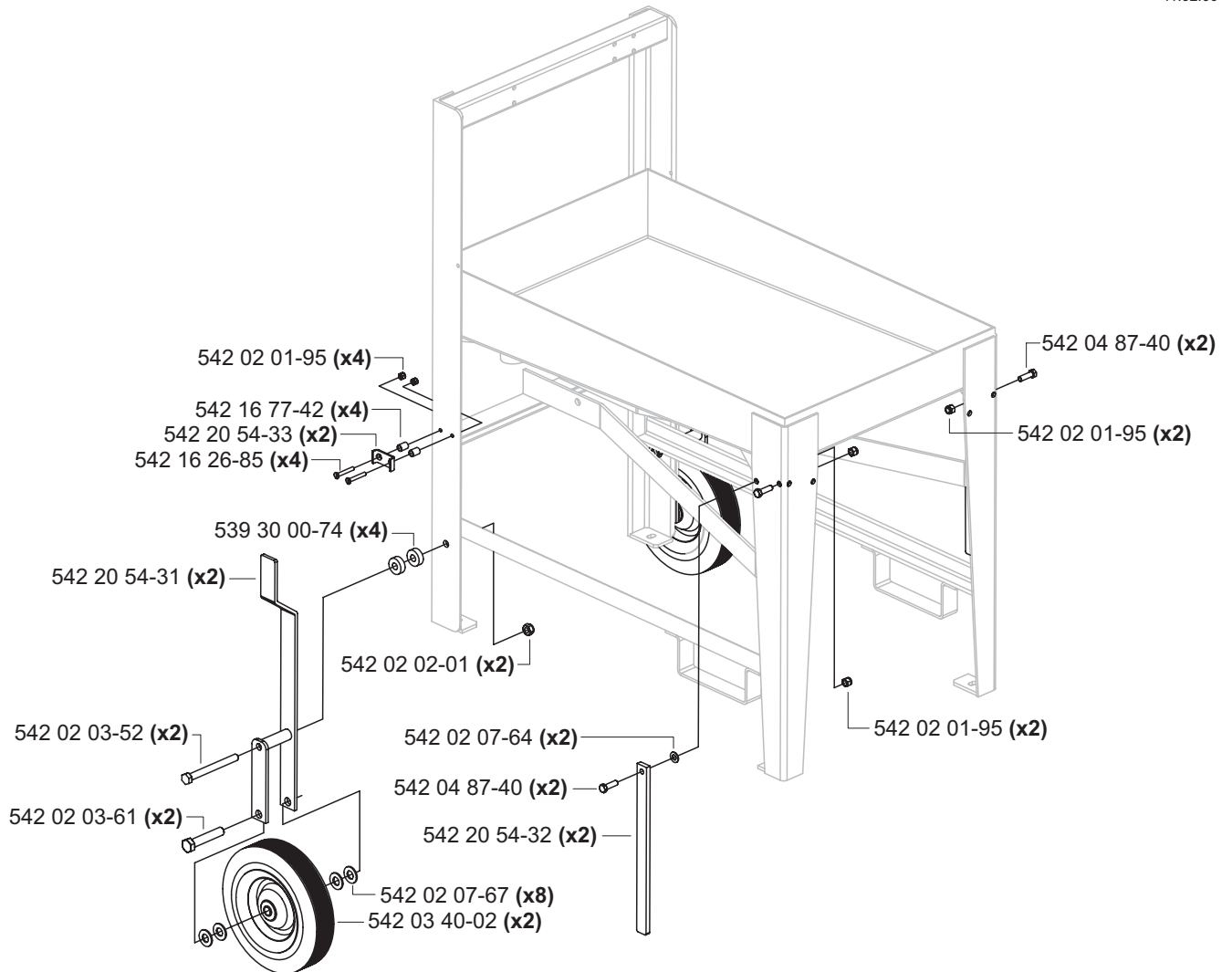

000 A0 30-00

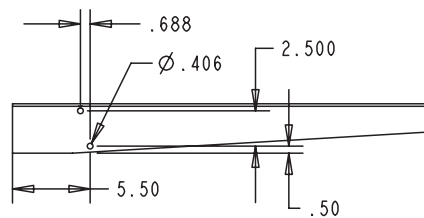
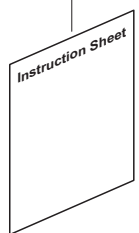

FRONT LEGS MODIFICATION

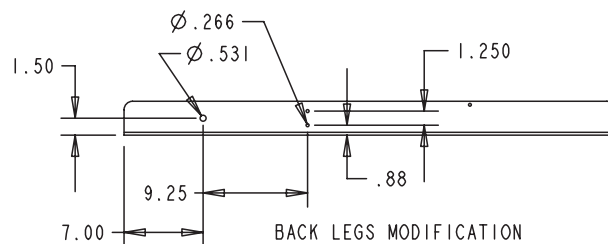

BACK LEGS MODIFICATION

**Husqvarna Construction Products N. A.**  
**Corporate Office**  
17400 West 119th Street  
Olathe, Kansas 66061  
Tel. 913-928-1000  
Fax 913-438-7951

Customer Service: 800-288-5040  
Customer Serv. Fax: 800-825-0028



### **DUST WARNING**



**Cutting, especially when DRY cutting, generates dust that comes from the material being cut, which frequently contains silica.** Silica is a basic component of sand, quartz, brick clay, granite and numerous other minerals and rocks. Exposure to excessive amount of such dust can cause:

- Respiratory diseases (affecting your ability to breath), including chronic bronchitis, silicosis and pulmonary fibrosis from exposure to silica. These diseases may be fatal;
- Skin irritation and rash; and
- Cancer according to NTP\* and IARC\*  
\* National Toxicology Program / International Agency for Research on Cancer

Take precautionary steps

- Avoid inhalation of and skin contact with dust, mist and fumes;
- Wet cut when feasible, to minimize dust;
- Wear and ensure that all bystanders wear appropriate respiratory protection such as dust masks designed to filter out microscopic particles. (See OSHA 29 CFR Part 1910.1200)

**California Prop 65 Warning:**

Use of this product can cause exposure to materials known to the State of California to cause cancer and/or birth defects or other reproductive harm.



Printed in the USA