

## TS 510G

Spare Parts  
Pieces de rechange  
Piezas de repuestro



TS 510G

PART NO.	POS.	DESCRIPTION	PART NO.	POS.	DESCRIPTION
014 02 48-58	B	Switch Plate	542 03 23-66*	B	Nut, Keps .313
539 30 00-74	K	Collar, Set - 1/2" ID	542 03 23-72*	A	Curtain, Splash - TS510
539 30 05-00	G2	Engine, 13HP Honda	542 03 25-01*	C	Shim, Brass .005 Thick
539 30 14-34	G2	Engine, 9HP Honda W/Cyclone	542 03 25-02*	C	Shim, Brass .015 Thick
542 02 00-10*	B	Key, Woodruff #405	542 03 25-03*	C	Shim, Brass .020 Thick
542 02 00-22*	A	CB, .375-16 x 2.50	542 03 25-70*	B	Screw, Adjustment
542 02 00-24*	A	CB, .625-11 x 2.50	542 03 25-80*	B	Stop Sleeve
542 02 00-41*	C	Key, .25 Sq X 1.5 Lg	542 03 40-02*	K	Wheel, 10" x 2.375 x .625 Bore
542 02 00-49*	F	Hose Clamp, Worm Drive SAE004	542 04 01-39*	B	Fitting, Grease 1/8 NPT
542 02 00-68*	G2	Key, Sq .25 X 2.75	542 04 01-84*	B	Boot, Rubber, 4" Lg
542 02 00-71*	G2	Key, .25 Sq X 2.25	542 04 53-98*	C	V-Belt: 3VX475
542 02 01-36*	A	Nut, Std Hex .375-16	542 04 61-28*	J	Decal: Warning (Blade Guard Size)
542 02 01-71*	C	Nut, Hex Jam Thin .375-24	542 04 87-40*	B	HHCS, .375-16 X 1.25 Gr 5
542 02 01-75*	B	Nut, Hex Jam Thin .625-11	542 04 87-40*	K	HHCS, .375-16 x 1.25 Gr5
542 02 01-77*	C	Nut, Hex Jam Thin .5-13	542 05 21-20*	B	Switch, Toggle
542 02 01-94*	J	Locknut, Fiber 10-24	542 06 04-60*	J	Yoke End
542 02 01-95*	B	Locknut, Fiber .25-20	542 06 04-65*	J	Pin, Clevis .375 Dia
542 02 01-96*	A	Locknut, Fiber Thin .375-16	542 09 05-78*	J	Water Valve, 1/4NPT M x 1/4NPT F
542 02 01-97*	A	Locknut, Fiber .3125-18	542 0A 78-73*	NS	Inst Sht: Bld Sht & Hsg - TS 510
542 02 01-99*	B	Locknut, Fiber .375-16	542 13 92-73	C	Brg w/seal, 20ID x 47OD x 14mm
542 02 02-01*	B,K	Locknut, Fiber .5-13	542 13 95-68	B	Grip, Handle
542 02 02-11*	B	Nut, Acorn .5-13	542 13 95-81*	B	Spring, Foot Pedal
542 02 02-61*	B	Clamp, Hose A22	542 13 96-82*	C	Pulley 3G3V2.65 - 1.0 w/SS
542 02 03-01*	E	HHCS, .25-20 X .625 Gr 5	542 16 77-42*	K	Spacer, 3/8 ID x 11/16ly, Plastic
542 02 03-06*	AA31	HHCS, .25-20 X 1 Gr 5	542 16 00-80*	B	Pin, Clevis .50 Dia x 1.13 Lg
542 02 03-13*	C	HHCS, .3125-18 X .75 Gr 5	542 16 01-64*	B	Pin, Yoke
542 02 03-16*	C	HHCS, .3125-24 X 1 Gr 5	542 16 07-45*	B	Connector, Snap Plug
542 02 03-19*	A	HHCS, .3125-18 X 3.75 Gr 5	542 16 11-58*	F	Bulb, Primer
542 02 03-23*	G1	HHCS, .375-16 X 1 Gr 5	542 16 11-59*	F	Strainer, Suction
542 02 03-29*	G2	HHCS, .375-16 X 2.75 Gr 5	542 16 11-76*	J	Fitting, 1/4 NPT X 3/8 Barb
542 02 03-31*	A	HHCS, .375-16 X 3.25 Gr 5	542 16 11-81*	F	Barb, Elbow
542 02 03-52*	K	HHCS, .5-13 x 5	542 16 11-96	G2	Isolator, Engine 30-35 Duro (1 Dot)
542 02 03-53*	B	HHCS, .5-13 X 5.5 Gr 5	542 16 11-97*	G2	Isolator, Engine 40-45 Duro (2 Dots)
542 02 03-61*	K	HHCS, .625-11 x 3.75	542 16 26-85*	K	FLHCS, 1/4-20 x 1.5
542 02 03-67*	A	HHCS, .3125-18 X 3.5 Gr 5	542 16 31-87*	G2	Washer, SP .0625 X.375x1.5
542 02 03-74*	A	HHCS, .3125-18 X 3 Gr 5	542 16 70-35*	B	Pin, Cotter Hair Spring.5-.625
542 02 03-76*	G1	HHCS, .3125-18 X 4.5 Gr 5	542 16 71-33	G2	Adapter, M12 X 10mm Hose Bard
542 02 03-78*	C	HHCS, .5-20 X 1 Gr 5	542 16 73-05*	G2	Hose Assy-Oil Drain (M16 x 6.5"Lg)
542 02 03-80*	B	HHCS, .375-16 X 1.75 Gr 5	542 16 73-06	G2	Cap, Blanking (Oil Drain)
542 02 04-24*	J	RHMS, #10-32 X .375 Brass	542 16 76-22	G2	Nut, Tube-M16 (Oil Drain)
542 02 04-25*	J	RHMS, #10-32 X .5 Brass	542 16 81-33*	C	HHCS, .375-24 X 1 Gr 5
542 02 05-09*	B	HHCS, .375-16 X 2.00 Gr 5	542 16 90-65	G1	Decal: Muffler
542 02 05-41*	C	SHSS, .25-20 X .375 CUP HK	542 16 93-65*	J	Guard, Splash
542 02 05-48*	B	SHSS, 10-24 X .375 CUP HK	542 17 00-38*	E	Vinyl Tubing, 3/8 ID
542 02 05-50*	G2	SHSS, Cup .313-18 x .375	542 17 01-50*	C	CB, .375-16 X 1"
542 02 06-11*	J	Pin, Cotter .094 x .625	542 17 21-41*	F	T-Knob, 1/4-20 X 1
542 02 07-01*	J	Pop Rivet, USM #D88BS	542 17 47-40*	G2	Hose Clamp, Worm Drive SAE006
542 02 07-39*	J	Washer, Flat #10	542 17 49-99*	B	Assy, Cord
542 02 07-41*	F	Washer, Flat .25	542 17 73-17*	F	Water Pump, Mechanical
542 02 07-42*	A	Washer, Flat .313 Dia	542 17 73-54*	F	Pulley 1G3V2.65-.625 w/SS
542 02 07-43*	G2	Washer, Flat .375 Dia	542 17 73-83*	A	Wrench: .75 X .50 Box End
542 02 07-44*	G2	Washer, Flat .4375	542 17 75-88*	J	Decal, Warning, Large
542 02 07-45*	B	Washer, Flat .5	542 17 78-94*	E	Insert, Wood, 15-7/8" Lg
542 02 07-62*	B	Washer, Flat .250 SAE	542 17 79-04*	E	RHWS, #8 X 1.25" Std
542 02 07-63*	E	Washer, Flat .312 SAE	542 17 79-73*	C	Collar, Inner, Black Oxide
542 02 07-64*	J,K	Washer, Flat SAE .375	542 17 79-76*	E	Decal, Ruler Set, TS 510
542 02 07-66*	B	Washer, Flat .500 SAE	542 18 09-87*	E	Knob, Tee 5/16-18 x 1.00
542 02 07-67*	K	Washer, Flat .625 SAE	542 18 11-43*	G2	HHCS: .375-24 X 1.50
542 02 07-85*	C	Lockwasher, Split .3125	542 18 13-61*	G1	Grommet
542 02 07-86*	G2	Lockwasher, Split .375	542 18 33-75*	G2	Hole, Plug: 3/4"
542 02 07-87*	G2	Lockwasher, Split .4375	542 18 38-84*	B	Spherical Washer Set
542 02 14-16*	B	HHCS, .3125-18 X 1 Gr 5	542 18 60-00*	E	Cart, Conveyor w/ Rubber Top
542 03 00-04	C	Washer, Spring Finger Load	542 18 60-28*	C	Snap Ring, External (2.25 Dia)
542 03 03-51*	E	Guide, Measuring Assy	542 18 60-57*	E	Backstop, Conveyor Cart, TS510
542 03 03-86*	A	Drain Plug Assembly	542 18 60-73*	J	HHMS, #10-24 X .50"
542 03 08-22*	B	Wheel, Cart	542 18 60-97*	F	Hose Barb Elbow, 3/8"H X 3/8N
542 03 08-40*	J	Link	542 18 61-29*	C	Bearing, 1" ID x 52mm OD
542 03 08-60*	J	Track Bright Zinc Plt G/M	542 18 61-67*	G2	HHCS, .438-20 x 1.50"
542 03 08-70*	J	Manifold, Water	542 18 62-24*	C	SHSS, .312-18 x .75"
542 03 08-75*	J	Gasket, Water Manifold	542 18 62-54*	A	Bearing, Lower Pivot
542 03 08-84*	A	Skid, 2 x 4 x 47.5 Lg	542 18 62-56*	A	Bearing, Upper Pivot
542 03 08-91*	J	Tube, Water Assy - 20"	542 18 62-60*	B	HHCS, .500-13 X 12" FT
542 03 09-51*	C	Flange, Outer	542 19 04-10	F	Tubing, Vinyl, .375 ID X 36"
542 03 10-37*	J	Quick Disconnect Body	542 19 04-11	F	Tubing, Vinyl, .375 ID X 12"
542 03 10-39*	J	Stud, QD Ball	542 19 04-12	F	Tubing, Vinyl, .375 ID X 48"
542 03 22-40*	B	Crank Handle Assembly	542 19 04-15	G1	Decal, Lifting+Pump+Depth Stop
542 03 23-42*	A	Drain Hose, 1-7/8 ID x 14"	542 19 04-16	G2	V-Belt, 3 Band, 3G3VX425

NOTE: Part No's. that have an ASTERISK (\*) suffix may not be active 9-digit numbers. The '542' prefix has been added to current 6-digit part numbers and '0' to 7 and 8-digit numbers.

TS 510G

PART NO.	POS.	DESCRIPTION	PART NO.	POS.	DESCRIPTION
542 19 04-18	E	Cart, Conveyor Assy - TS 510G			
542 19 04-34	B	Bearing, 2-Bolt Flange .500 ID			
542 19 07-25	C	Decal: Husqvarna Target GM TS510G			
542 19 07-33	C	Decal: Husqvarna, 9.5"			
542 19 07-34	A,C	Decal: Husqvarna, 5"			
542 19 50-18*	A	Blade Shaft, TS 510G			
542 19 50-39	C	HHCS, .500-13 x 5.00 FT			
542 19 52-32	C	Guard, Inner, Blade Belts, Galv			
542 19 52-36	A	Pulley, 3G3V3.35 - .75 w/SS			
542 19 52-37	A	Counter Drive Shaft, 1.00 OD			
542 19 52-55	G2	Clutch, 3G3V3.48OD - 1.0"			
542 19 52-81	G2	Pulley, 3G3V3.48OD - 1.0" w/SS			
542 19 53-24	D	Decal, Stop Switch, TS 510G			
542 19 54-04	G1	Shield Wldmt, Water Pump, Galv			
542 19 54-07	A	Pulley, 3G3V4.50OD - 1.0" w/SS			
542 19 71-01*	B	Cable Tie, Plastic 8" X .094			
542 20 53-42	A	Arbor, Housing, PC H. Grey			
542 20 53-43	A	Depth Stop, PC Grey			
542 20 53-44	C	Frame Wldmt, TS510G, PC H Orange			
542 20 53-45	C	Spacer, Head Platfrm, PC H Grey			
542 20 53-46	A	Belt Guard, TS510G, PC H Orange			
542 20 53-47	G2	Bracket Wldmt, Tension, PC H Grey			
542 20 53-48	G1	Front Pulley Guard, PC H Grey			
542 20 53-49	G1	Support Tilt Arm, PC H Grey			
542 20 53-50	B	Tilt Frame Wldmt, TS510G, PC H. Grey			
542 20 53-51	B	Brkt, Spring, Foot Pedal, PC H Grey			
542 20 53-52	B	Foot Pedal Wldmt, PC H. Grey			
542 20 53-53	A	Head Platform Wldmt, PC H. Grey			
542 20 53-54	A	Hd Pivot Pltfrm Wldmt, PC H. Grey			
542 20 53-55	G2	Mount, Isolatr, 9H & 13H, PC H Grey			
542 20 53-56	G2	Base, Engine, 9H & 13H, PC H Grey			
542 20 53-57	G1	Platform Brkt, Eng, PC H Orange			
542 20 53-58	G1	Guard, Eng Belt, PC H Orange			
542 20 53-59	F	Brkt, W/P, TS510G, PC H Grey			
542 20 53-64	B	Tilt Adjust Yoke, PC H. Grey			
542 20 53-67	G1	Eye Nut, Saw Tiedown - PC H Grey			
542 20 53-77	A	Nut Plate Weldment, PC H. Grey			
542 20 53-78	A	Front Anchor, PC H. Grey			
542 20 53-82	B	Adj. Nut Weld Assy. PC H. Grey			
542 20 53-84	B	Handle, Tubing, PC H. Grey			
542 20 54-31	K	Lever Weldment, PC H. Orange			
542 20 54-32	K	Handle Lever, H. Orange			
542 20 54-33	K	Stop Plat, PC H. Orange			
542 20 54-42	J	Blade Guard Assy- Compl 20"			
<b>MISC ITEMS &amp; SPECIAL KITS</b>			<b>LEGEND</b>		
542 20 11-06	N/S	OM Op Instr: TS 510G – 9H & 13H	BHMS		Button Head Machine Screw
542 20 11-07	N/S	IPL Parts List: TS 510G – 9H & 13H	FLHMS		FLat Head Machine Screw
			HHCS		Hex Head Cap Screw
			HWHSTS		Hex Washer Head Self-Tapping Screw
542 17 74-24	F	Kit, Water Pump Repair	RHMS		Round Head Machine Screw
542 20 54-41	B	Kit, Bladeshaft Assy, TS 510G	SBHMS		Socket Button Head Machine Screw
542 03 40-00	K	Kit, Wheel Around - TS 310	SHCS		Socket Head Cap Screw
000 A0 30-00	K	Instr Sheet: Wheel-Around Kit	SHSS		Socket Head Set Screw
			STS		Self-Tapping Screw
			PHCS		Pan Head Cap Screw
			PHMS		Pan Head Machine Screw
			PHSTS		Pan Head Self-Tapping Screw
			FT		Full Thread
			Gr		Grade

NOTE: Part No's. that have an ASTERISK (\*) suffix may not be active 9-digit numbers. The '542' prefix has been added to current 6-digit part numbers and '0' to 7 and 8-digit numbers.



# A Frame Assembly

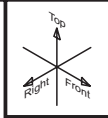

09.06.06

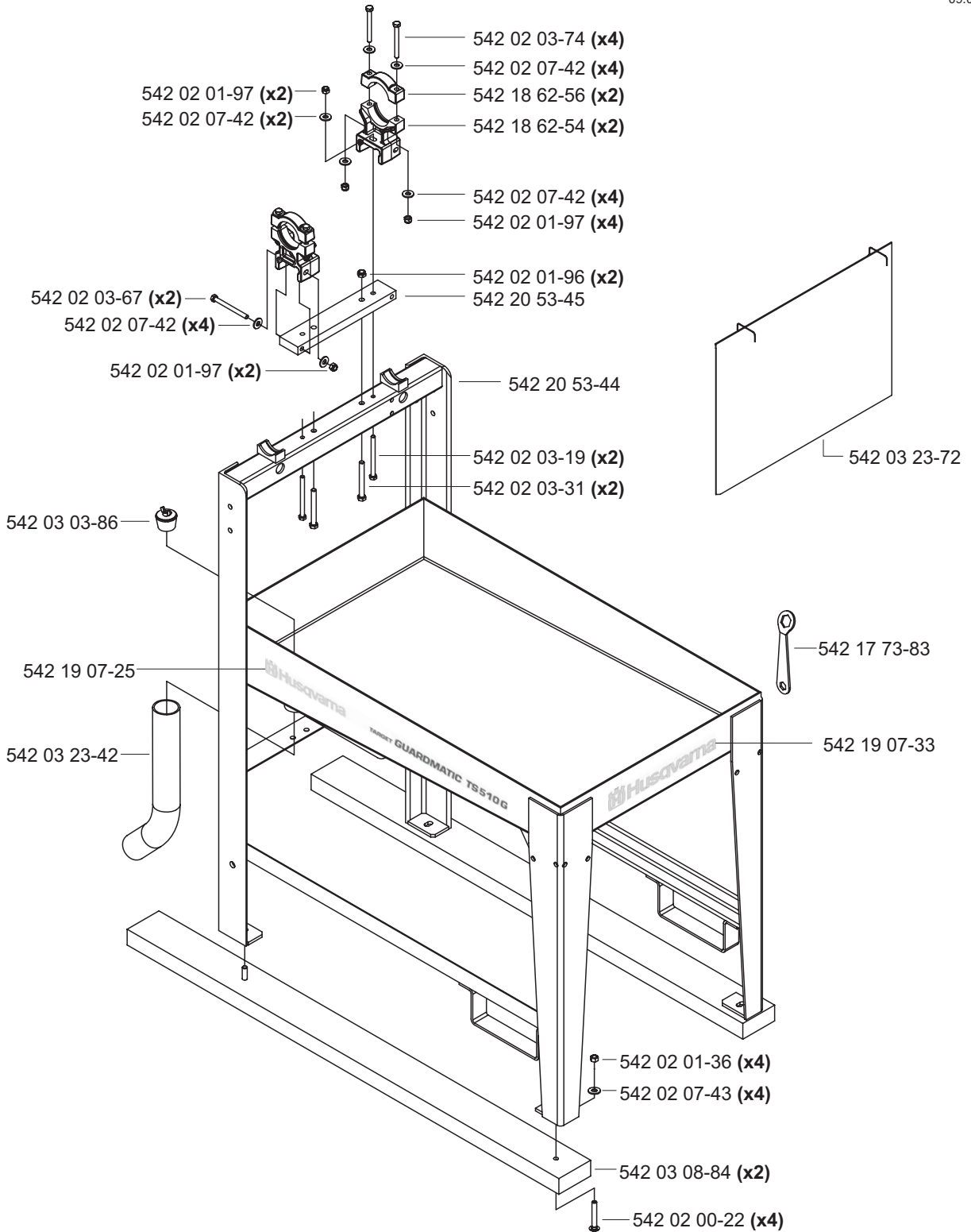

 Husqvarna — 542 19 07-33

 Husqvarna

**TARGET GUARDMATIC TS510G** — 542 19 07-25

# B Foot Pedal Assembly

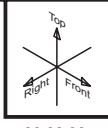

09.06.06

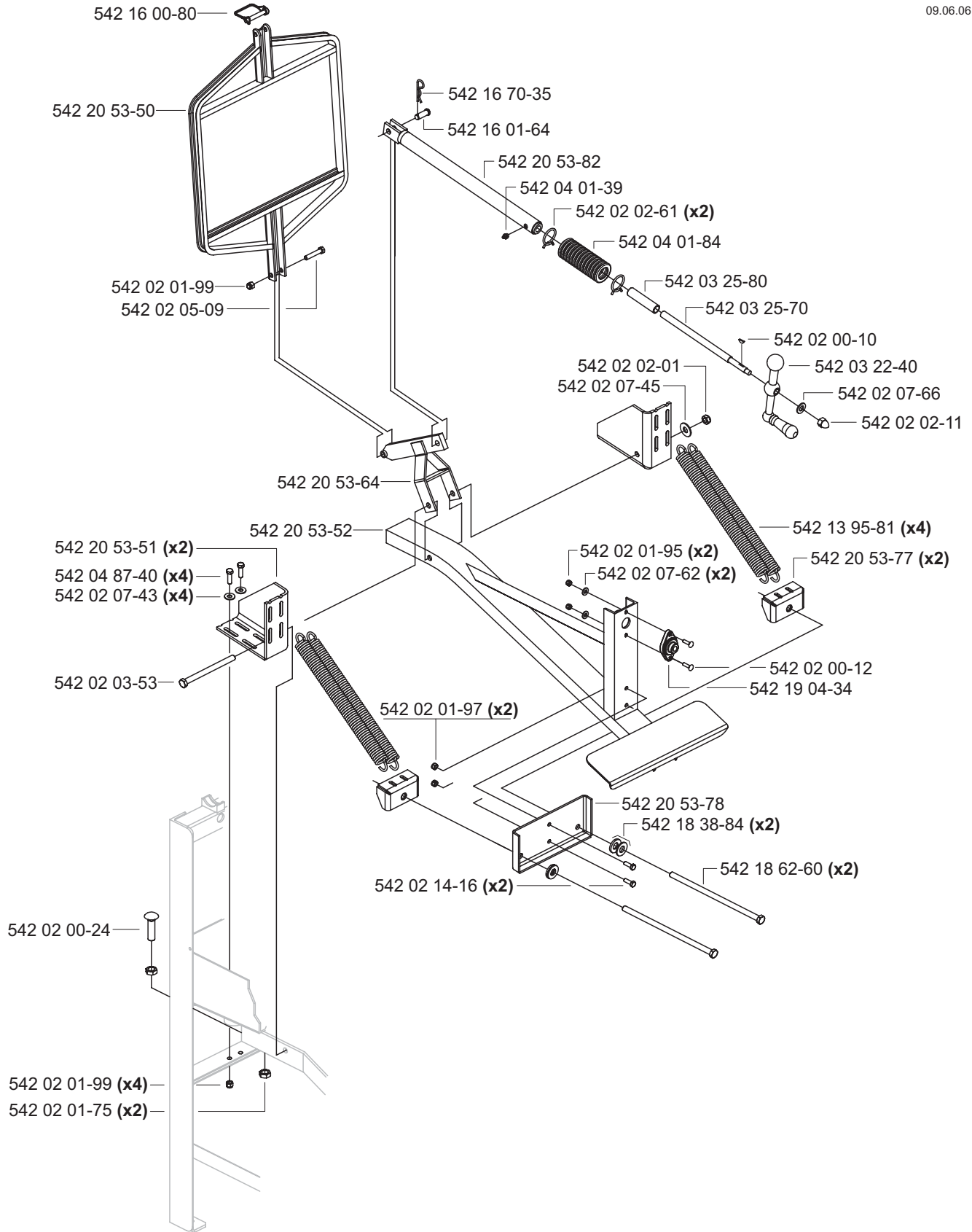

# C Head Platform Assembly

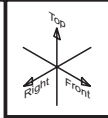

09.08.06

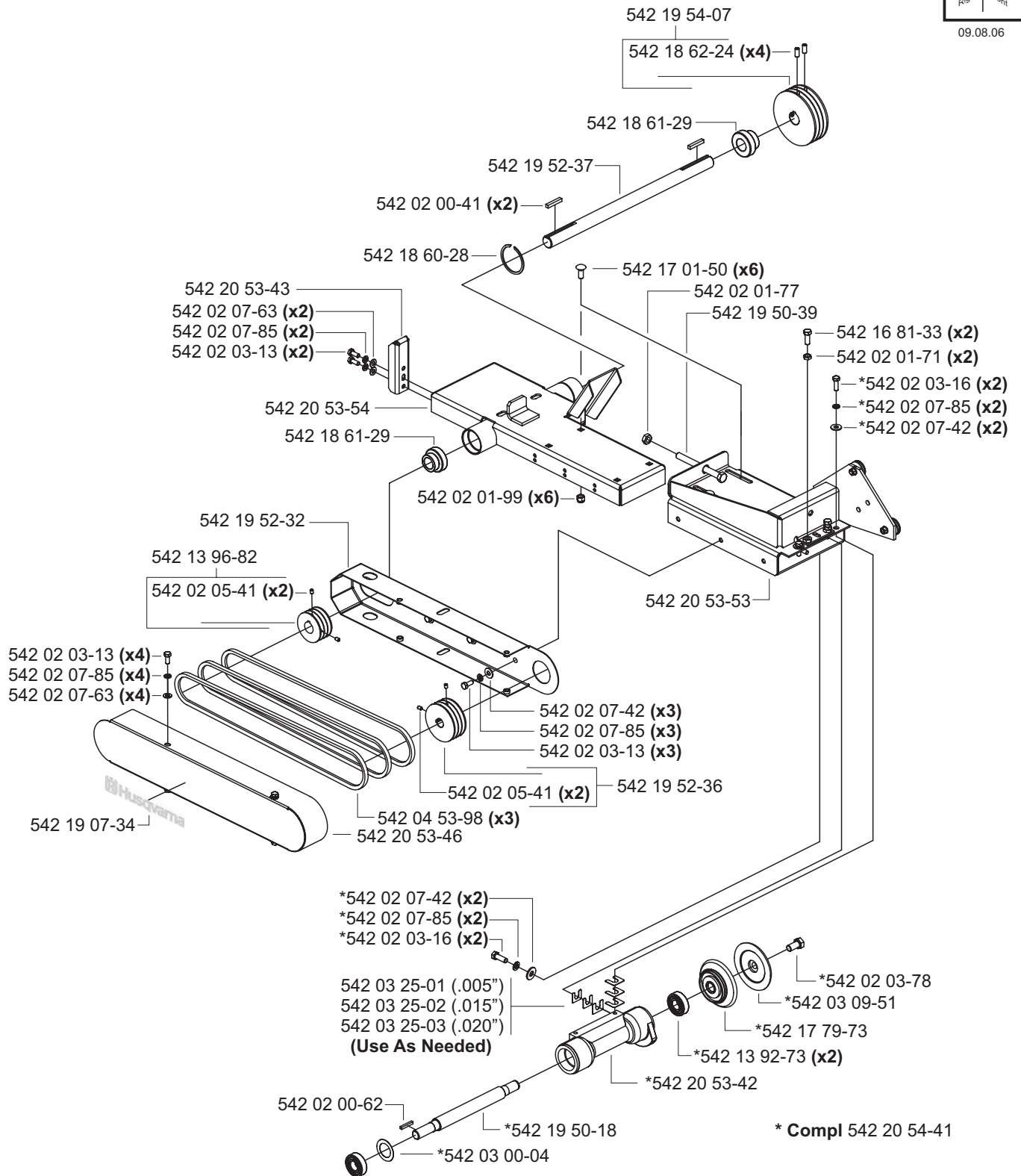

542 19 07-34





# D Handle & Switch Assy

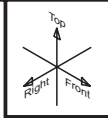

10.31.06

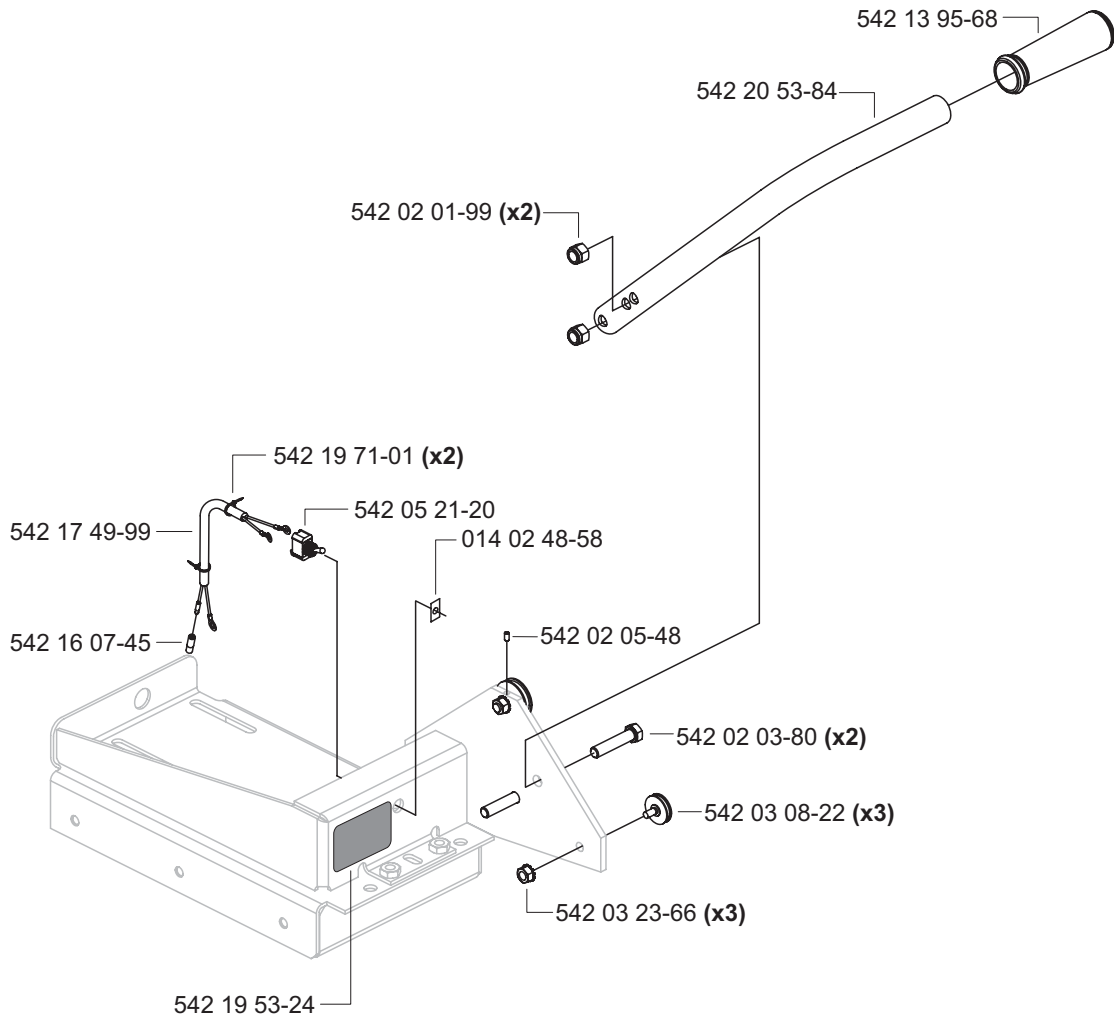



542 19 53-24

Switch Must Be In "Start" (ON) Position Before Starting Engine.

START  
ARRANQUE 

STOP ENGINE  
PARADA MOTOR





# E Conveyor Cart Assembly

\*542 19 04-18 Compl

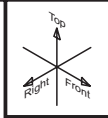

09.06.06

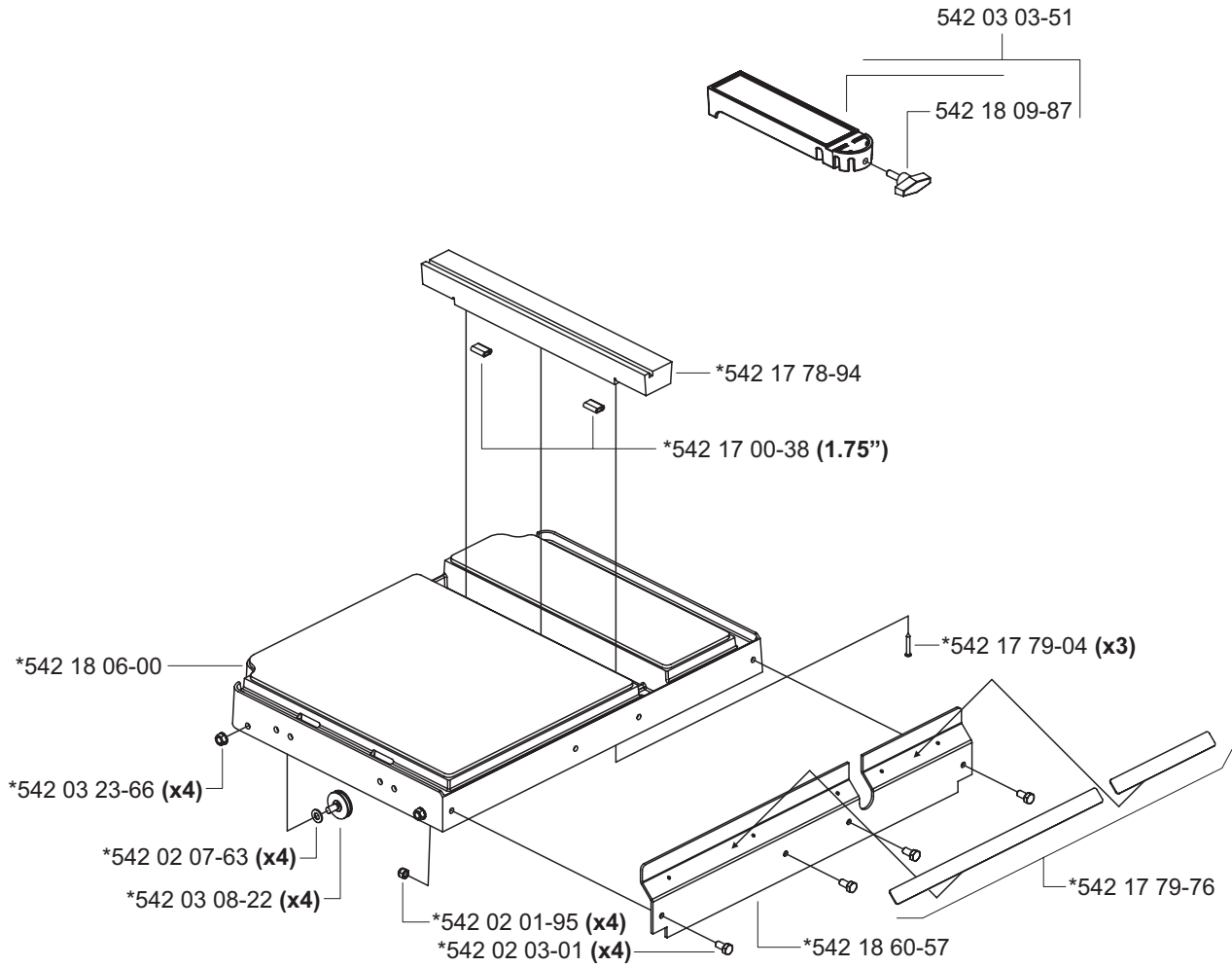

# F Water Pump Assembly

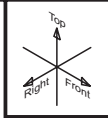

10.31.06

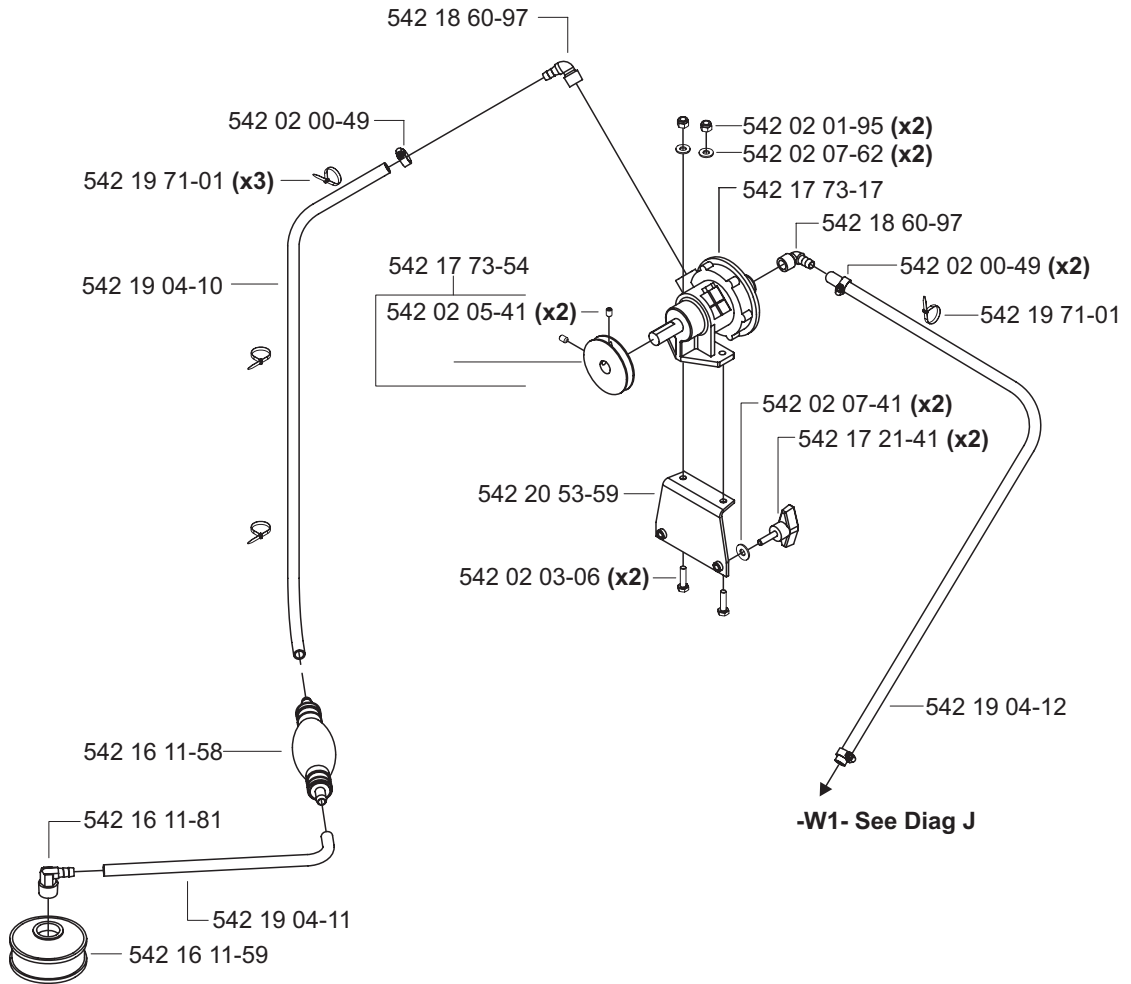

## 542 17 73-17 Pump Compl

### \*542 17 74-24 Kit, Repair

(Includes 2 shims not shown)

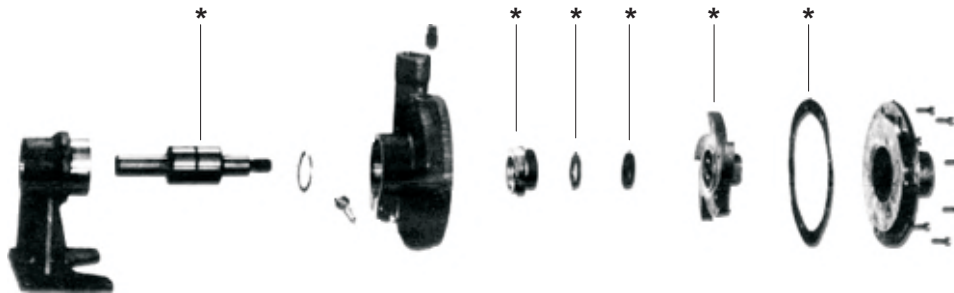

# G1 Engine Mounting Assembly

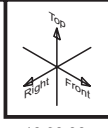

10.30.06

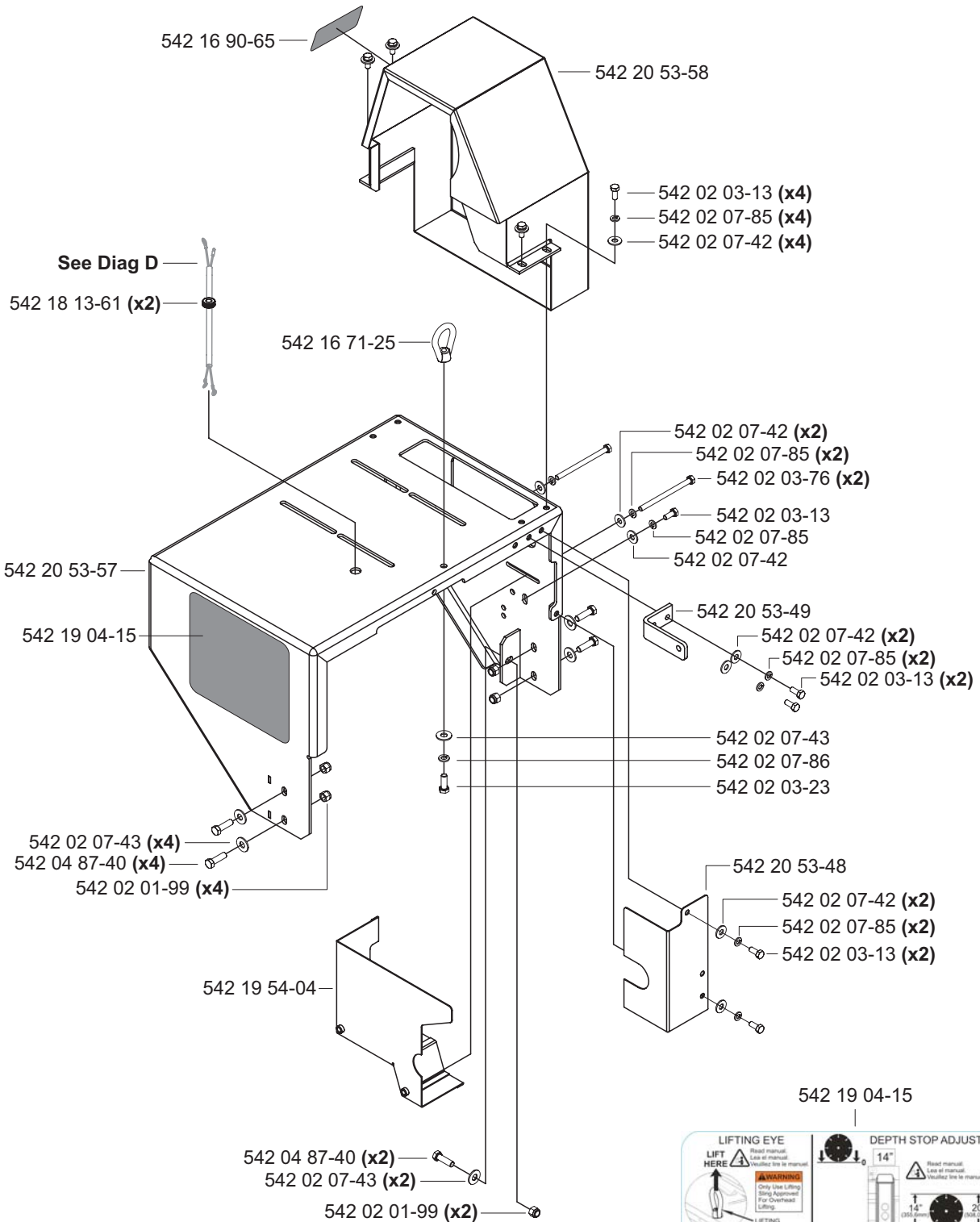

**WARNING**

Muffler Is HOT!  
May Cause Burns And / Or  
Ignition Of Material.  
Avoid Contact!

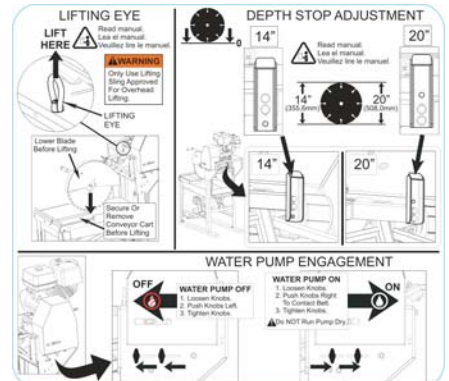

# G2 Engine Mounting Assembly

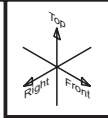

10.30.06

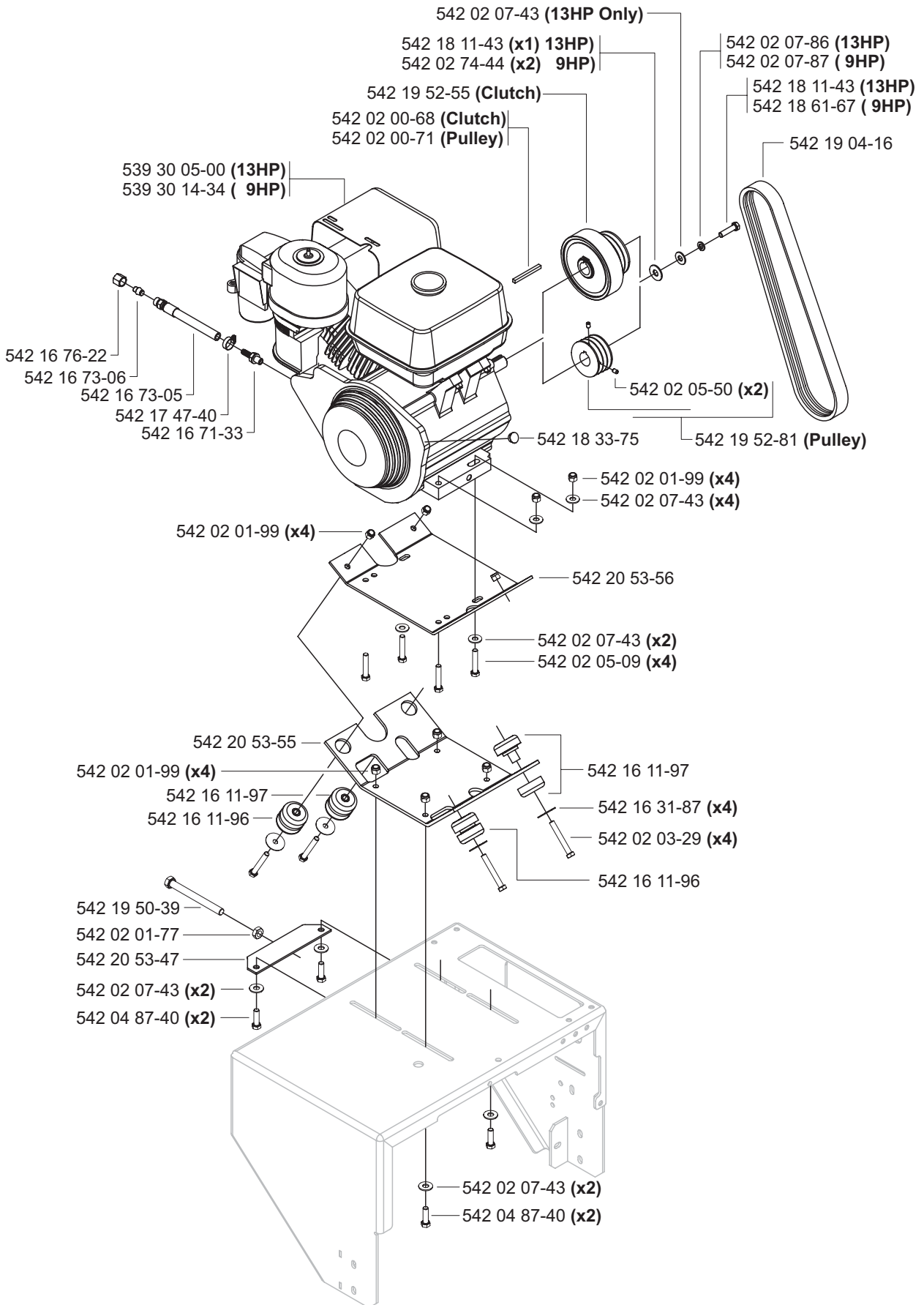

# J Blade Guard Assembly

\*542 20 54-42 Compl - 20"

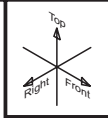

10.30.06

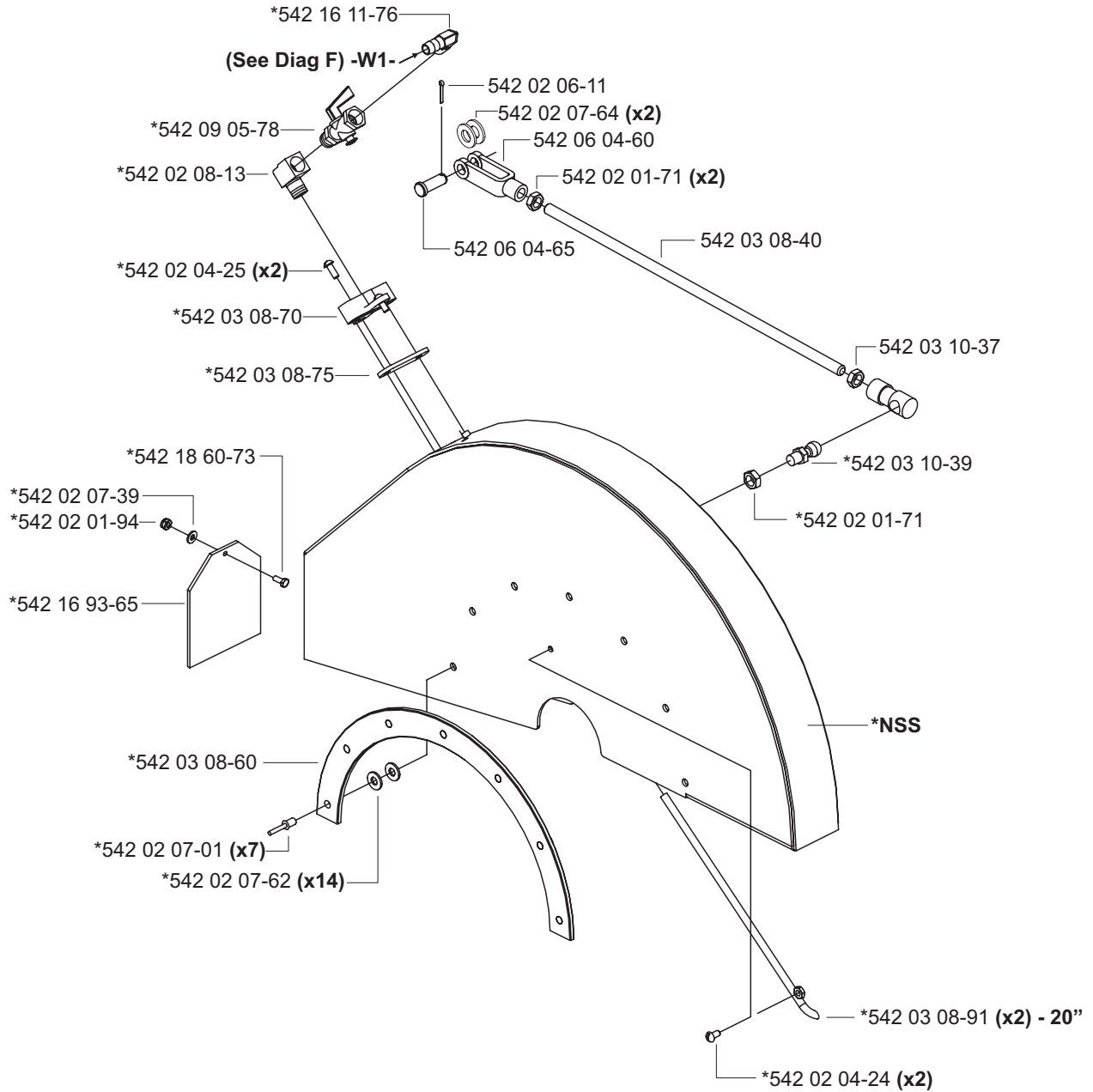

**WARNING**

Read and understand the entire operators manual before using this machine.

If you DO NOT have an Operators Manual, Call Toll Free 1-800-288-5040

**Machinery Hazard**

- Always keep all guards in place.
- Always keep all parts of your body away from all moving parts.

Always use only in well ventilated areas.

DO NOT operate near combustible material.

Always wear approved equipment

**WARNING**

EQUIPMENT IS FURNISHED WITH A 3 WIRE GROUNDING PLUG. BE CERTAIN EQUIPMENT IS CONNECTED TO A GROUNDING CIRCUIT. FAILURE TO COMPLY COULD RESULT IN DEATH OR SERIOUS BODILY INJURY. SEE OPERATOR'S MANUAL FOR INSTRUCTIONS. IF YOU DO NOT HAVE AN OPERATOR'S MANUAL, CALL TOLL FREE 1-800-288-5040

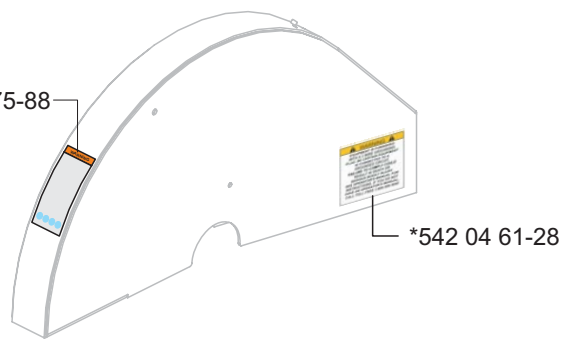

NSS - Not Sold Separately

# K Wheel-Around Kit (Optional)

542 03 40-00 Compl

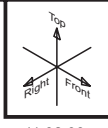

11.02.06

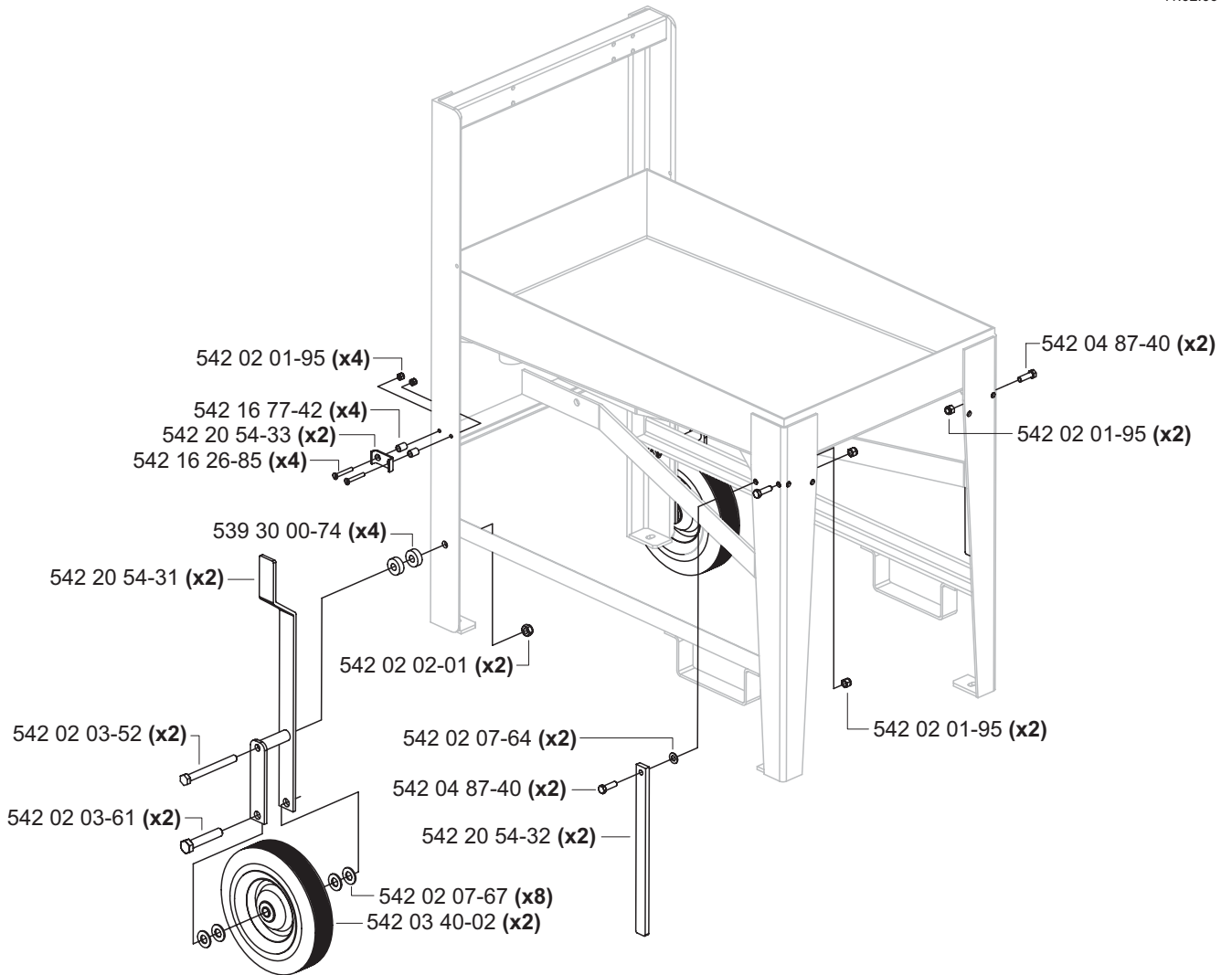

000 A0 30-00

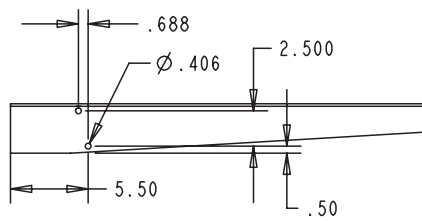
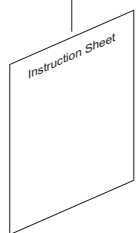

FRONT LEGS MODIFICATION

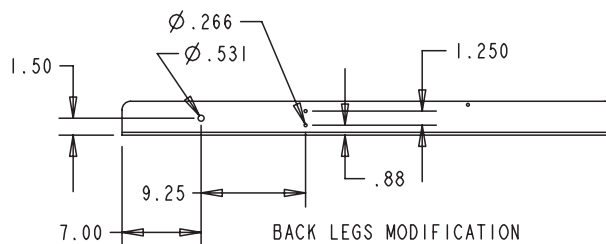

BACK LEGS MODIFICATION

**Husqvarna Construction Products N. A.**  
**Corporate Office**  
17400 West 119th Street  
Olathe, Kansas 66061  
Tel. 913-928-1000  
Fax 913-438-7951

Customer Service: 800-288-5040  
Customer Serv. Fax: 800-825-0028



### **DUST WARNING**



**Cutting, especially when DRY cutting, generates dust that comes from the material being cut, which frequently contains silica.** Silica is a basic component of sand, quartz, brick clay, granite and numerous other minerals and rocks. Exposure to excessive amount of such dust can cause:

- Respiratory diseases (affecting your ability to breath), including chronic bronchitis, silicosis and pulmonary fibrosis from exposure to silica. These diseases may be fatal;
- Skin irritation and rash; and
- Cancer according to NTP\* and IARC\*  
\* National Toxicology Program / International Agency for Research on Cancer

Take precautionary steps

- Avoid inhalation of and skin contact with dust, mist and fumes;
- Wet cut when feasible, to minimize dust;
- Wear and ensure that all bystanders wear appropriate respiratory protection such as dust masks designed to filter out microscopic particles. (See OSHA 29 CFR Part 1910.1200)

**California Prop 65 Warning:**

Use of this product can cause exposure to materials known to the State of California to cause cancer and/or birth defects or other reproductive harm.



Printed in the USA