

RS 8500D T3

Reservdelar

Spare parts

Ersatzteile

Pieces de rechange

Piezas de repuesto

Ricambi

Peças sobresselente

Reserveonderdelen

RS8500D T3

PART NO.	POS.	DESCRIPTION	PART NO.	POS.	DESCRIPTION
015 70 02-31*	A	Collar, Set 1.25 ID	539 30 07-70	B2	Nut, Thin, Nylock, 3/8-16
015 70 06-18*		Terminal, Insul	539 30 11-48	G	Washer, Snubbing .67ID 2.76OD
501 98 70-01	C	Decal, Hydraulic Oil ISO-46	539 30 13-67	E	RHMS, #6-32 x 1 Slt'd
502 07 78-01	A	Frame, Battery, H-Org	539 90 01-88	A	Lockwasher, Split .375
504 84 33-02	H2	Radiator, CAC 99HP	539 97 69-34	A,B,B2,C,D,G,H2,S	HHCS, .3125-18 x .75
504 85 19-01	F1,G	Engine, Cummins B3.3TAA T3	539 97 69-78	A,D,L2,S	Nut, 1/4-20, Nyloc
504 85 89-05	J	Hose, Turbo-CAC	539 97 69-79	B2,C,K1,L1	Nut, 3/8-16, Nylock
504 85 89-06	J	Hose, Turbo-CAC	539 97 69-82	B,O	Washer, Flat SAE .625
504 90 72-01	J	Hose, Radiator-Tube	539 97 77-61	A,L2	HHCS, .25-20 x 1
504 90 72-02	J	Hose, Engine - Tube	539 99 00-52	A,D,K2	Lockwasher, Split .25
504 90 73-01	J	Hose, Vent - Radiator	539 99 00-55	F,G,L2	Washer, Flat .25
504 90 73-02	J	Hose, Radiator Return-Vent	539 99 00-71	A,D	HHCS, .25-20 x .5
504 90 74-01	J	Hose, CAC-Manifold	539 99 01-18	B1	Lockwasher, Split .375
504 90 75-02	J	Tube, Turbo-CAC - Blk	539 99 01-22	C,K1	Washer, Flat SAE .375
504 90 75-04	J	Bracket, CAC Tube H-Gray	539 99 01-34	B1	HHCS, .375-16 x .75
504 90 75-06	B1	Bracket, Headlight H-Gray	539 99 01-87	A,B,C,D,G,K1,N2,S	Washer, Lock .3125
504 90 76-01	B,B1,H2	Bracket, Radiator, H-Gray	539 99 01-88	B,B2,G,H,S	Washer, Flat SAE .3125
504 90 76-05	B1,H2	Radiator Top, H-Gray	539 99 01-96	S	Nut, Hex .3125-18
504 90 78-01	B1,H2	Radiator Cradle, H-Gray	539 99 02-09	D,G,H,H1,K1,S	HHCS, .3125-18 x 1
505 12 99-08	H2	Filter, Radiator	539 99 02-50	B	Washer, Flat SAE, .5
505 12 99-09	H2	Filter, CAC	539 99 02-54	C,K1	Lockwasher, Split .5
505 12 99-10	H2	Bracket, Radiator Blk	539 99 03-33	M,O	Lockwasher, Split .625
505 53 19-01	O	Pin, Dowel .375 x 1.5	539 99 05-17	B1,B2,L1	Washer, Flat .375
505 63 04-01	H2	Locknut, Fiber #10-24	539 99 05-55	F	Pin, Cotter 3/32 x 1/2"
505 74 91-01		Spiral Wrap, 1"	539 99 05-56	B	Nut, Hex .625-11
506 49 29-01	C	Bearing, 1.25" Tapped Base	539 99 05-63	C,K1	HHCS, .375-16 x 1
510 05 70-01	R1	Hyd.Fit., 6400-10-8	539 99 05-80	D,K2,X1	HHCS, .25-20 x .75
510 23 72-01	L1	Belt, AX42	539 99 06-55	A	HHCS, 3/8-16 x 1-1/2
521 88 53-02	E	Decal, Oil, Overfill	539 99 07-17	D,G,H,H1,S	Nut, .3125-18, Hex Nylock
521 93 35-01	J	Clamp, T-Bolt Spring Loaded	539 99 07-30	B2	HHCS, .375-16 x 1.75
521 97 09-05	XS	IPL Parts List: RS8500D T3	541 20 00-37	D	Night Light - Compl
521 97 35-18	H	Reservoir, Coolant Recovery	541 20 00-53	K1	Wheel, Rear - Compl
521 97 35-79	L1,U	Hose, 3000P, 8FJ - 8FJ90 x 35"	541 20 01-29	D	Control Lever Assy
522 53 54-03		Wire Assy Grid Heater	541 20 04-67	S	Clamp, Pointer Rope
522 73 06-01	B	Bracket, LH Front Grd, H-Org	541 20 04-71		Cable Tie 3-5/8" Lg.
522 73 06-03	B	Bracket, RH Front Grd, H-Org	541 20 04-88	L1	Switch, Water Pressure Safety
525 41 64-01	J	Tube, Radiator Vent - Blk	541 20 04-91		Cable, Battery 16" Red
525 43 47-03	J	Hose, Heater - 3/4"	541 20 05-42	D	Switch, Raise/Lower
525 44 86-01	H,H2,J	Hyd. Fit., 3400-4	541 20 05-43	Q	Wire, Raise/Lower, 16-3 SJ00WB
525 55 07-01	H,J	Hyd. Fit., 4244-2-4	541 20 05-68	X1	Flap, Blade Guard Splash
525 56 72-01	H	Hose, 1/8" ID Fuel Line	541 20 05-70	X1	Lanyard, 12", 18-26" Guard
539 10 13-13	S	HHCS, .25-20 x 2	541 20 05-75		Term, Ring, 1/4, 10 Ga.
539 10 13-31	A,S	Nut, 1/2-13, Nyloc	541 20 05-81		Wire, 14 Ga. Red
539 10 13-41	C	HHCS, .375-16 x 3	541 20 05-95	A,D,G	Night Light 12 VDC
539 10 41-99	A	HHCS, .625-11 x 2	541 20 06-00	D	Decal, Raise/Lower Switch
539 30 00-06	T	Valve, Ball, 1/2"	541 20 06-18	Q	Valve, Cartridge - Lift Pump
539 30 00-11	M	Hose Clamp, W-D SAE006	541 20 06-19	Q	Coil, Solenoid - Lift Pump
539 30 00-12	A	Pad, Battery	541 20 06-78	A	Oil Cooler
539 30 00-37	C,K1	HHCS, .50-13 x 1.25	541 20 07-15	A	Steering Wheel
539 30 00-72	C1,T	Clamp, Hose, MAH-4 Fuel Line	541 20 07-18	K1	Wheel Hub
539 30 00-73	J	Hose Clamp, W-D SAE32	541 20 07-22	X1	Decal, SMI Caution
539 30 00-77	T	Washer, Hose	541 20 07-26	T	Tubing, Clear, 5/16 ID
539 30 00-80	C	Grommet, Fuel Tank	541 20 07-43	K1	Tire, Press On, 12 x 5 x 8
539 30 00-85	C,C1	Cap, Fuel Tank	541 20 07-45	D,L2	Cable, Control 108" Long
539 30 01-09	A	Grommet - Oil Hose	541 20 07-46	D	Boot, Rubber
539 30 01-12	D,E	Switch, Nite Lite/Water Safety	541 20 07-53	C	Cap, Filler Breather
539 30 01-13	D,E	Switch Boot, Gray	541 20 07-56	A	Trim, Steel
539 30 01-33	O	Wrench, Bladeshaft, 15/16"	541 20 07-57	A	Fastener Rubber Hood
539 30 01-35	M,T	Hose, Water, 1/2", Bulk	541 20 07-59	A	Steering Column
539 30 01-45		Term., Female Disconnect	541 20 07-62	L2	Rod End, Ball Joint
539 30 01-60	B,C	Decal, Caution, Keep Hands	541 20 07-65	Q,U	Hose, 2250P, 6FJ - 6FJ x 14"
539 30 01-84	A	Battery, 35-60	541 20 07-69	K2,R2,U	Hose, 2250P, 6FJ - 6FJ x 36"
539 30 02-14	E	Meter, Volt	541 20 07-93	C	Pad, Tank (Long)
539 30 02-26	E	Switch, Ignition w/ Keys	541 20 07-94	C	Pad, Tank (Short)
539 30 02-42	M	Pipe Fit. St.Elbow, 1/2" Galv	541 20 07-95	C	Pad, Tank (Top)
539 30 02-43	T	Pipe Fit. Close Nipple, 1/2"	541 20 07-99	C1,U1	Valve, Ball, 3/4"
539 30 02-56	A,B,G	Nut, 5/8-11, Nyloc	541 20 08-01		Cable Tie Mounts
539 30 02-69	T	Hyd.Fit., 4045-12-8	541 20 08-03	S	Flap, Front Mud
539 30 02-70	L1	Screw, Set, .3125-18 x 3/8	541 20 08-04	X1	Flap, Blade Guard Side
539 30 02-71	X1	Pipe Fit.. Plug 1/8" Soc	541 20 08-34	E	Terminal Block
539 30 02-83	C,Q	Pin, Hair Cotter	541 20 08-47	O	V-Belt, 3VX560 4-Band
539 30 03-04	F	Pivot, Pin	541 20 08-48	O	V-Belt, 3VX530 3-Band
539 30 03-06	F	SHSS, 10-32 x .25 Cup Pt B/O	541 20 08-51	F	Cable, Throttle Locking
539 30 03-10	R1,R2	Hyd.Fit., 6801-6	541 20 08-55	C	Decal, Diesel Fuel
539 30 03-87	A	Battery Hold Down	541 20 09-27	A	Shim, A.005
539 30 04-40	M	Cap, Bolt, 5/8 UHMW	541 20 09-28	A	Shim, A.010
539 30 06-20	B,O	HHCS, .625-11 x 1.75	541 20 09-29	A	Shim, A.025

NOTE: Part No's. that have an ASTERISK (*) suffix may not be active 9-digit numbers. The '542' prefix has been added to current 6-digit part numbers and '0' to 7 and 8-digit numbers.

RS8500D T3

PART NO.	POS.	DESCRIPTION	PART NO.	POS.	DESCRIPTION
541 20 09-89	G	Gauge, Air Flow Restriction	541 20 49-43	S	HHCS, .5-13 x 2.25
541 20 09-92	T	Switch, Pressure	541 20 49-75	H1,L1,R1	Hyd.Fit., 6400-8
541 20 09-94	K1	Actuator, Steering	541 20 49-77	R1	Hyd.Fit., 6400-6-8
541 20 10-08	E	Light, Green - Oil Diesel	541 20 49-85	Q	Hyd.Fit., 2605-4
541 20 10-14	A	Cable, Battery 16" Blk	541 20 49-91	K2	Hyd.Fit., 6400-6-10
541 20 10-77	L2	Spring, Control Arm	541 20 50-11	R1	Hyd.Fit., 6400-4
541 20 10-78	D	Handle, Control Base	541 20 50-25		Hyd.Fit., 6408-8
541 20 11-62	C1	Hose, Fuel 1/2"	541 20 50-42	L1	Hyd.Fit., FG 6801-8-12
541 20 12-70	E	Tachometer, Hour Meter (Diesel)	541 20 50-59	H1,K2,Q	Hyd.Fit., 6801-4-4
541 20 13-14	A	Decal, Warning	541 20 50-65	S	Bolt, Eye 1/4" x 2 1/2"
541 20 13-88	E	Key, Ignition	541 20 50-96	L1	Hyd.Fit., 6502-8
541 20 13-91	O	V-Belt, 3VX560 3-Band	541 20 50-97	K2	Hyd.Fit., 6502-6
541 20 16-61	E	Breaker, Circuit 25 Amp	541 20 52-67	Q	Pipe Fit. Nipple 3/8 x 6
541 20 21-15	D	Night Light Bar	541 20 57-64	A,X1	Washer, Flat .25
541 20 22-71	A	Steering Wheel Hub	541 20 58-69	C1	Hyd. Fit., 5500-12
541 20 22-78	A	Water Jet, Rear Pointer B	541 20 62-00	A,R2	Steering Orbitrol w/Pwr Beyond
541 20 22-79	T	Water Jet, Rear Pointer	541 20 62-12	A	Wheel, 12 x 5, 1-1/4 Front
541 20 22-87	D	Switch Plate	541 20 62-18	A	Pin, Wheel
541 20 23-10	D	Handle, Switch Blk	541 20 62-93	B,G	Engine Mnt, Blk
541 20 23-29	D	Pad, Arm Rest	541 20 63-16	G	Motor Mount, Blk
541 20 23-31	D	Lever Tube, Control Handle	541 20 63-63	O	Sheave, 6Gr 3V x 4.75 Taper
541 20 23-33	S	Rod, Front Pointer	541 20 65-50	Q,U	Hose, 3000P, 4FJ90, 4FJ x 27"
541 20 23-36	C1	Hose Boom	541 20 65-80	R2,U	Hose, 3000P, 6FJ90, 6FJ x 19"
541 20 23-48	K1	Wheel Rim, 8 x 5	541 20 66-57	G	Bracket, Fuel Filter, Blk
541 20 23-71	S	Mount, Front Mud Flap	541 20 66-91	G	Clamp, Exhaust
541 20 23-72	S	Clamp, Front Mud Flap	541 20 66-98	G	Hyd.Fit, M22-1.5 to #10MJ 90
541 20 24-72	F	Throttle Bracket, Blk	541 20 66-99	G	Hose Assy, 1/2" ID x 20"
541 20 26-40	L2	Control Arm, Trans, PC Blk	541 20 67-00	G	Sheave, 1Gr, A x 6.0
541 20 38-35	O	V-Belt, 3VX530 4-Band	541 20 67-86	G	Bracket, Engine Cover, Blk
541 20 39-64	L1	Hyd.Fit., 6400-8-12	541 20 67-90	G	Spacer, Guard, Blk
541 20 45-83	Q	Hyd.Fit., 6805-6-4	541 20 68-01	B2	Tension Bracket, Blk
541 20 45-84	Q	Hyd.Fit., 5404-4	541 20 68-04	H1	Fan Motor Support, Blk
541 20 45-85	Q	Hyd.Fit., 2501-4	541 20 68-82	P	Bladeshaff RS8500D Taper
541 20 45-86	T	Hyd.Fit., 5406-8-2	541 20 68-83	O	Sheave, 3V x 4.5 x 8Gr Taper
541 20 45-87	M	Pipe Fit. Close Nipple, 3/8"	541 20 68-84	O	Sheave, 3V x 4.5 x 6Gr Taper
541 20 45-88	M	Pipe Fit. Coupling, 3/8" Gal	541 20 68-85	O	Key, .25 x 1.125, Round One End
541 20 45-93	T	Pipe Fit., Tee, 1/2"	541 20 68-88	O	Inner Flange 5" B/O
541 20 46-24	D	HHCS, .3125-18 x 2.5	541 20 68-92	A	Flap, Mud, RS
541 20 46-29	A	HHCS, .25-20 x 1-1/4	541 20 68-93	H1	Motor, Hyd Fan Drive
541 20 46-44	A,B	HHCS, .5-13 x 1.75	541 20 69-26	E	Water Temp Gage w/ Shutdown
541 20 46-52	B	HHCS, .625-11 x 6, FT	541 20 69-43	N1	Flywheel Coupling
541 20 46-65	X1	Pin, Detent Ring, 1/4 x 2-1/4	541 20 69-77	X1	Bladeguard, U/C, 14" - Compl
541 20 46-88	Q	Nut, Solenoid Coil - Lift Pump	541 20 69-78	X1	Bladeguard, U/C, 20" - Compl
541 20 46-95	K2	Hyd.Fit., 6400-6-4	541 20 69-79	X1	Bladeguard, U/C, 26" - Compl
541 20 46-97	G	Hyd.Fit., 5406-Cap-8	541 20 71-00	O	Kit, Sheave Puller
541 20 47-06	M	Hyd.Fit., 4145-8-12	541 20 80-01	O,P	Bladeshaff Assy RS8500D 14-26
541 20 47-11	A	Hyd.Fit., 2501-8-8	541 20 80-02	H	Fan 18 Inch
541 20 47-23	A	Nut, Jam .75-16	541 20 80-03	H	Transtorque .5 ID x .875 OD
541 20 47-34	A	Hyd.Fit., 2404-8-8	541 20 80-06	P	Flange End Cover
541 20 47-51	C1	Hyd.Fit., 4311-8	541 20 80-16	O	Sheave 8Gr 3V x 6.375 Taper
541 20 47-56	R1,R2	Hyd.Fit., 6400-6	541 20 80-17	O	Sheave 6Gr 3V x 6.375 Taper
541 20 47-65	L1	Hyd.Fit., 6801-6-10	541 20 80-22	P	O-Ring -044
541 20 47-80	A,D	Washer, Flat .3125	541 20 80-30	L1,U	Hose, 3000P, 6FJ90 - 6FJ x 38"
541 20 47-84	L2	HHCS, .25-20 x 1.5	541 20 80-33	H2,R2,U	Hose, 3000P, 6FJ90, 6FJ x 67"
541 20 47-95	Q	Hyd.Fit., MJIC Bulkhead, 270	541 20 80-34	A,C1,H1,L1,U	Hose, 250P, 8FJ90 - 8FJ x 42"
541 20 47-96	R2	Hyd.Fit., 2700LN-6	541 20 80-39	R2,U	Hyd.Fit., 6801-LL-6
541 20 48-01	T	Hyd.Fit., 5406-16-8	541 20 80-46	C1	Hyd Fit 4290-6-4
541 20 48-07	H1,L1,R1	Hyd.Fit., 6801-8	541 20 80-47	C1	Hose, Fuel, 3/8"
541 20 48-09	D	PHMS, #4 x 1/2, Sltd	541 20 80-58	G	Bracket, Front Light, Blk
541 20 48-11	E	RHMS, 8-32 x 1/2 Sltd	541 20 81-44	G	Deflector, Blk
541 20 48-15	T	Hyd.Fit., 4290-5-6	541 20 83-76	X1	Blade Guard 26" U/C, H-Gray
541 20 48-16	T	Pipe Fit., Tee, 3/8", Galv.	541 20 83-77	X1	Blade Guard 20" U/C, H-Gray
541 20 48-17	T	Hyd.Fit., 5406-8-6	541 20 83-78	X1	Blade Guard 14 U/C, H-Gray
541 20 48-18	T	Hyd.Fit., 5406-6-4	541 20 83-79	B	Belt Cover LH, H-Org
541 20 48-21		Connector Two-Way	541 20 83-80	B	Belt Cover RH, H-Org
541 20 48-23	A	SHCS, .25-20 x 1/2	541 20 83-81	A	Main Frame, H-Gray
541 20 48-24	A,D	FLHMS, .3125-18 x 1	541 20 83-82	B	Belt Cover Panel, H-Org
541 20 48-25	K1	Pin, Cotter, 1/8 x 2"	541 20 83-83	C	Fuel Tank, H-Org
541 20 48-26	A	Rivet, #64 BAA	541 20 83-85	C	Hyd Tank, H-Org
541 20 48-27	C,Q	Pin, Cylinder, Headless	541 20 83-87	C	Cover, Hyd Tank, H-Org
541 20 48-29	L2	Nut, .25-28	541 20 83-89	E	Instrument Panel, H-Gray
541 20 48-36	D	Nut, Hex .5-20	541 20 83-90	S	Bracket, Front Pointer, H-Gray
541 20 48-38	B2	Bolt, 3/8-16 x 4, Full Thread	541 20 83-91	G	Engine Cover Top, H-Gray
541 20 48-55	T	Hyd.Fit., 4024-12-8	541 20 83-94	A	Side Plate, H-Gray
541 20 48-70	C1,M	Hyd.Fit., 4312-8	541 20 83-95	G	Engine Cover Small, H-Gray
541 20 49-12	H	Pipe Fit. Plug, 1/4" NPT Blk	541 20 83-96	A	Front Cover Plate, H-Gray
541 20 49-24	C,Q	Pin, Cotter 3/16 x 2"	541 20 83-97	A	Console Cover, H-Org

NOTE: Part No's. that have an ASTERISK (*) suffix may not be active 9-digit numbers. The '542' prefix has been added to current 6-digit part numbers and '0' to 7 and 8-digit numbers.

RS8500D T3

PART NO.	POS.	DESCRIPTION	PART NO.	POS.	DESCRIPTION
541 20 83-98	A	Instrument Box, H-Org	542 18 23-05	B	Bracket, Support (Eng Rear) H-Gry
541 20 84-01	G	Engine Cover Top Bracket, H-Gray	542 18 33-75*	N1	Plug, Hole, 3/4"
541 20 84-02	G	Engine Cover Lower, H-Gray	542 18 33-83*		Terminal, Ring #6 16-14 Ga
541 20 84-03	B2	Pitts Clutch Cover, H-Gray	542 19 07-00	C	Decal, Husqvarna
541 20 84-04	D	Night Light Bracket, H-Gray	542 19 07-33	B	Decal, Husqvarna, 9.850" Lg
541 20 84-05	D	Seat Base & Armrest, H-Org	542 19 14-29	P	Bearing 209PP
541 20 84-06	C	Fuel Tank w/Seat Mnt, H-Org	542 19 19-62	O	Lockwasher, Split M16 DIN127
541 20 84-07	B2,C	Raising Frame Rider, H-Gray	542 19 19-63	P	Vent Plug 1/8 NPT
541 20 84-08	A	Floor Plate, H-Gray	542 19 19-96	N2	HHCS, M8-1.25 x 20 933-10
541 20 84-09	A	Wheel Fork LH, H-Gray	542 19 81-13	N2	HHCS, .312-18 x 1.25 Gr 8
541 20 84-10	A	Wheel Fork RH H-Gray	542 19 81-19*		Boot, Rubber, Battery Cable, Red
541 20 84-11	S	Front Pointer Long, H-Gray	542 19 85-09		Flywheel & Ring Gear - Mod.
541 20 84-12	S	Front Pointer Short, H-Gray	542 19 87-32	N1	Flywheel
541 20 85-01	B	Tab, Bladeguard, H-Gray	542 19 87-33	N2	Bearing, Ball, 25mm 9105PP
542 02 00-49*	H	Hose Clamp, W-D SAE004	542 19 89-53	N2	Snap Ring, 1.375 Shaft
542 02 01-32*	E	Nut, Hex #10-24	542 19 90-29	H2	Rubber Insulator, Neoprene
542 02 01-33*	L2	Nut, Hex .25-20	542 19 90-44	P	HHCS, M8-1.25 x 75 8.8
542 02 01-80*	O	Nut, Hex Jam Thin 1-14	542 19 90-45	O	Key, .25 x 2.5, Round Both Ends
542 02 01-98*		Locknut, Fiber .375-24	542 19 90-53	N2	Bolt, Hex Wshr Hd M8-1.25x25 Dog Pt
542 02 04-61*	H2	SBHCS, #10-24 x .875	542 19 93-87	N2	Hub, Clutch Drive
542 02 05-87*	E	HWHSTS, 10-24 x .375 Type F Sltd	542 19 93-96	N2	Field Coil w/ Leads 12VDC
542 02 07-39	D	Washer, Flat #10	542 19 94-80	N2	Bushing, Rubber 1/2 x 3/4
542 02 07-85*	N2	Lockwasher, Split .3125 (M8)	542 19 94-81	M,N1,O	Gear Box-Superior
542 02 08-15*	Q	Street Elbow, 3/8, Brass	542 19 96-77	H2	Lanyard, 24" Nylon Coated
542 02 08-90*	S	Sash Cord, 1/4 Dia #85 x 1200	542 20 11-30	XS	OM Op Instr: RS8500D
542 04 02-75*	X1	Fitting, Hose .375 x .75GHT	542 20 51-40	F1	Filter, Oil - B3.3 Engine
542 04 03-30*	H2	Spring, .054 Wire .375OD x 3.5	542 20 51-41	F1	Filter, Fuel - B3.3 Engine
542 04 30-54*	L2	Key, Round End .25 x .843	542 20 51-42	F1	V-Belt - B3.3 Engine
542 04 61-28*	X1	Decal, Warning (Bld Grd Size)	542 20 53-01	Q,U	Valve, Flow Control, 3000 PSI
542 04 77-92*	G	HHCS, M10-1.5 x 30 DIN931	542 20 53-10	A	Kit, Roller Bearing - Wheel
542 09 10-67*	L1	SHCS, .375-16 x 1.5 Gr 8	542 20 60-61	H1,U	Hose, 250P, 4FJ90 - 4FJ x 34"
542 11 01-02*	P	Fitting, Grease	542 20 61-20	Q	Relay, Lift Pump, Heavy Duty
542 13 66-08*	Q	Clamp, Exhaust	542 20 62-01	H2	Lanyard, Filter Retainer
542 13 92-60*	J	Cable, Battery - Lift Pump	542 20 62-44	H	Hose, 5/16 ID x44"
542 16 02-44*	H2	HHCS, .3125-18 x .625	542 20 62-88	K1	SHCS, .5-13 x 2.5 Gr 8
542 16 03-93*	M	Washer, Flat .6875	542 20 64-17	E	Led, Red
542 16 07-04*	H2	Petcock	542 20 64-79	P	Bladeshaft Tube w/Tach
542 16 07-23*	H	Hose, Fuel Line 5/16 ID	542 20 66-60	M	Breather Vent, w/Small Hole
542 16 07-95*	A	Key, Woodruf (ANSI #606)	573 96 68-01	H	Clamp, Spring, 5/16 OD
542 16 11-34*	T	Valve, Flow Control	574 20 63-07	G,J	Bracket, Radiator Tube H-Gray
542 16 34-89*	G	HHCS, .625-11x4.25 RH Thd Gr Bd	574 21 55-01	J	Tube, Radiator Rider - Blk
542 16 36-88*	A	HHCS, M6-1.0 x 16 DIN933	574 21 72-01	B1,H	Shroud, Blk
542 16 36-89*		Lockwasher, Split M6	574 22 85-01	B1,H2	Bracket, Rear Radiator - H-Gray
542 16 39-86*	X1	Decal, Blade Direction-LH	574 30 51-01	G	Hose, Air Intake
542 16 46-32*	O	Key, Woodruff (Ansi #808)	574 40 93-01	J	Flange, Turbo
542 16 59-07*	E	Locknut, Fiber Hex #6-32	574 41 05-01	A	Frame, Lift Bale H-Gray
542 16 62-86*	O	Flange, Blade Outer 5" QDS B/O	574 45 40-01	F1	Wiring Harness Engine
542 16 63-52*	G,M	Isolator, Engine	574 45 40-02	E	Harness, Instrument Panel
542 16 63-65*	O	Sheave, 8Gr 3V x 4.75 Taper	574 51 74-01		Cable, Ground 0 Ga. - 63"
542 16 63-68*	M	HHCS, M16-2 x 90 DIN933	574 51 75-01	A	Cable, Pos. Battery 0 Ga. - 78"
542 16 63-93*	H	Cap, Radiator 10PSI	574 52 76-01	H	Expansion Tank - Blk
542 16 64-15*	L1	Sender, Water Temp	574 53 17-01	G	Air Cleaner
542 16 64-18*	M,O	Washer, Flat 2.8 x .657 x .188	574 53 19-01	H3	Band Air Cleaner Mount
542 16 64-80*	O	Washer, Flat 1.030 x 2.25	574 53 35-01	G	Primary Filter Element
542 16 66-30*	J	Hose Clamp, W-D SAE24	574 53 35-02	G	Safety Filter Element
542 16 66-74*	D,N2	Clamp, Vinyl Coated 3/8 x 3/8	574 53 35-03	G	Vacuator Valve
542 16 66-75*		Clamp, Vinyl Coated 3/8 x 1/2	574 53 35-04	G	Cover Assy
542 16 66-85*	N2	Rotor, Electric Clutch	574 55 44-01	G	Muffler D
542 16 66-86*	N2	Armature Plate	574 55 46-01	G	Clamp, Muffler
542 16 68-53*	H2	Decal, Radiator Filter	574 55 47-01	G	Clamp, T-Bolt 3.5"
542 16 68-78*	E	PHMS, #10-24 x 1 Type F	574 55 47-03	J	Clamp, T-Bolt 3.0
542 16 69-07*	T	Valve, Oil Drain	574 55 47-04	G	Clamp, T-Bolt 4 1/32 - 4 11/32
542 16 69-51*	D	HWHSTS, 10-24 x .5 Type F	574 55 48-01	G	Tube, Exhaust Elbow 3"
542 16 74-47*	M	HHCS, M16-2 x 45 DIN931	574 55 48-02	G	Tube, Exhaust Dbl Elbow 3"
542 16 67-08	E	Relay, NO/NC	574 55 49-01	G	Bracket, Muffler Mount - Blk
542 16 68-80	G	Adaptor, Restriction Indicator	574 56 95-32	L1	Pulley, A 6.0
542 16 94-86*	A,C1,D,S	Knob, .3125-18 x 1, 4 Prong	574 56 95-33	B2,L1	Pump Mount H-Gray
542 17 10-44*	H2	SBHCS, #10-24 x .5	574 56 95-38	K1	Bracket, Manifold, H-Gray
542 17 18-91*	H2	Blind Rivet 3/16 Dia	574 56 95-40	A	Plate, Steering Tilt
542 17 24-95*		Lockwasher, Split M12 DIN127	574 59 47-01	G	Mounting Bracket Muffler 8.5"
542 17 30-05*	N1	HHCS, M10-1.5 x 16 DIN933	574 60 94-01	J	Fitting Expnd Brs NPT 3200-6-8
542 17 49-86*	J	Clamp, Hose-W-D SAE12	574 60 95-01	J	Fitting Hose Barb 4290-12-8
542 17 63-83	E	Switch, Mushroom Stop	574 68 33-02	R1	Valve, Relief
542 17 70-64*	G	HHCS, M10-1.5 x 45 DIN933	574 68 33-03	R1	Valve, Check
542 17 86-56*	K2	Clamp, Vinyl Coated	574 69 39-01	L1	Pump Hydr Gear 6.3 CC
542 18 11-09*	M	Nut, Hex Jam M16-2	574 70 48-01	E	Decal, Instrument Panel
542 18 22-33	N2	Diode Assy, FSZ Clutch	574 71 50-01	J	Clamp, Exhaust 1.50"

NOTE: Part No's. that have an ASTERISK (*) suffix may not be active 9-digit numbers. The '542' prefix has been added to current 6-digit part numbers and '0' to 7 and 8-digit numbers.

RS8500D T3

PART NO.	POS.	DESCRIPTION	PART NO.	POS.	DESCRIPTION
574 72 24-01	K1	Hydraulic Motor Wheel w/Brake			
574 79 27-01	K1,R1	Valve Manifold - Compl			
574 79 27-03	R1	Valve, Solenoid			
574 79 27-04	R1	Coil, Solenoid 12 VDC			
574 79 27-05	R1	Valve Cartridge Shuttle			
574 79 27-07	R1	Cartridge, Filter			
574 79 27-08	R1	Nut, Solenoid			
574 79 27-09	R1	Valve, Check			
575 22 34-01	C,Q	Hydraulic Cylinder 1.5 x 5"			
575 22 95-01	L1	Hydraulic Pump 20,3cc			
575 32 50-01	K2,U	Hose, 250P, 4FJ - 4FJ x 54"			
575 32 50-02	K2,U	Hose, 3200P, 4FJ - 4FJ x 47"			
575 32 50-03	K2,U	Hose, 3000P, 6FJ - 6FJM90 x 52.5"			
575 32 50-05	L1,U	Hose, 2500P, 8FJ90, 8FJ x 21"			
575 32 50-06	R2,U	Hose, 250, 6FJ90, 6FJ x 23"			
575 32 50-07	L1,U	Hose, 250P, 8FJ90, 8FJ x 24"			
575 32 50-08	C1,L1,U	Hose, 250P, 8FJ 8FJ x 50"			
575 32 50-09	C1,U	Hose, 250P, 10FJ - 10FJ x 26"			
575 32 50-10	A,H1,U	Hose, 250P, 8FJ - 8FJ x 75"			
575 35 75-01	C1	Hyd.Fit., Tee 2605-8-12			
575 35 75-02	C1	Hyd.Fit., 2501-10-8			
575 35 75-04	Q	Fitting Hydr 6804-4			
575 35 75-05	C1	Hyd. Fit., 4311-6-8			
575 35 75-06	C1	Hyd. Fit., 2605-8-8			
575 37 82-02	Q	Pump 12 VDC Horiz w/o Tank			
575 37 85-01	A	Maine Frame			
575 89 15-07	K1	Wheel Fork, Blk			
575 95 17-01	F	Throttle, Fitting			
575 96 62-06	D	Switch, Safety			
576 31 52-05	J	Hose Clamp, W-D SAE12			
576 42 28-01	D	Seat w/ Switch			
725 23 66-71	P	HHCS, M6-1.0 x 12, 8.8			
725 23 68-71	G	HHCS, M6-1.0 x 16 8.8			
725 24 49-71	H	HHCS, M8-1.25 x 16			
725 24 51-71	B,B1,H	HHCS, M8-1.25 x 20			
725 24 55-71	H3	HHCS, M8-1.25 x 30 8.8			
725 24 57-76	N2	HHCS, M8-1.25 x 35 10.9			
725 24 91-71	F,G	HHCS, M10-1.50 x 20 8.8 DIN933			
725 24 93-71	G,J	HHCS, M10-1.50 x 25 8.8			
725 24 95-71	L1,M,N1	HHCS, M10-1.50 x 30			
725 25 36-71		HHCS, M12-1.75 x 30			
725 54 55-51	N2	Screw, Soc. Hd, M8-1.25 x 30 12.9			
731 23 20-01	G	Nut, Hex M10 DIN934			
732 25 16-01	A	Nut, M6-1.0 Nyloc			
732 25 18-01	B,B1,H,H3,P	Nut, M8-1.25, Nyloc			
734 11 54-41	A	Washer, M6 Large Flat			
734 11 63-01	B,B1,H,H2,H3	Washer, M8 Flat			
734 11 65-41	H,H2,H3	Washer, Flat M8 Large			
734 11 72-01	G	Washer, M10 Flat, Steel			
735 11 53-01	G	Washer, Lock M6			
735 11 64-01	B,B1,H,N2	Washer, M8 Lock			
735 11 73-01	F,G,J,L1,M,N1	Washer, Lock M10 DIN 127			
740 38 08-01	P	Washer, Sealing M6			
MISC ITEMS & SPECIAL KITS			LEGEND		
542 20 11-30	XS	OM Op Instr: RS8500D	BHMS		Button Head Machine Screw
			FLHMS		FLat Head Machine Screw
			HHCS		Hex Head Cap Screw
			HWHSTS		Hex Washer Head Self-Tapping Screw
			RHMS		Round Head Machine Screw
			SBHMS		Socket Button Head Machine Screw
			SHCS		Socket Head Cap Screw
			SHSS		Scocker Head Set Screw
			STS		Self-Tapping Screw
			PHCS		Pan Head Cap Screw
			PHMS		Pan Head Machine Screw
			PHSTS		Pan Head Self-Tapping Screw
			FT		Full Thread
			Gr		Grade

NOTE: Part No's. that have an ASTERISK (*) suffix may not be active 9-digit numbers. The '542' prefix has been added to current 6-digit part numbers and '0' to 7 and 8-digit numbers.

NOTES:

A Main Frame & Front Axle

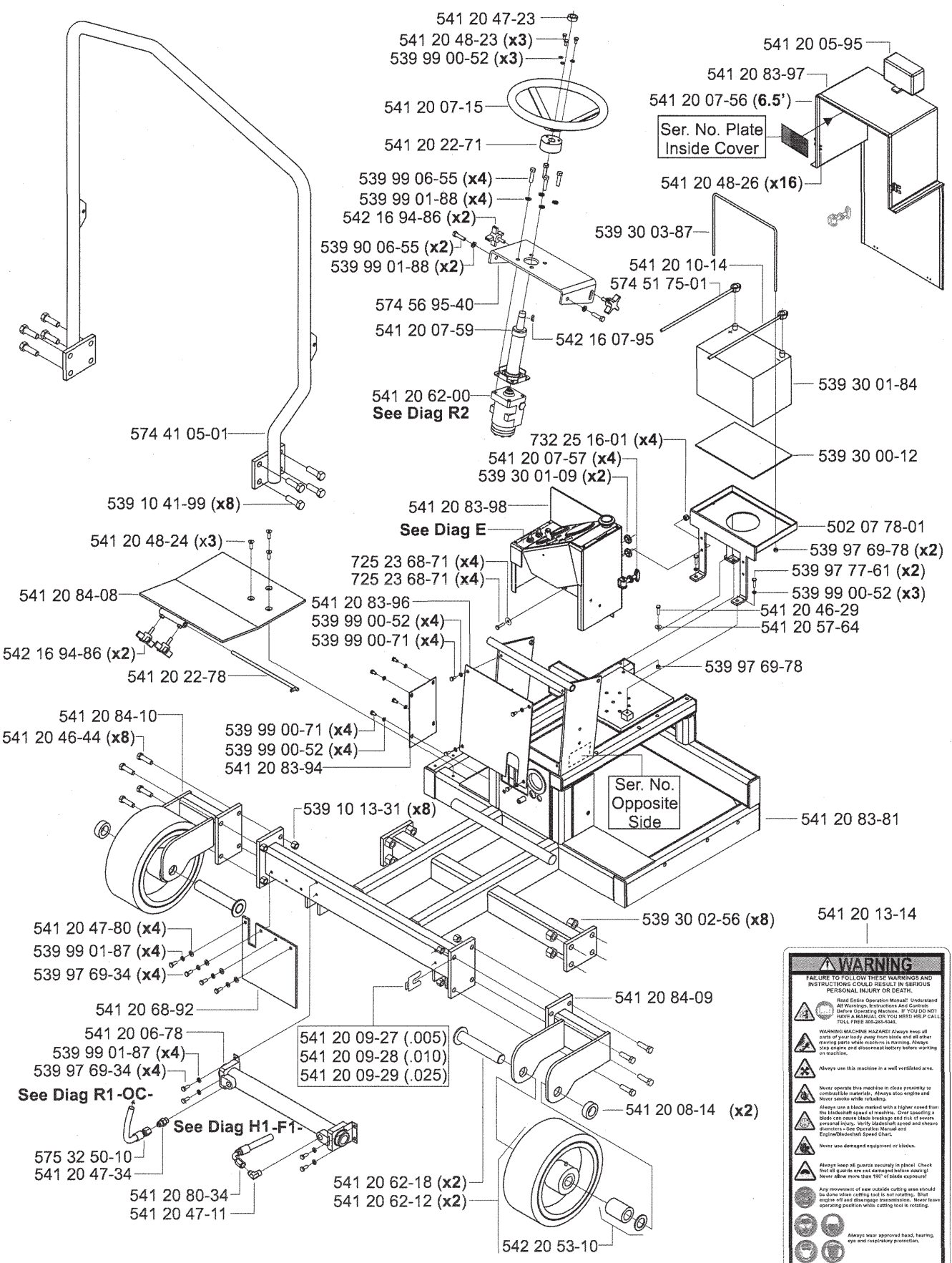
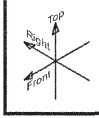

WARNING
 FAILURE TO FOLLOW THESE WARNINGS AND INSTRUCTIONS COULD RESULT IN SERIOUS PERSONAL INJURY OR DEATH.

- Read Entire Operation Manual! Understand all Warnings, Instructions and Controls. Before operating machine, if YOU DO NOT HAVE A MANUAL OR YOU NEED HELP CALL TOLL FREE 800-424-2646.
- WARNING MACHINE HAZARD!** Always keep all parts of your body away from blades and all other moving parts while machine is running. Always stop engine and disconnect battery before working on machine.
- Always use this machine in a well ventilated area.
- Never operate this machine in close proximity of combustible materials. Always stop engine and never smoke while cutting.
- Always use a blade marked with a higher speed than the bladeshaft speed of machine. Over loading a blade can cause blade breakage and risk of severe personal injury. Verify bladeshaft cover and sheave diameters - See Operation Manual and Engine/Bladehub Label Chart.
- Never use damaged equipment or blades.
- Always keep all guards securely in place! Check that all guards are not damaged before using! Never allow more than 1/8" of blade exposure!
- Any movement of saw outside cutting area should be done when cutting tool is not rotating. Stop engine and disconnect transmission. Never leave operating position while cutting tool is resting.
- Always wear approved head, hearing, eye and respiratory protection.

B Raising Frame & Belt Guards

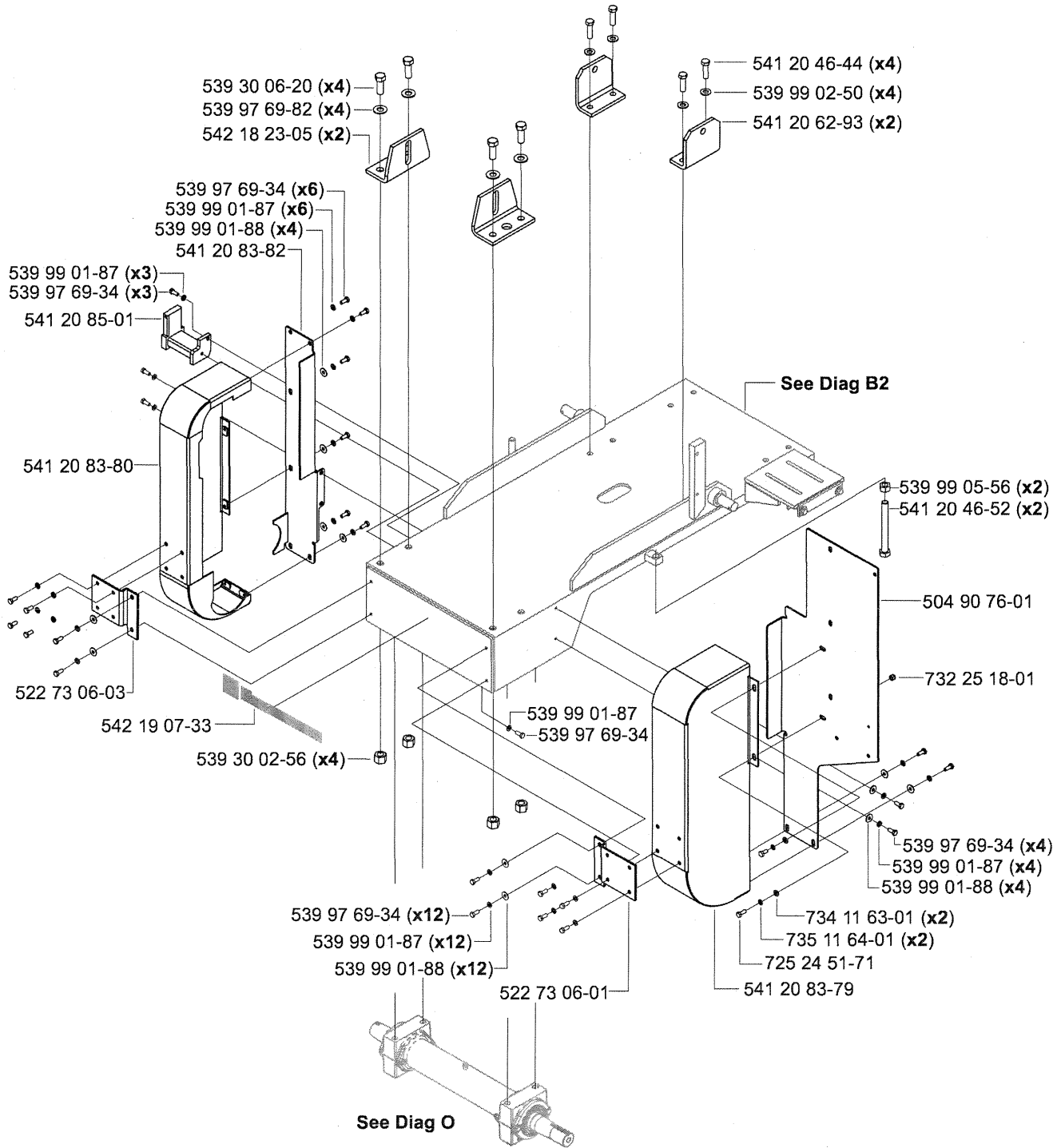
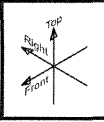

539 30 01-60

542 19 07-33



CAUTION!
 KEEP
 HANDS
 CLEAR!

B1 Radiator Mount

See Diag H2

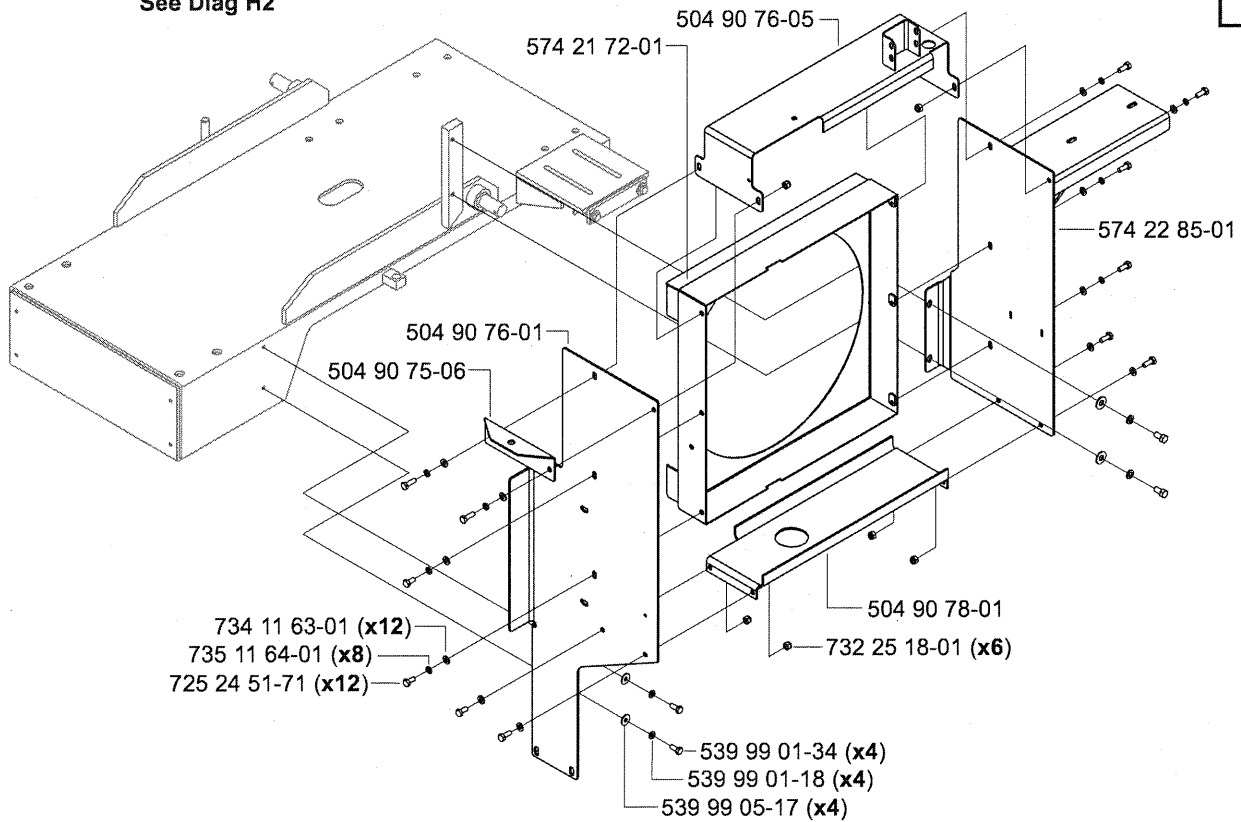
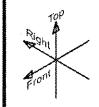

B2 Pump Mount

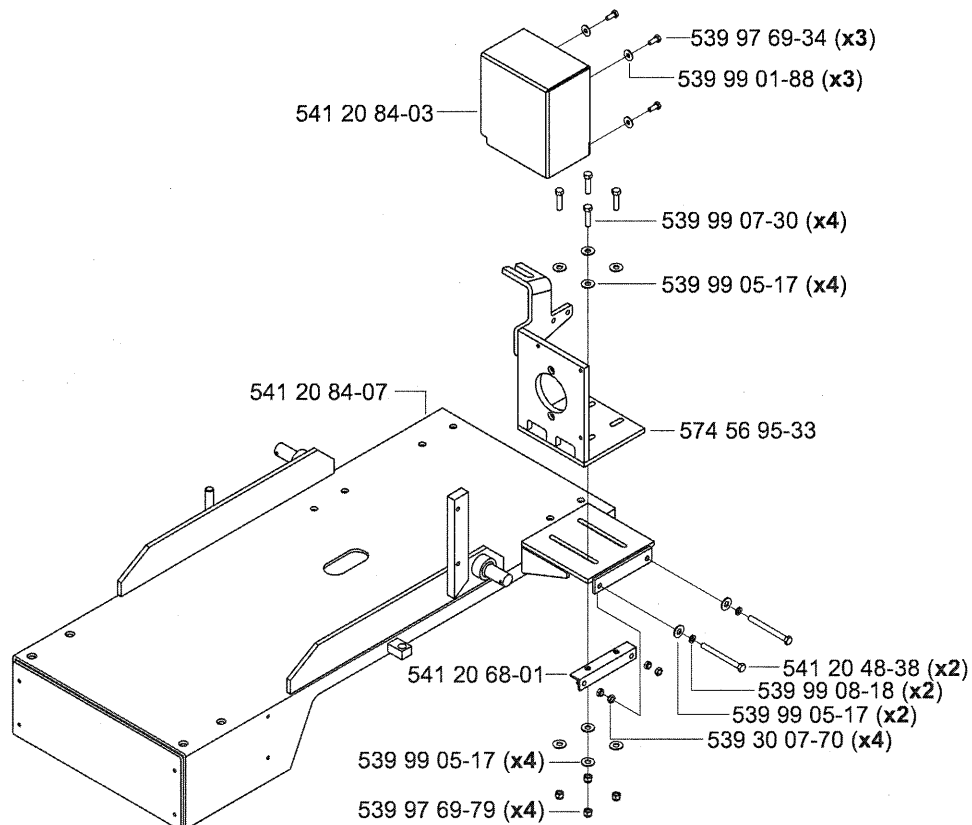

C Tanks & Raising Frame

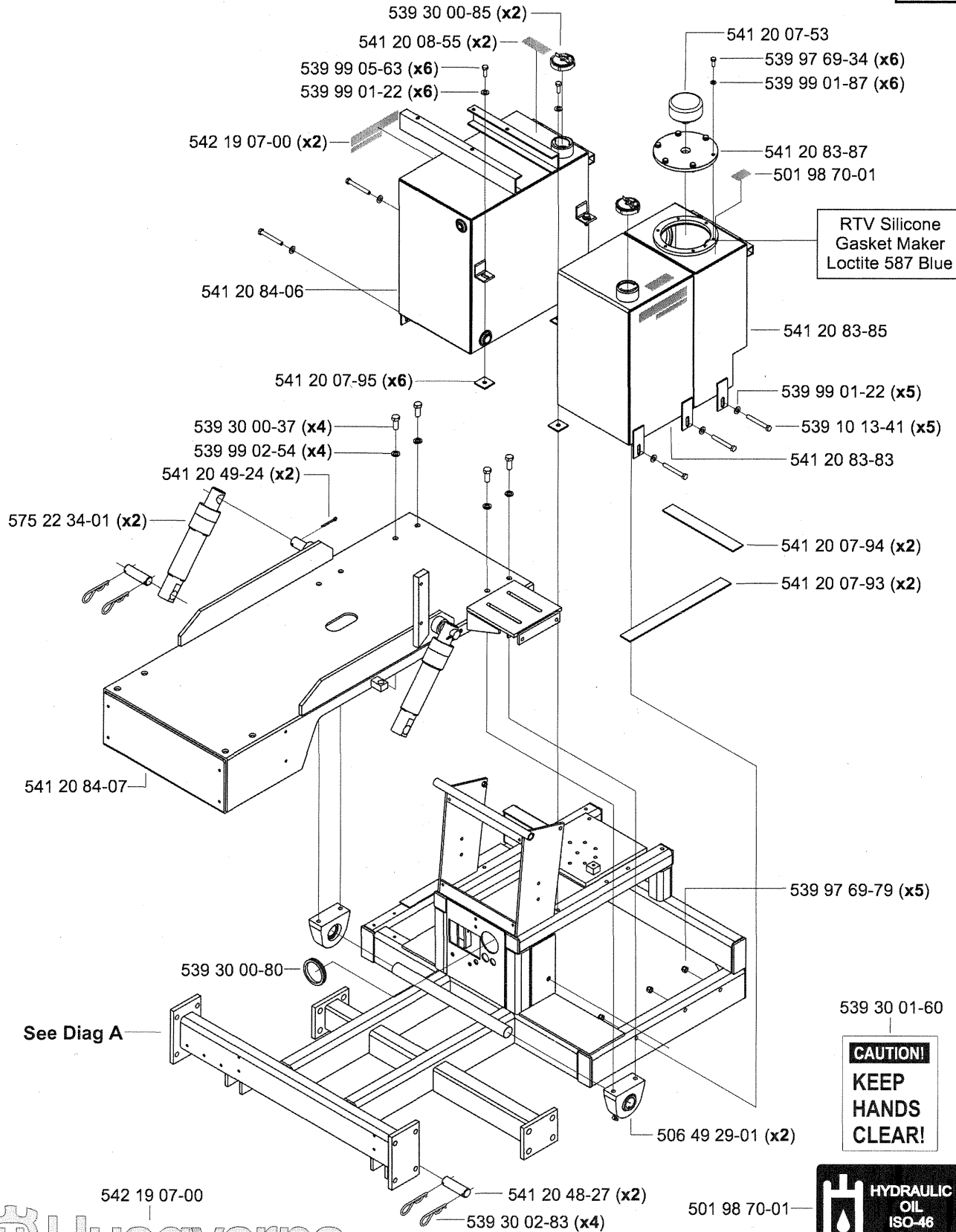
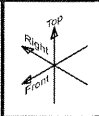

CAUTION!
KEEP HANDS CLEAR!



Husqvarna
RS 8500 D

C1 Fuel & Hydraulic Tanks

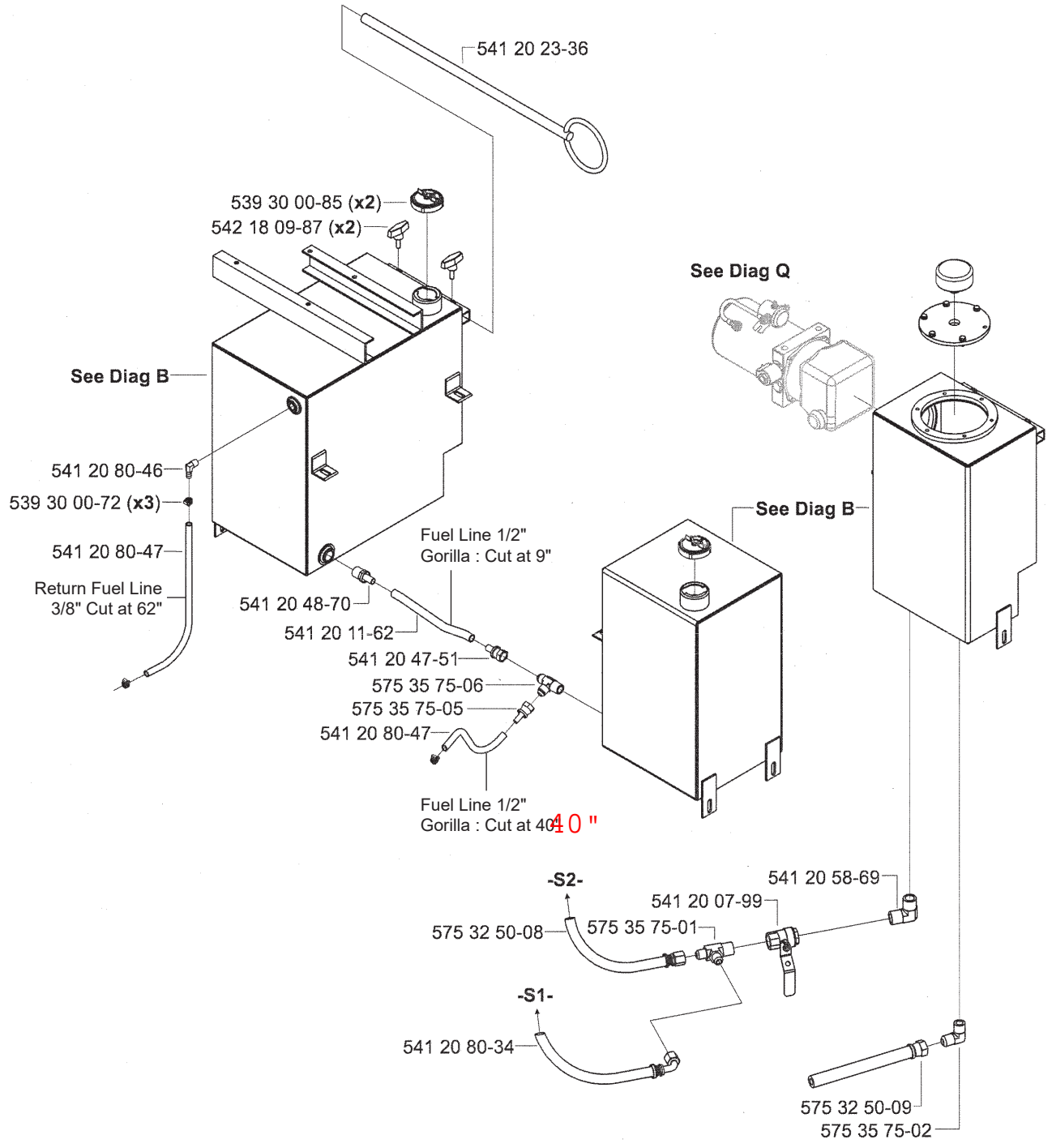
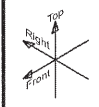

D Seat & Speed Control Lever

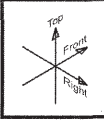

*541 20 01-29 - Compl
 Incls (See Diag L2):
 541 20 07-62 &
 541 20 48-29

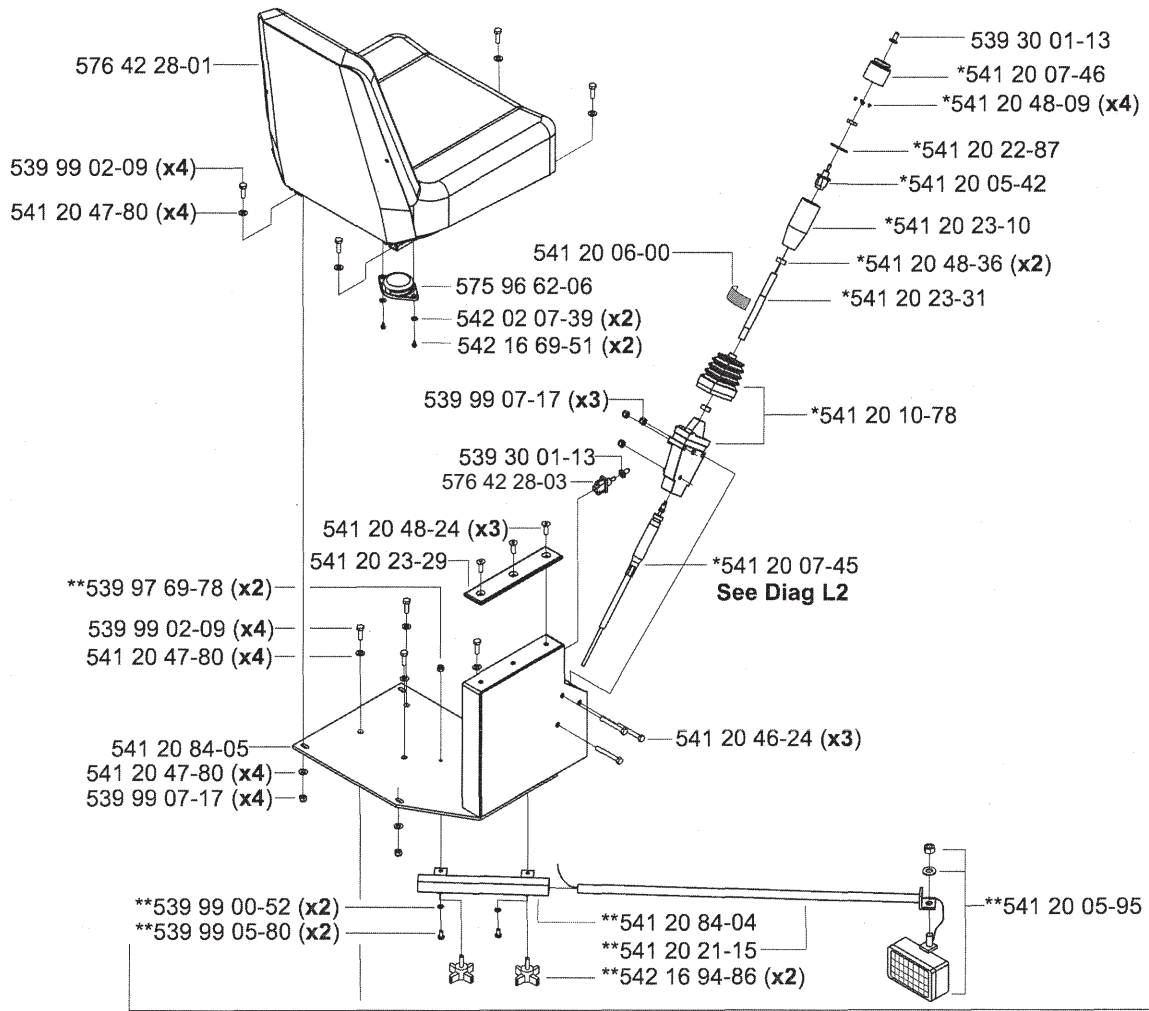

**541 20 00-37 - Compl

See Diag A

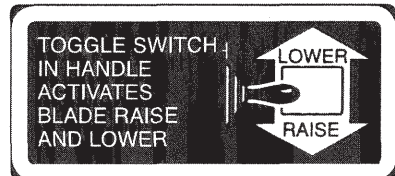
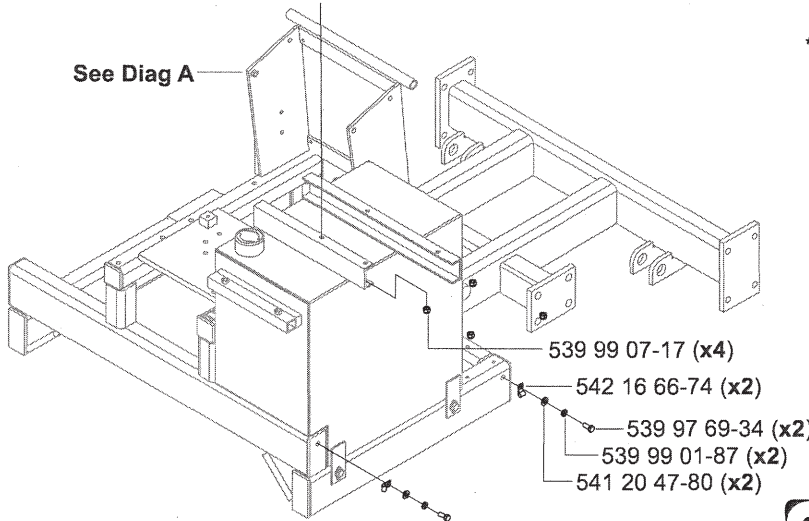

E Instrument Panel

See Diag A

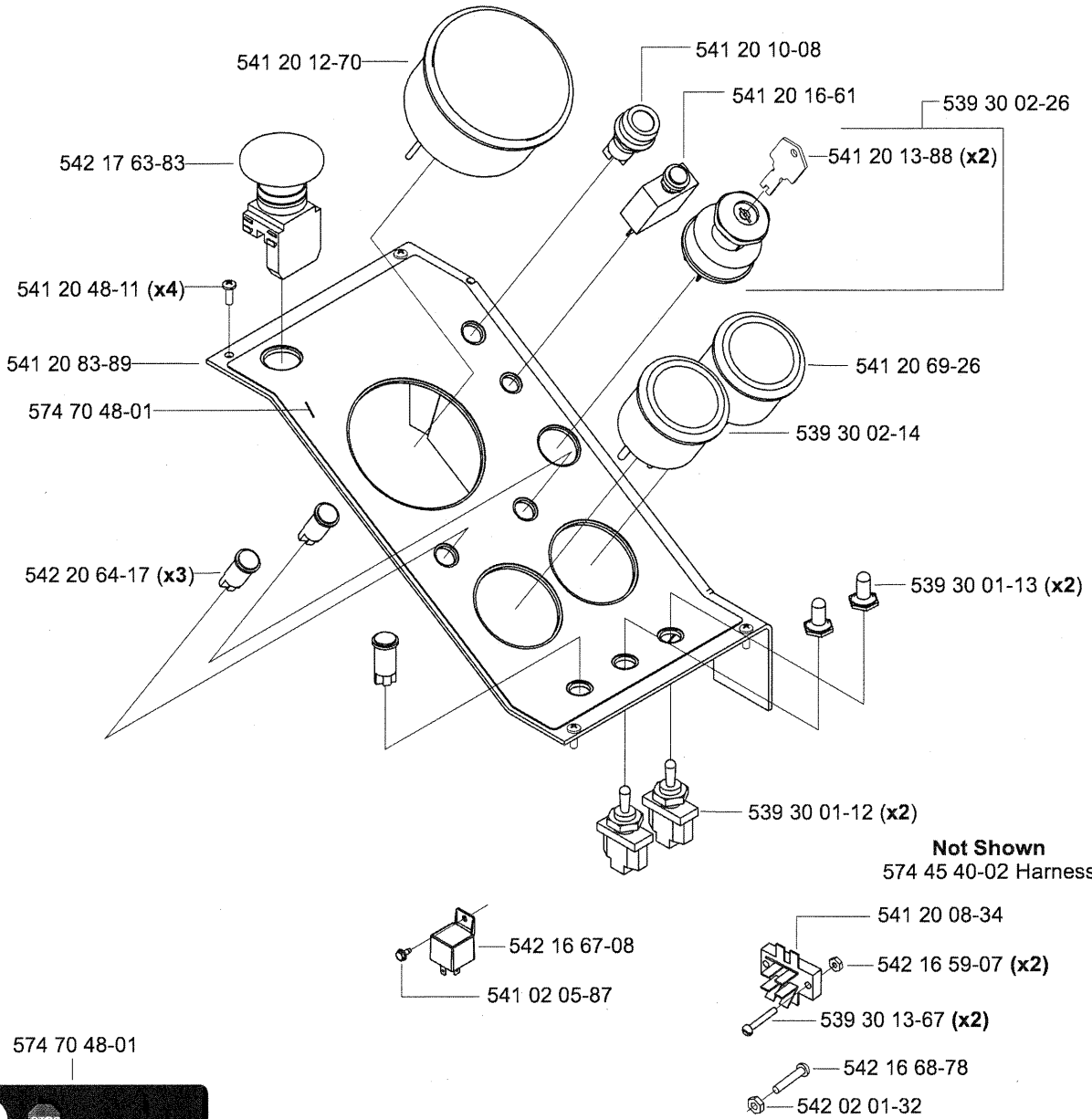
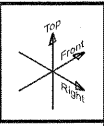

574 70 48-01

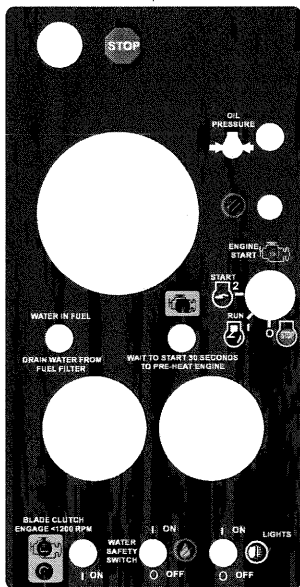

521 88 53-02

CAUTION

THE SAW *MUST BE LEVEL* WHEN THE ENGINE OIL IS CHECKED. SEVERE ENGINE DAMAGE *WILL* OCCUR IF THE ENGINE IS OVERFILLED WITH OIL.

F Engine Throttle

See Diag F1

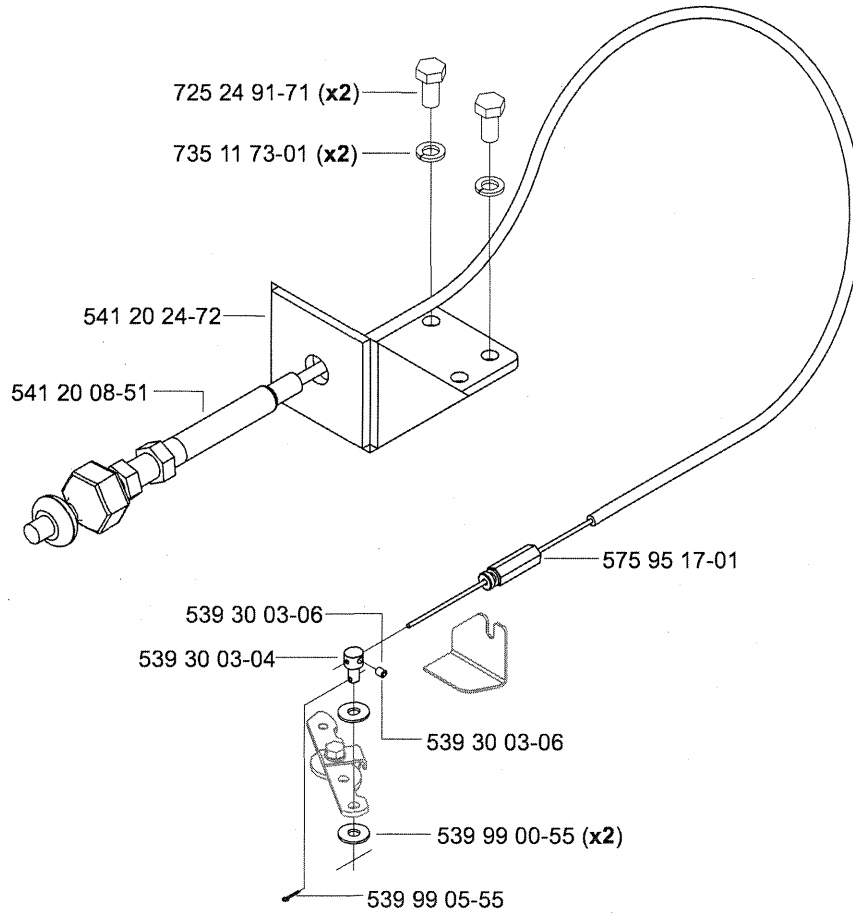

F1 Engine Throttle Attachment

Cummins B3.3 T3 Engine

- Service Parts -

- 542 20 51-40 Oil Filter
- 542 20 51-41 Fuel Filter
- 542 20 51-42 V-Belt

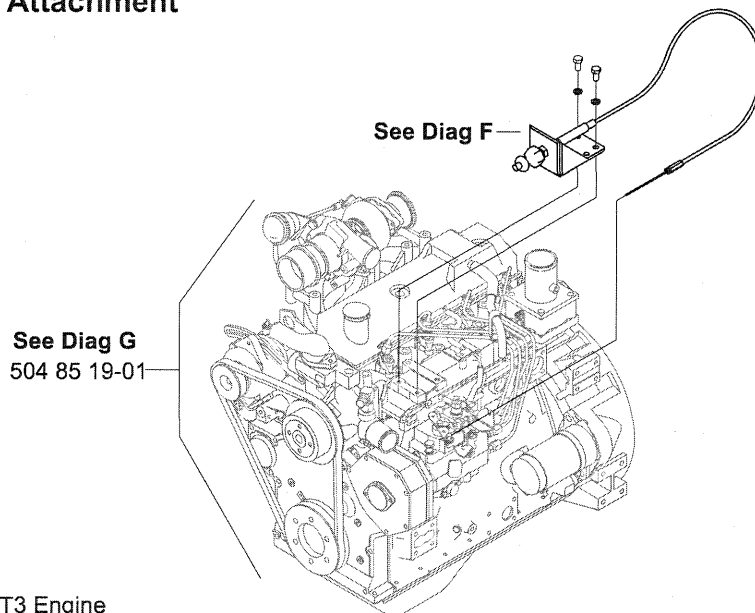

Not Shown

574 45 40-01 Wire Harness, T3 Engine

G Engine, Muffler, Air Cleaner

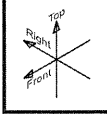

574 53 17-01 Compl
Includes:
 574 53 35-01 Primary Element
 574 53 35-02 Safety Element
 574 53 35-03 Vacuator Valve
 574 53 35-04 Cover Assy

Not Shown:
 541 20 09-89 Gauge, Restriction
 542 16 68-80 Adaptor, Indicator

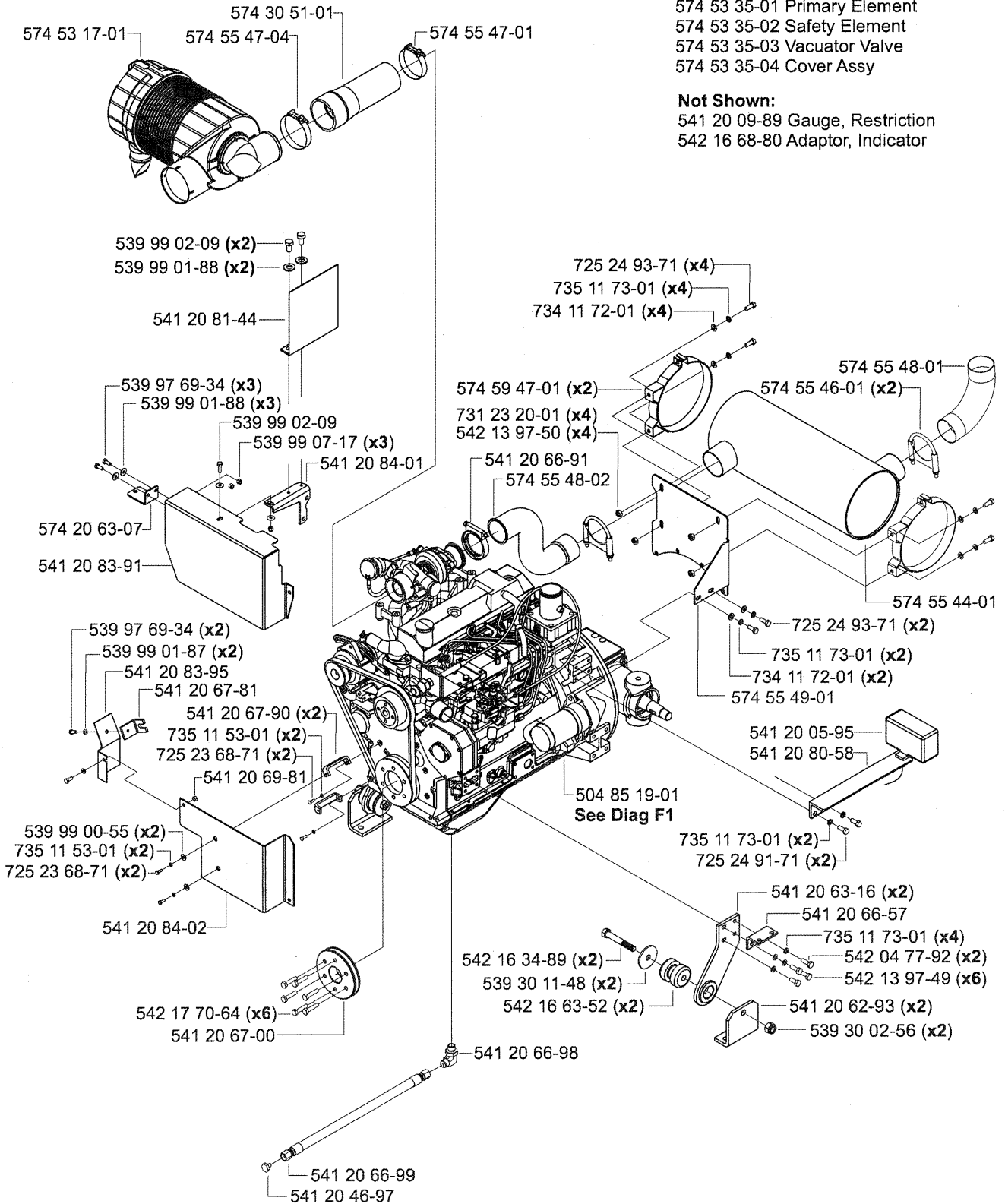

H Surge Tank & Radiator Fan

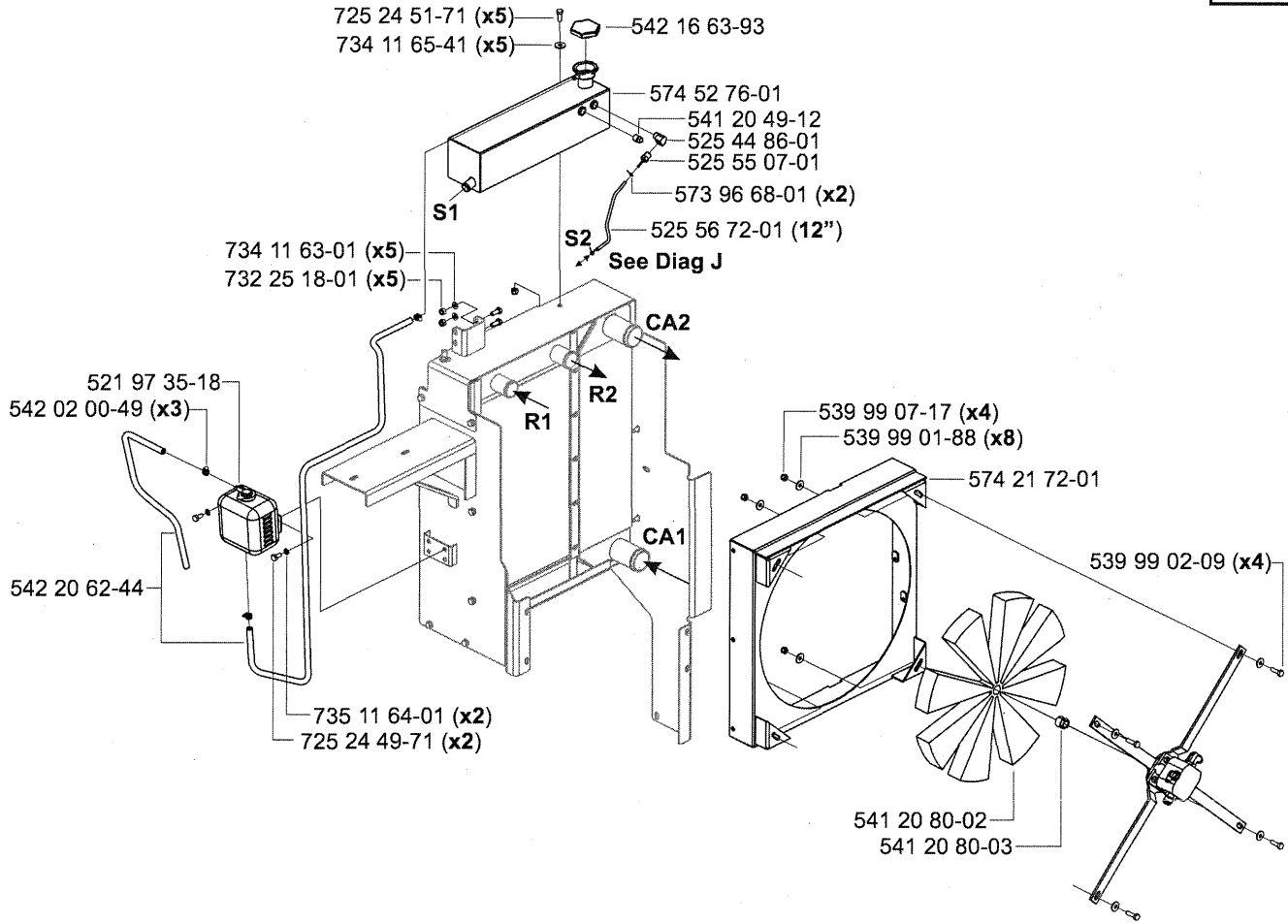

H1 Fan Motor

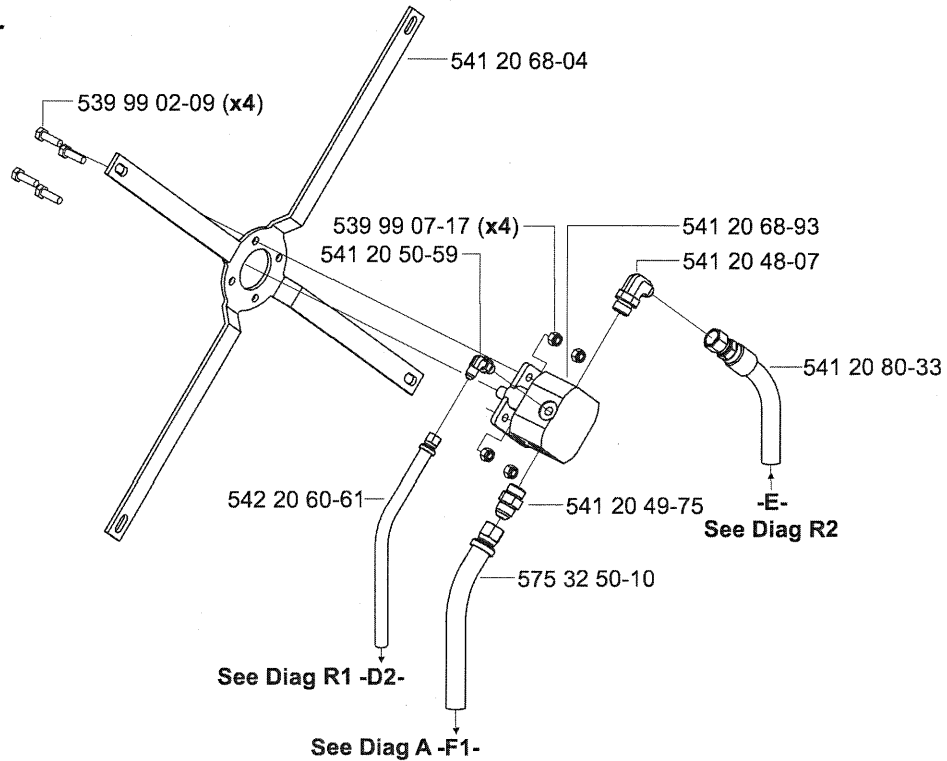

H2 Radiator & Filters

See Diag B1

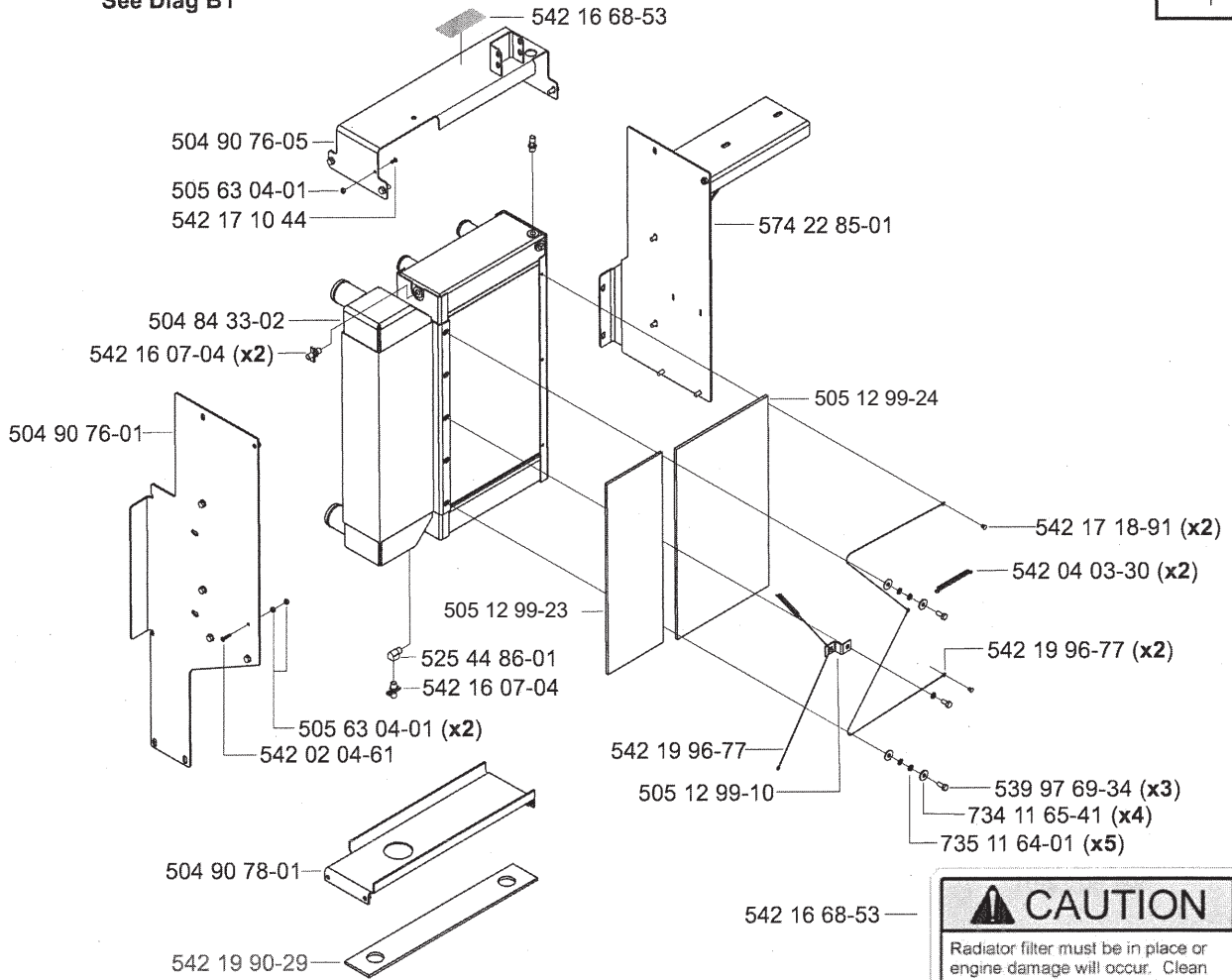

CAUTION
Radiator filter must be in place or engine damage will occur. Clean filter as required or every 50 hours.

H3 Air Cleaner Mount

See Diag G

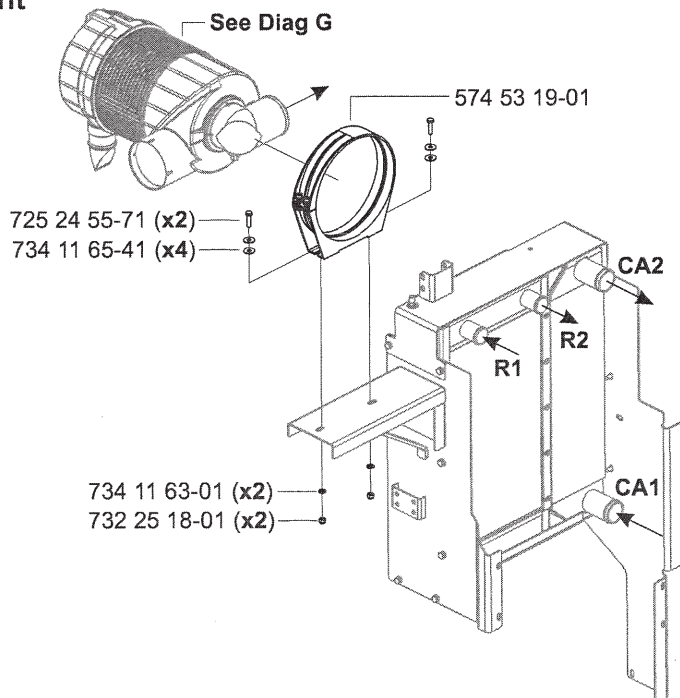

J Cooling

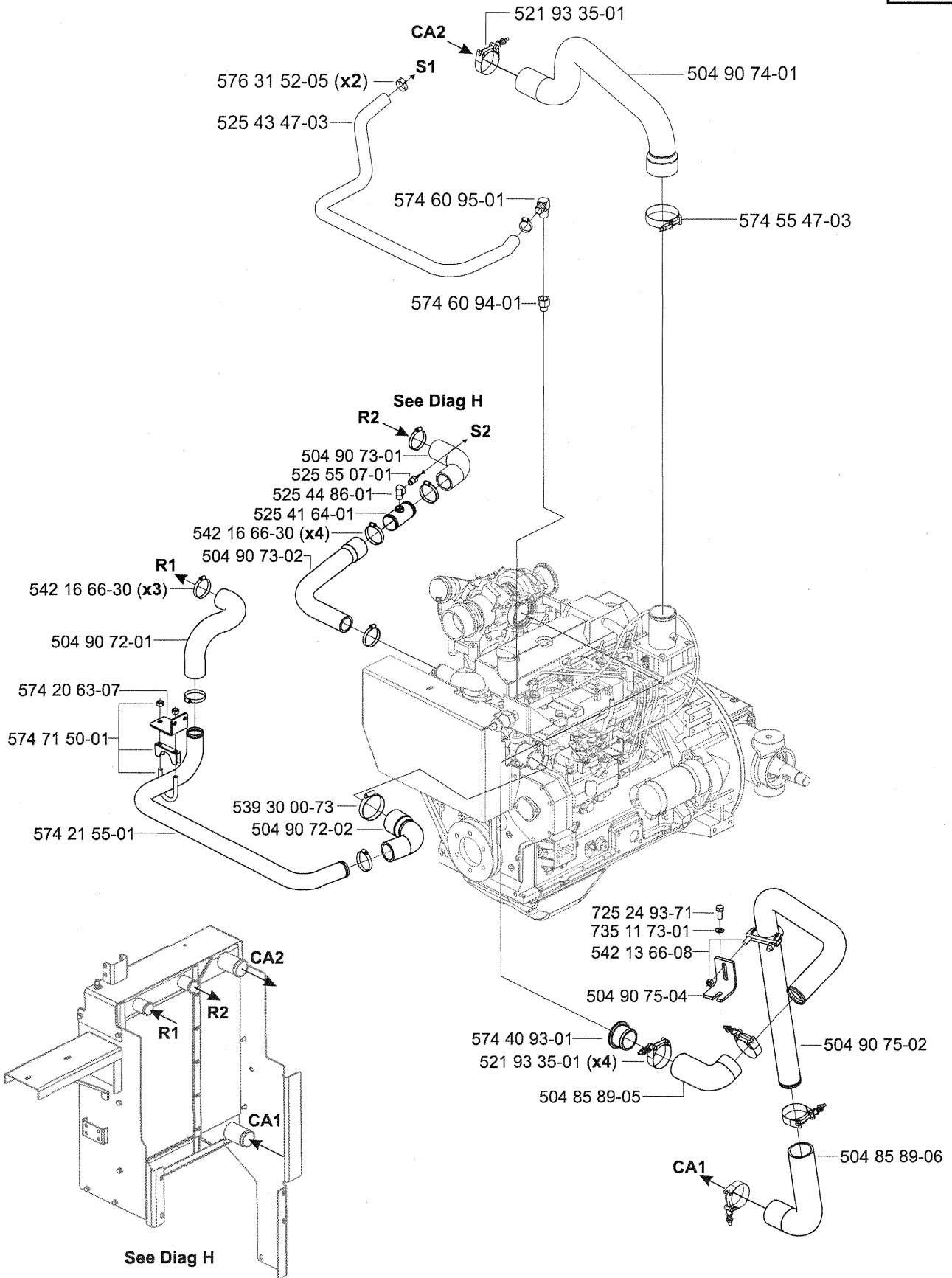
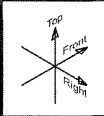

K1 Drive Wheel

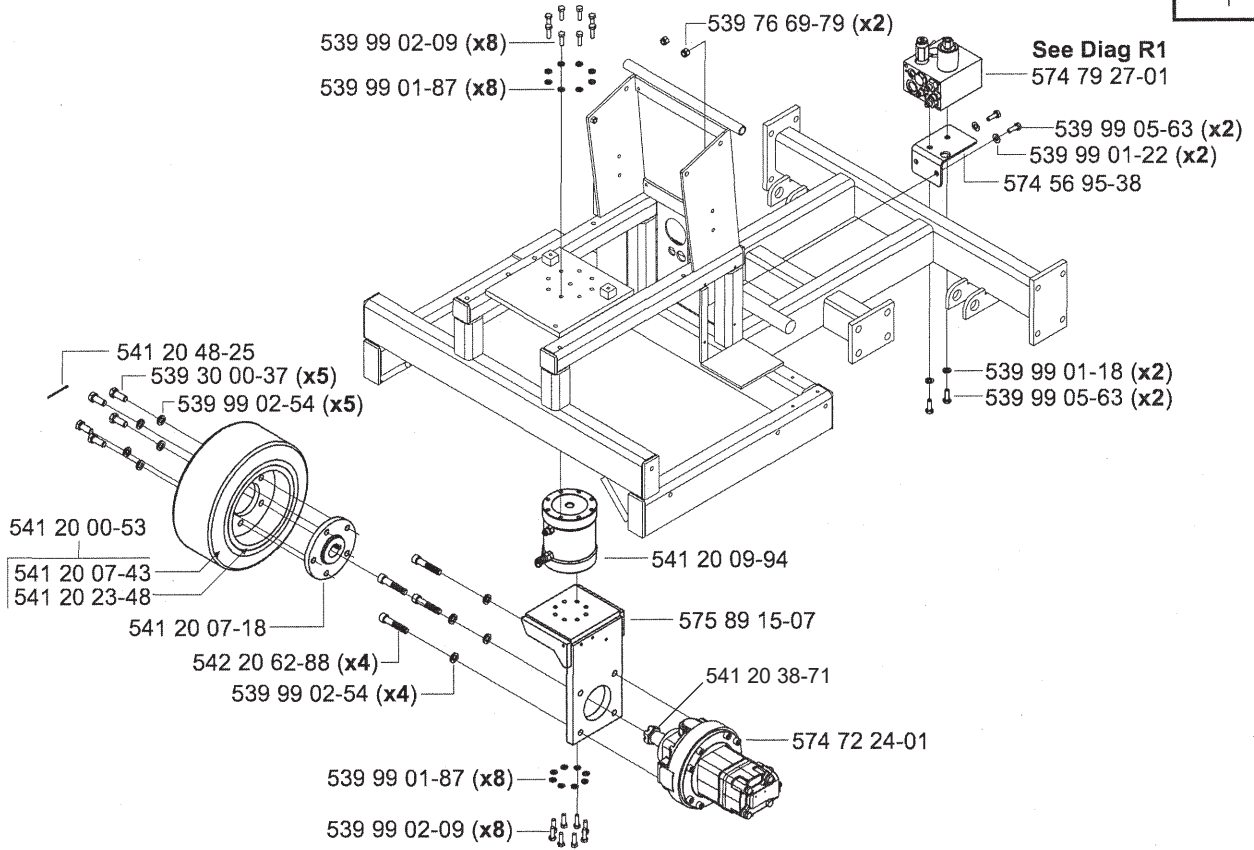
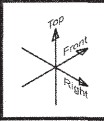

K2 Drive Wheel Hydraulics

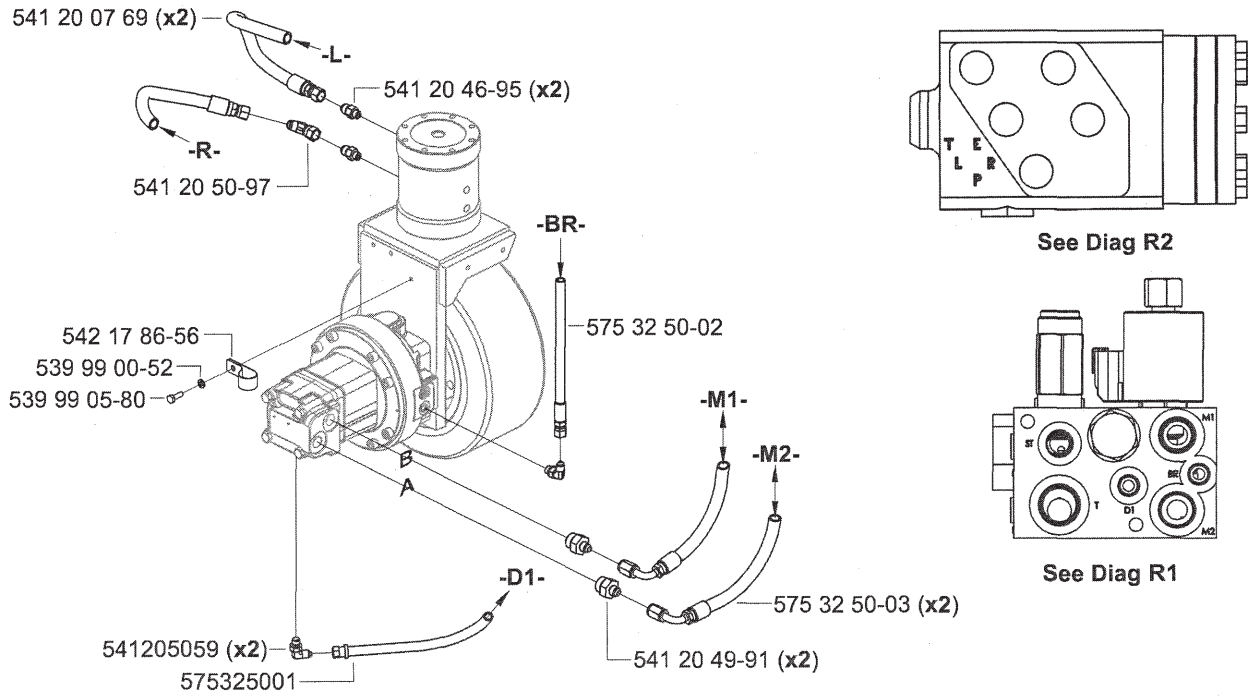
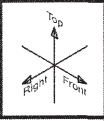

L1 Engine Pumps

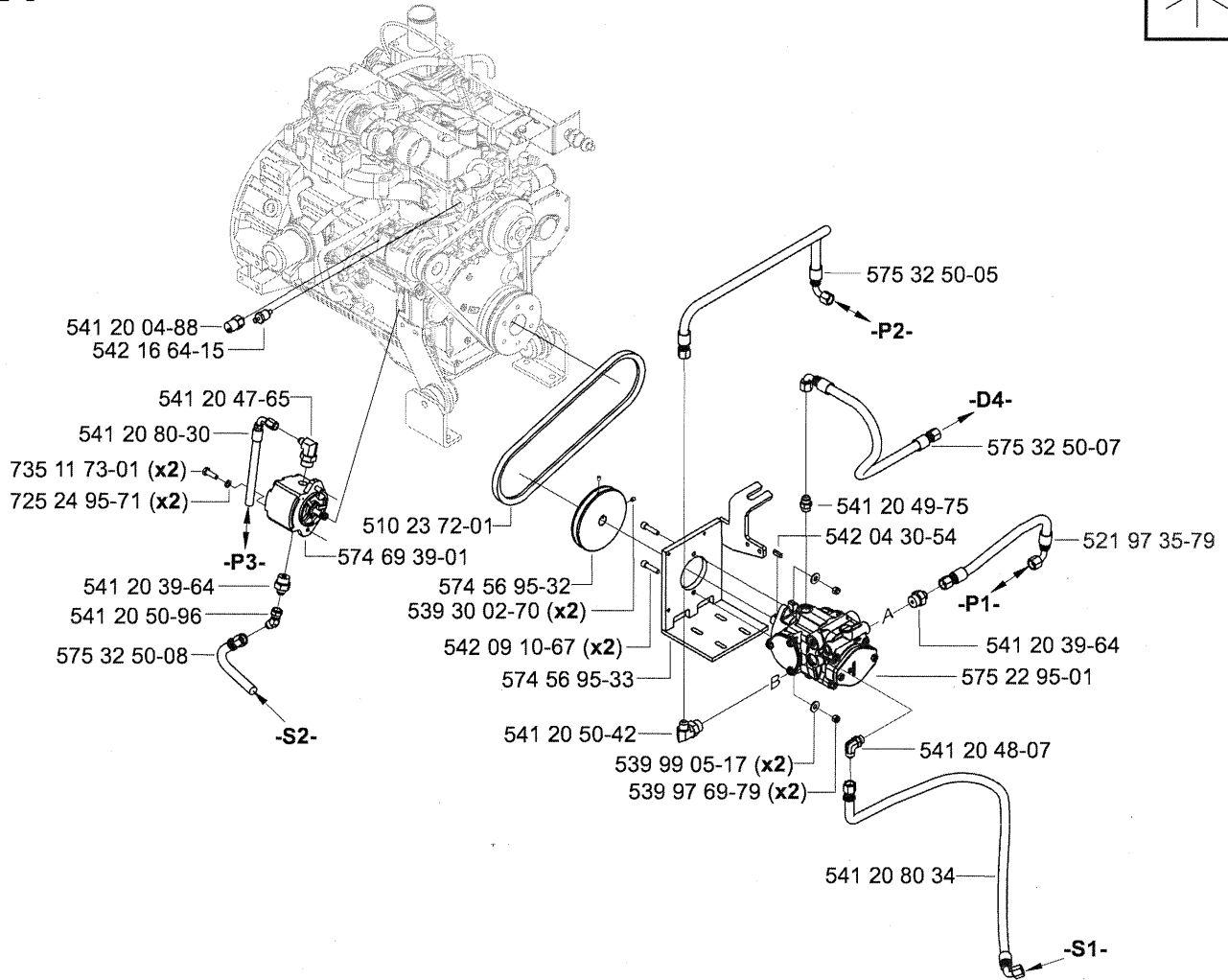
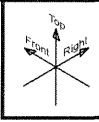

L2 Speed Control

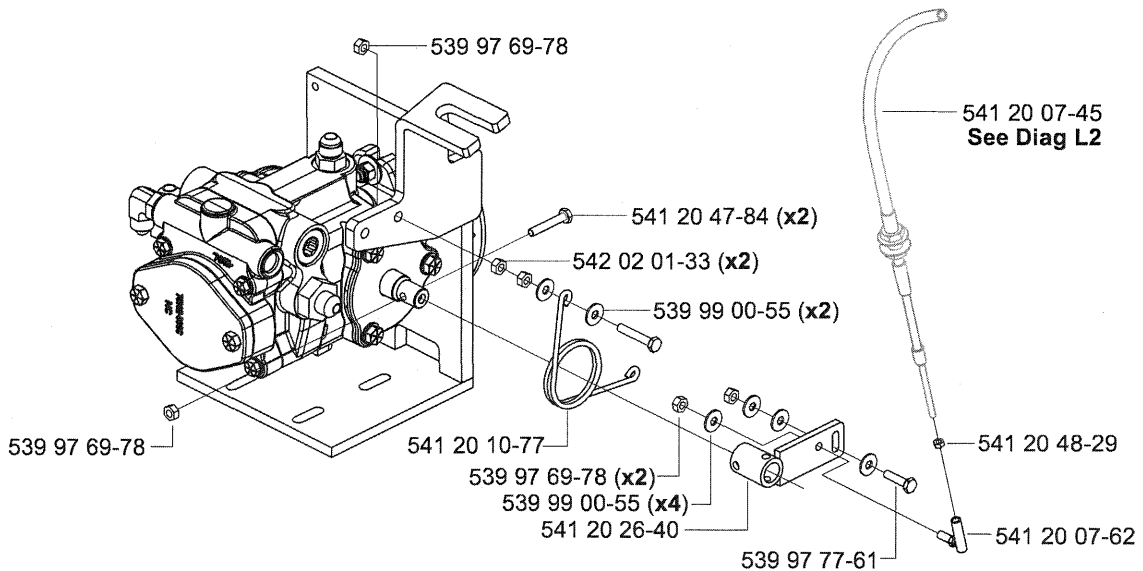
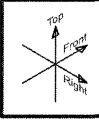

M Gearbox Mounting & Water Hoses

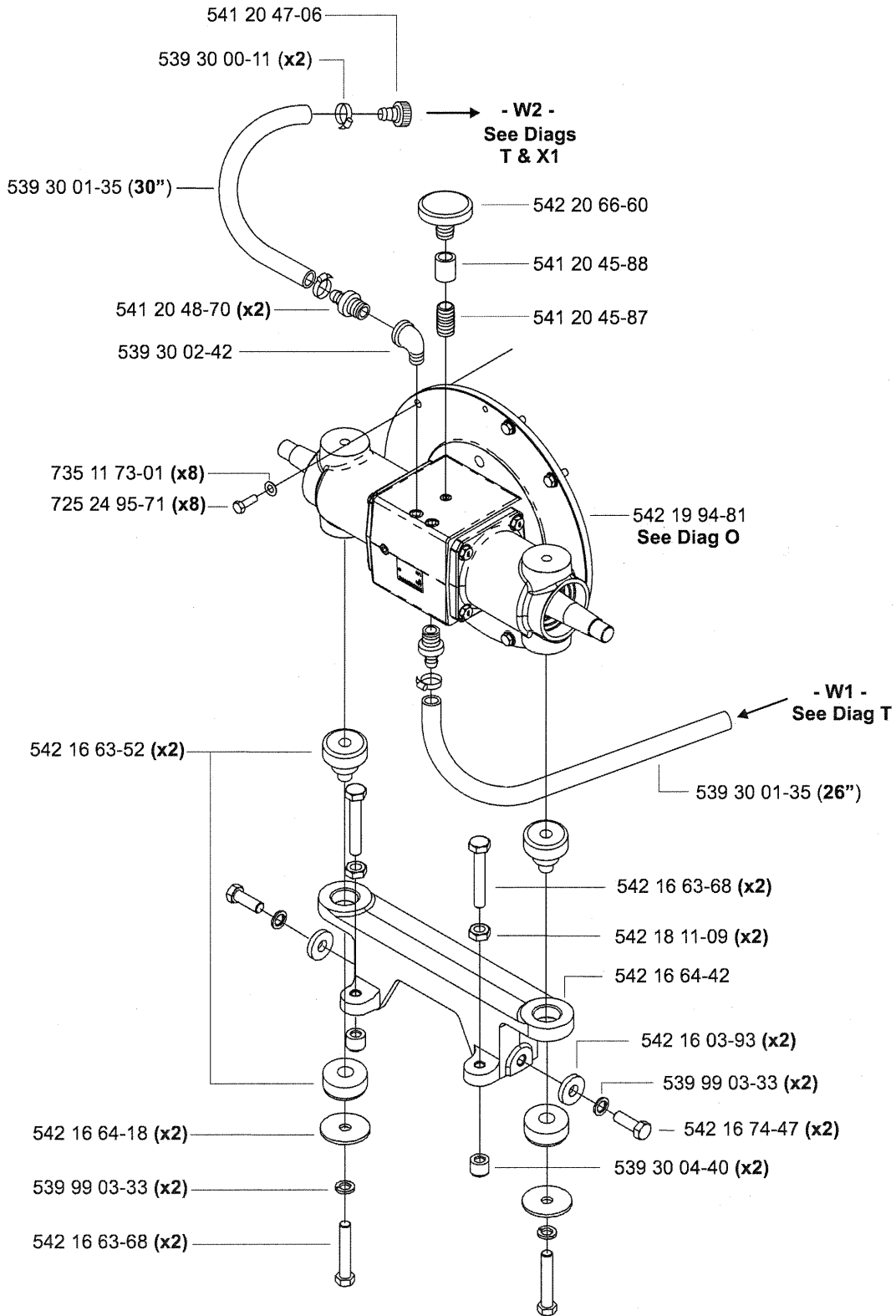

NOTE: Drain water when Temperature below 32°F (0°C).
See Diag L for Drain valve.

N1 Engine Gearbox - Drive Plate

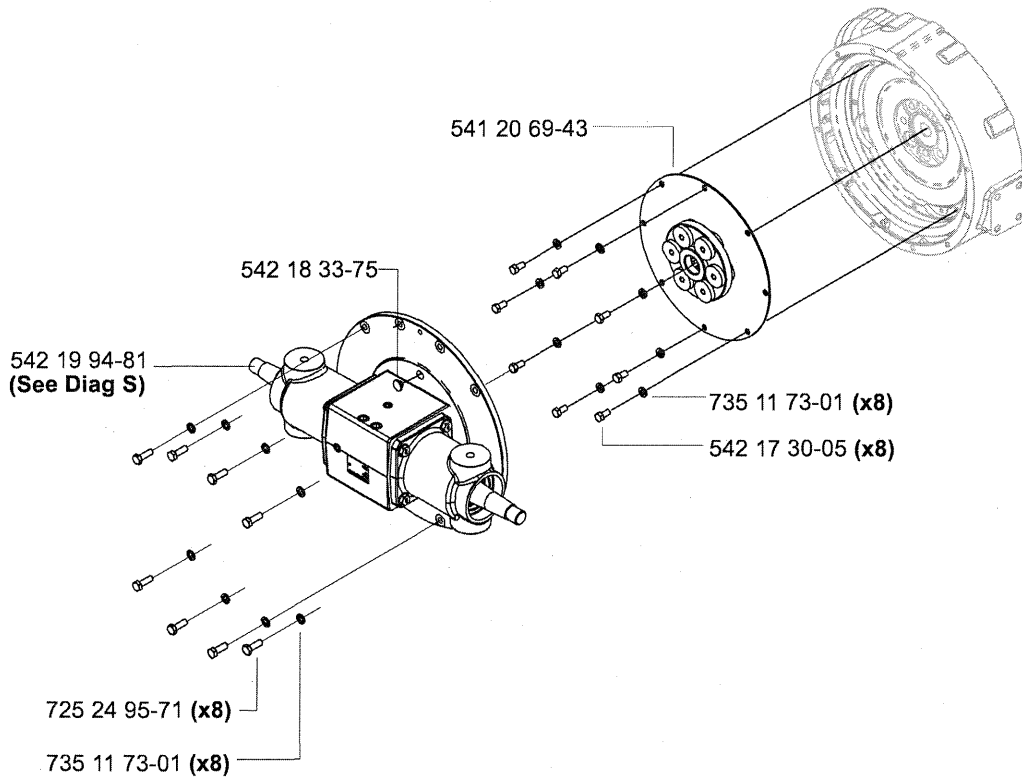
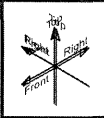

N2 Engine Gearbox - Clutch

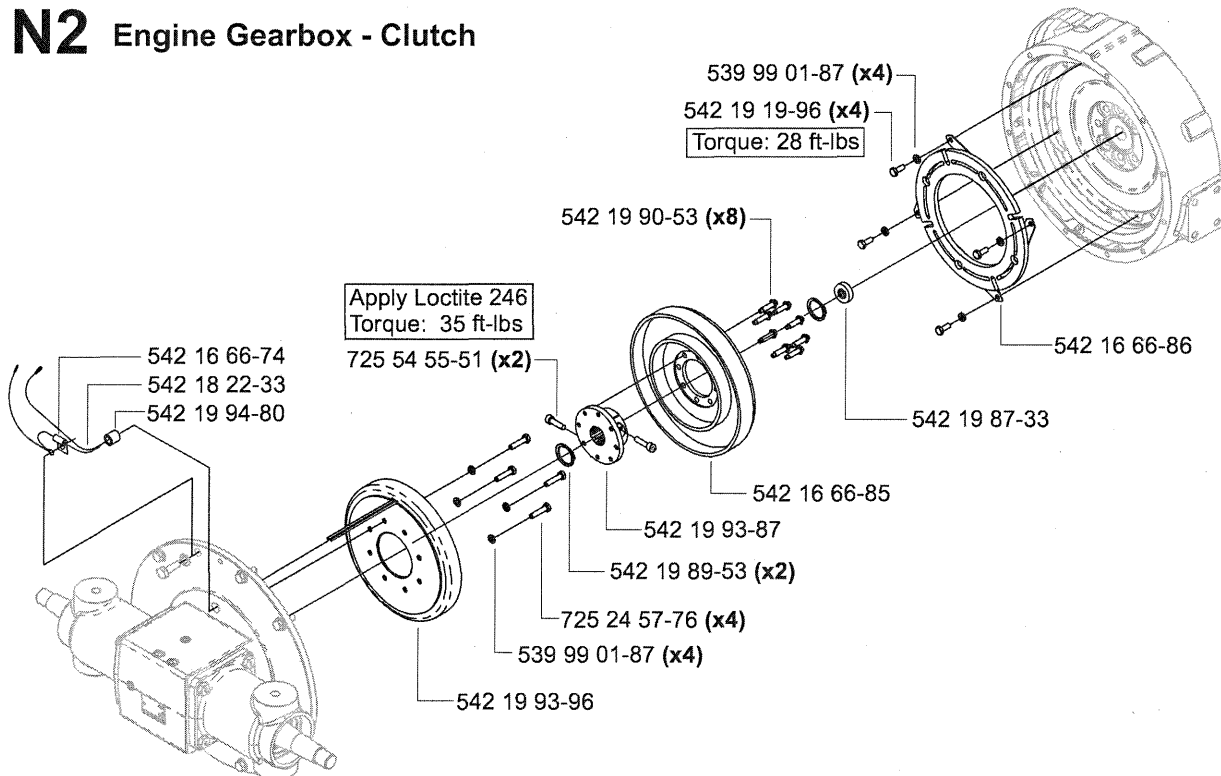
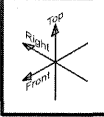

Gearbox-Blade Shaft

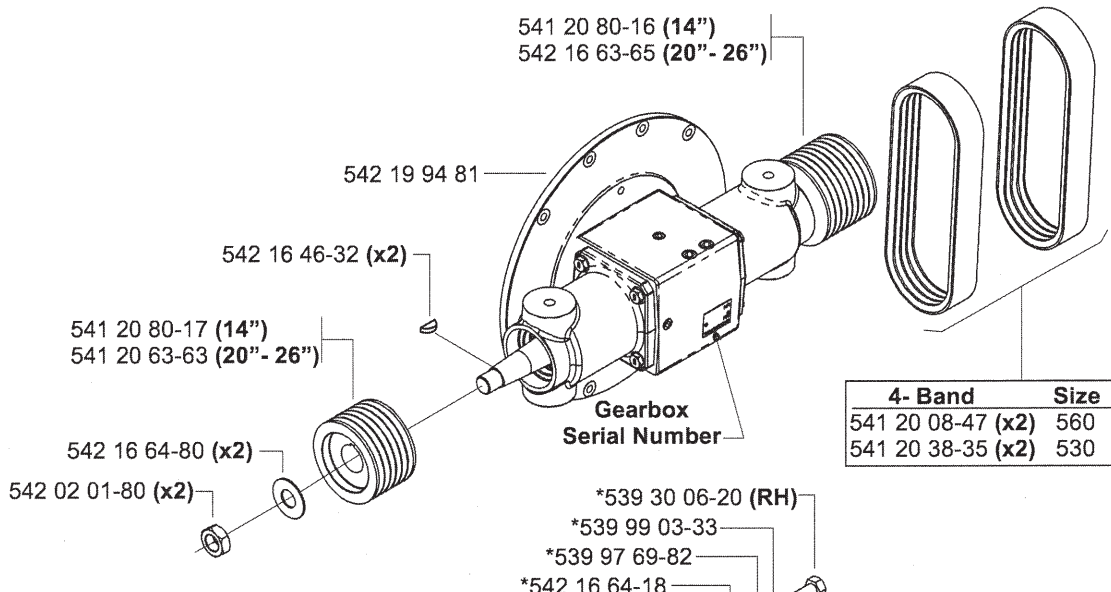
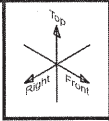

4- Band	Size	Blade
541 20 08-47 (x2)	560	14"
541 20 38-35 (x2)	530	20 - 26"

3- Band	Size	Blade
541 20 13-91 (x2)	560	14"
541 20 08-48 (x2)	530	20 - 26"

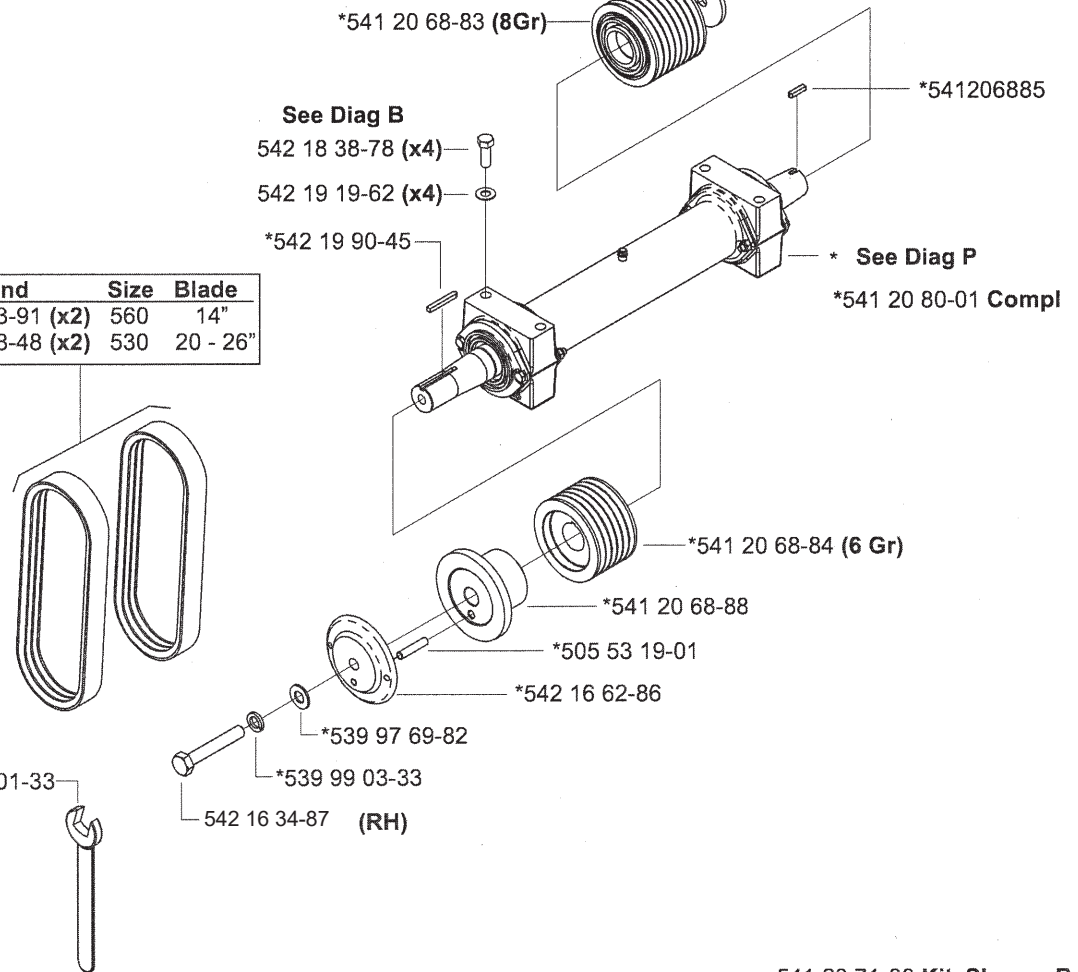

541 20 71-00 Kit, Sheave Puller (Optional)

P Blade Shaft

* Compl 541 20 80-01
See Diag O for other items included

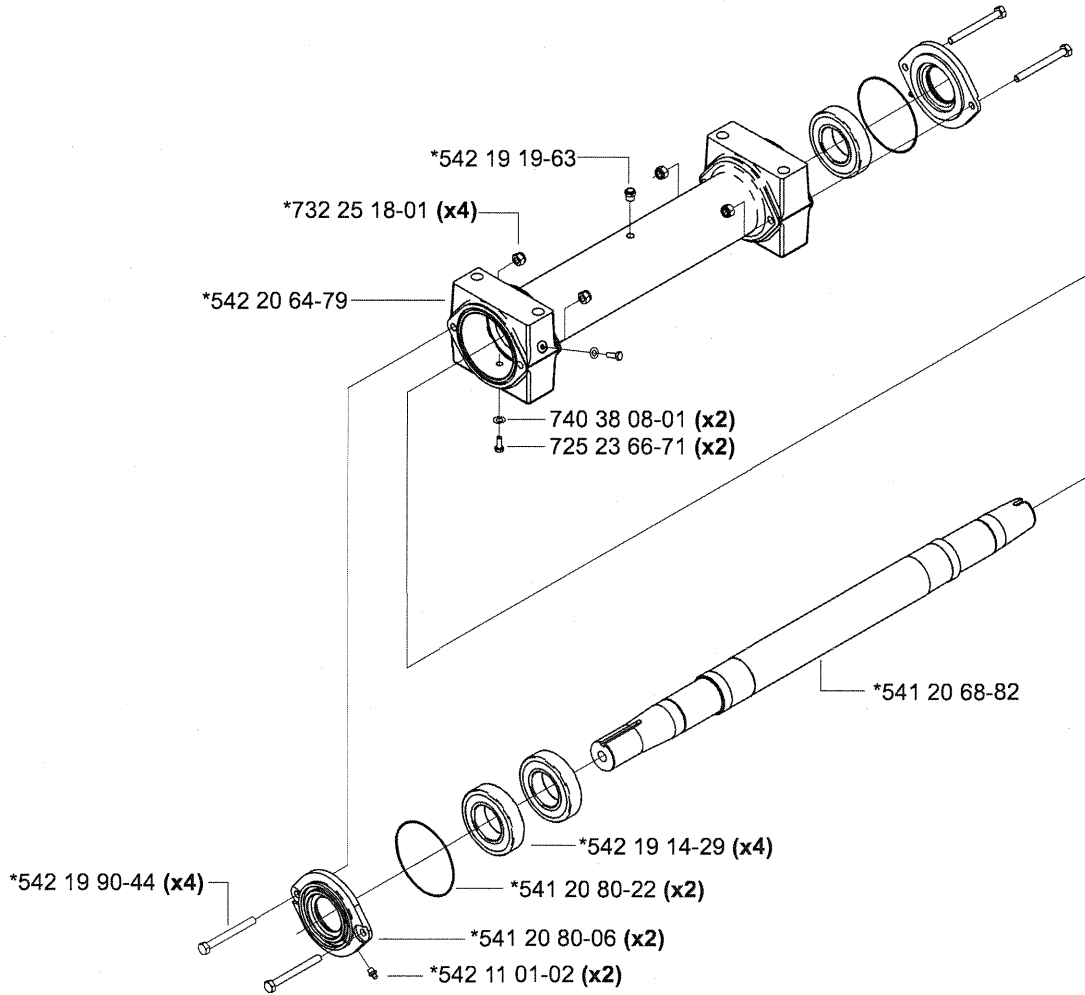
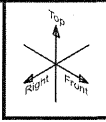

Q Lift Cylinder Hydraulics

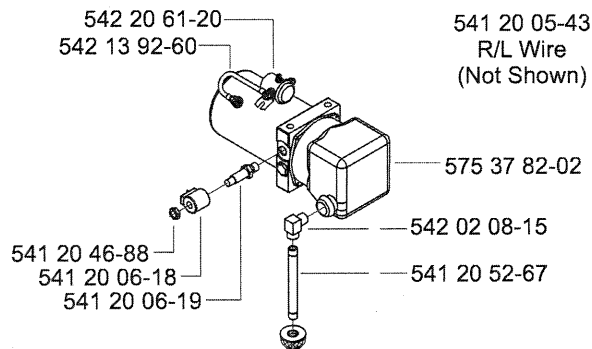
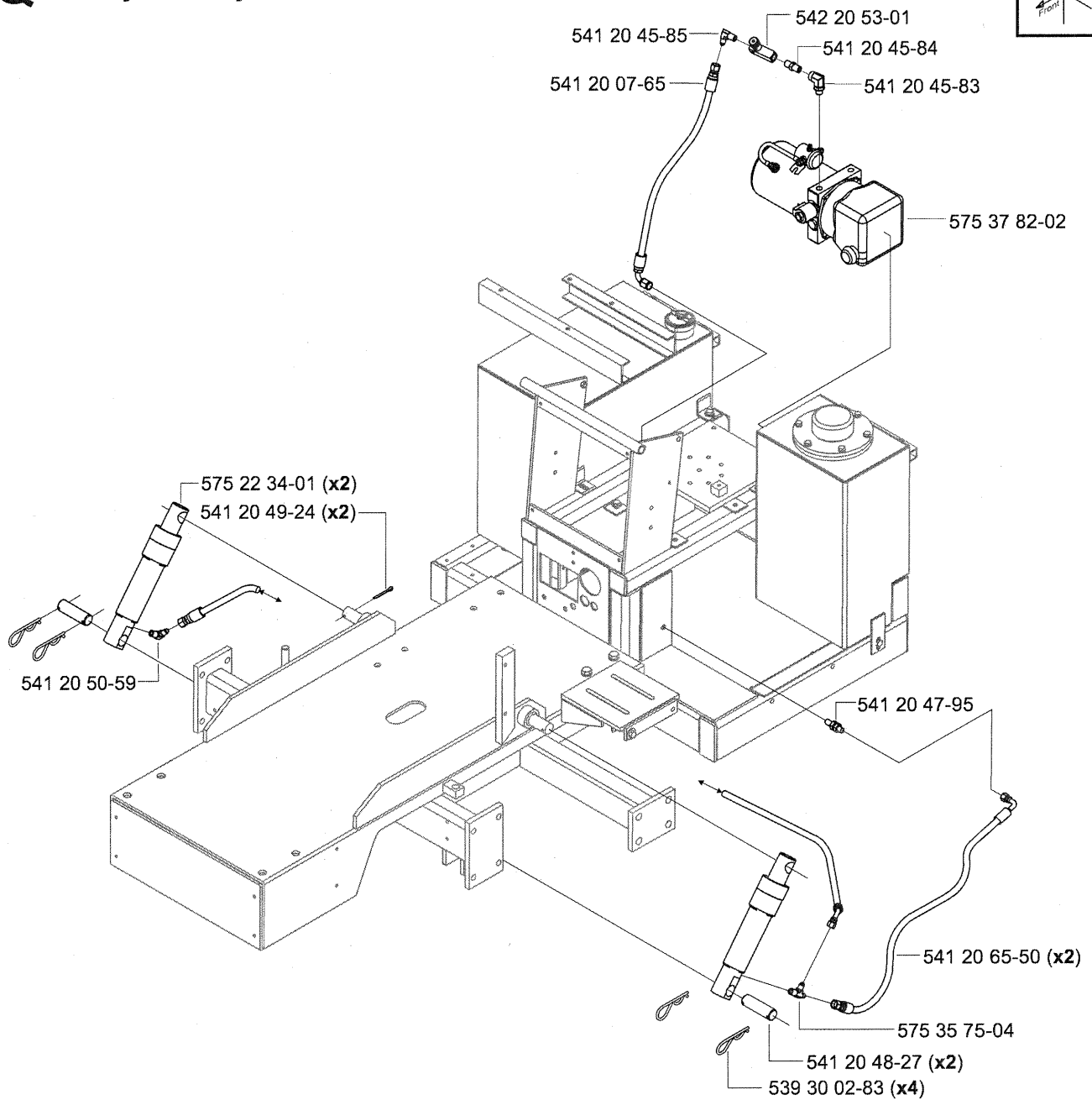
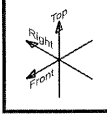

R1 Hydraulic Manifold

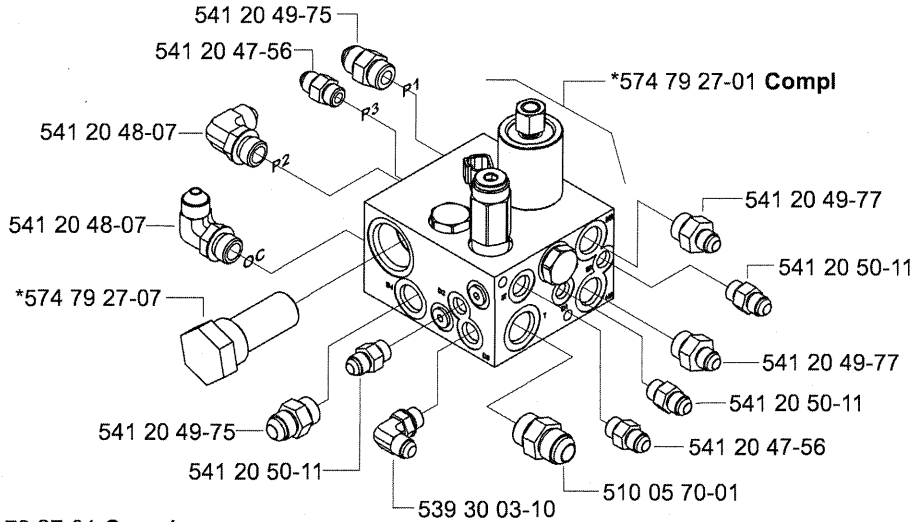
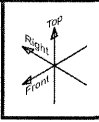

574 79 27-01 Compl

Includes:

- 574 79 27-09 Valve, Check
- 574 79 27-05 Valve, Shuttle
- 574 79 27-08 Nut, Solenoid
- 574 79 27-07 Cartridge, Filter
- 574 68 33-03 Valve, Check
- 574 68 33-02 Valve, Relief
- 574 79 27-04 Coil, Solenoid 12VDC
- 574 79 27-03 Valve, Solenoid

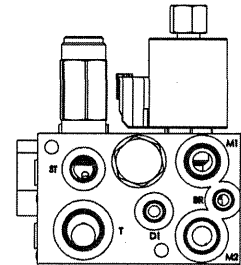
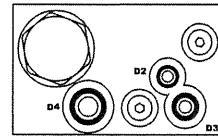
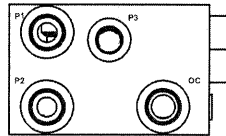

574 79 27-01
See Diag N1

R2 Steering Hydraulics

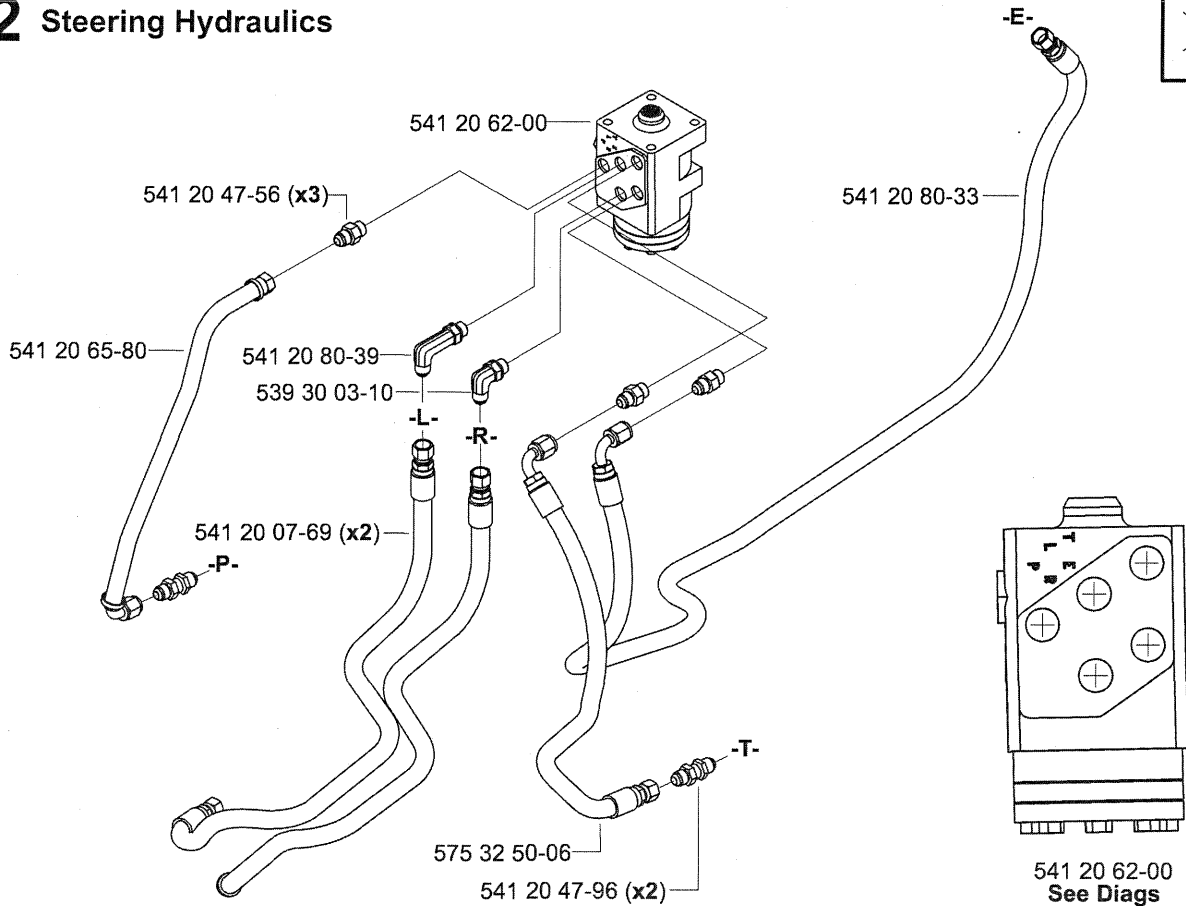
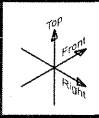

541 20 62-00
See Diags
A & N2

S Pointer Assembly

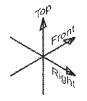

584808301

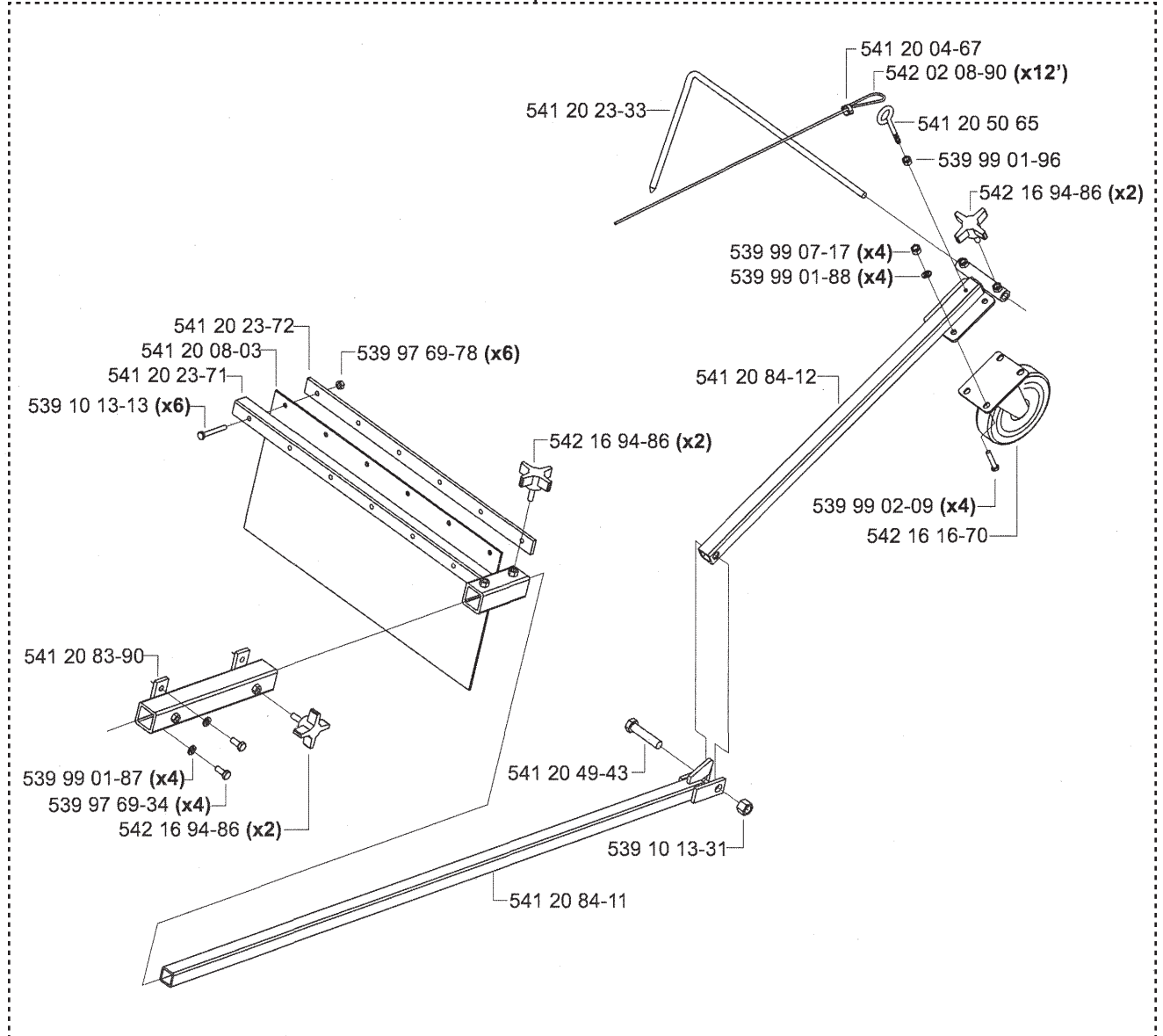

T Water System

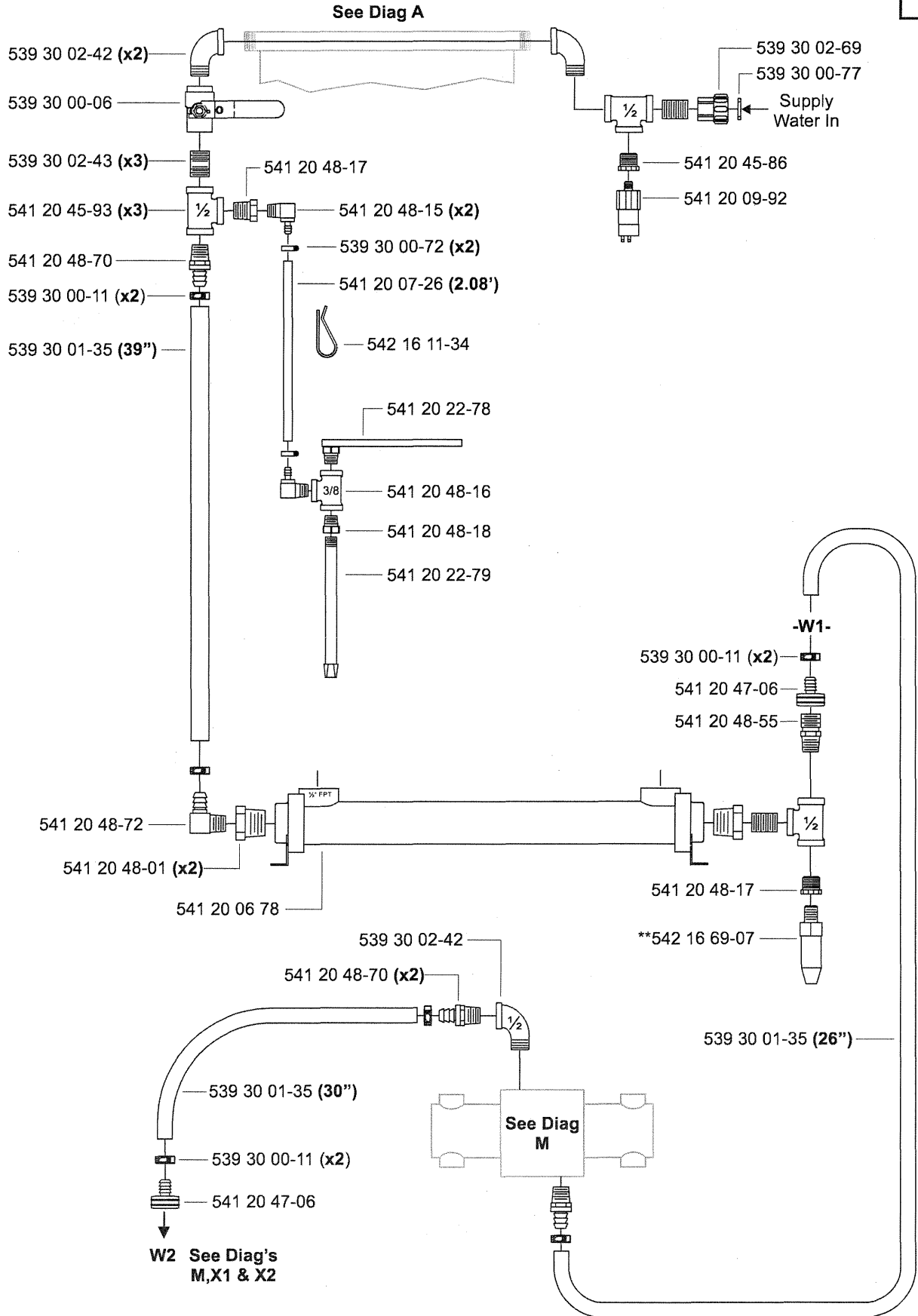

****NOTE:** Drain water when Temperature below 32°F (0°C).

U Hydraulic System

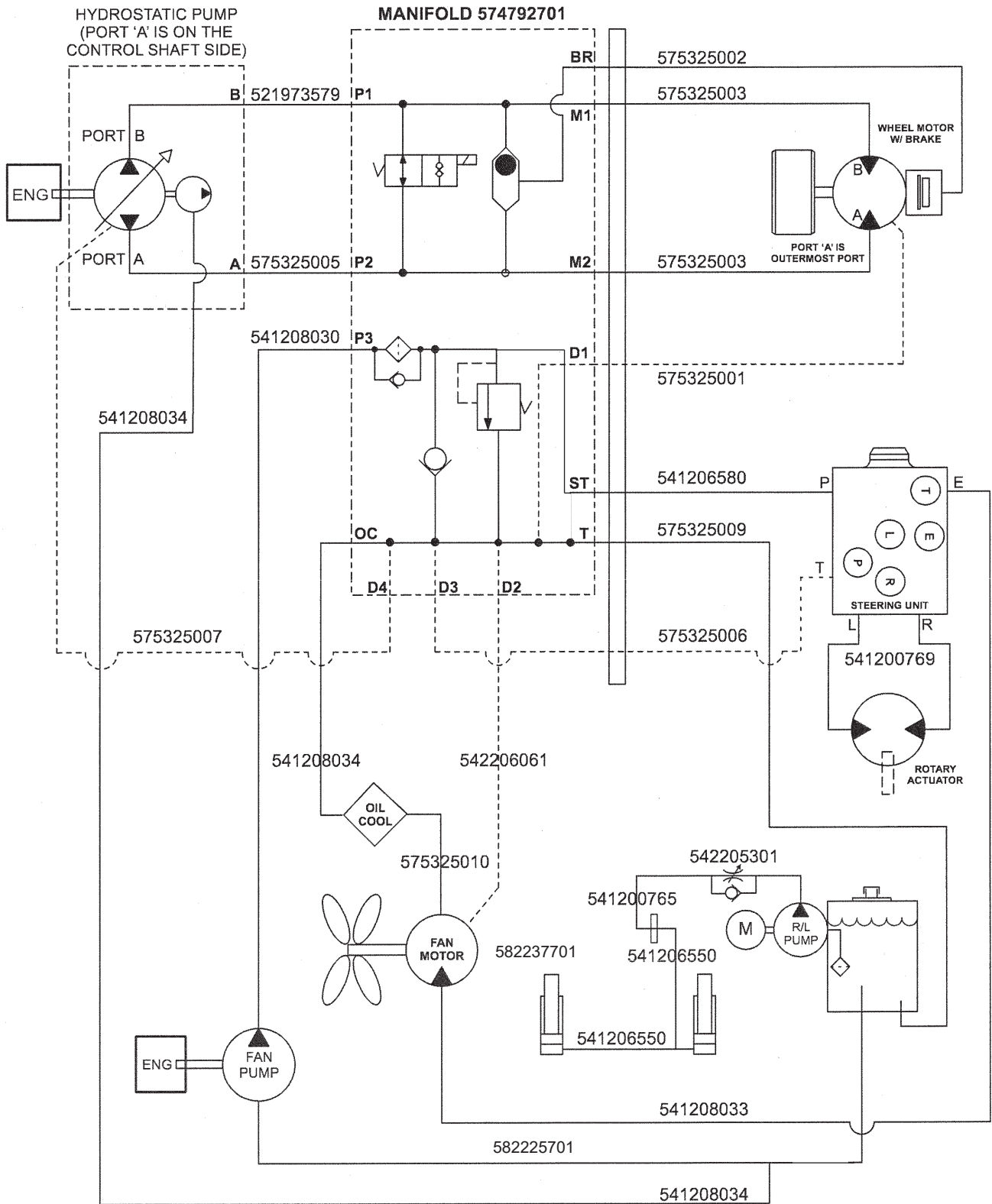

X1 Blade Guard - Up Cut

Compl 14" (356mm) - 541 20 69-77
 Compl 20" (508mm) - 541 20 69-78
 Compl 26" (660mm) - 541 20 69-79

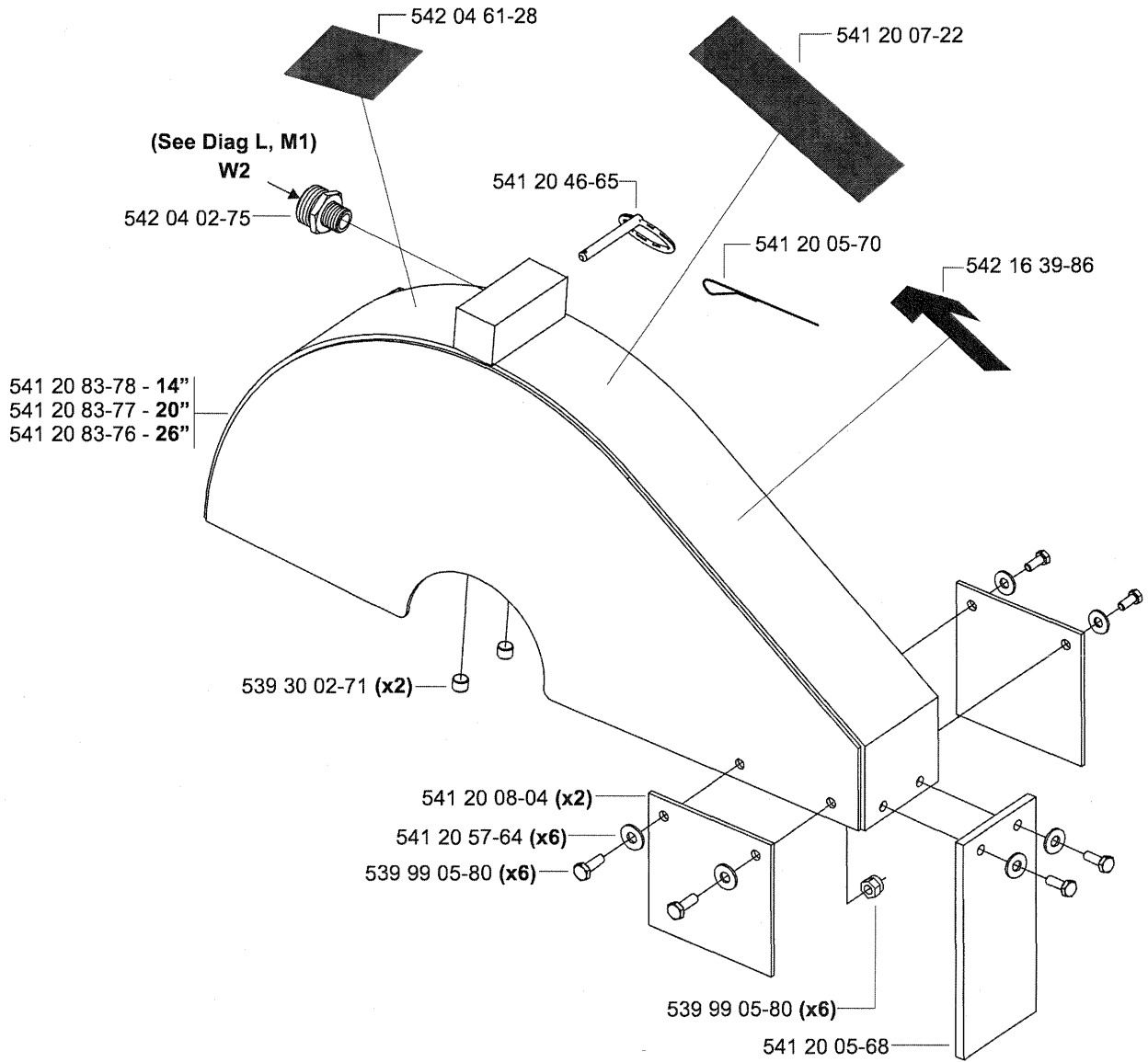
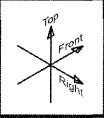

WARNING

TO PREVENT SERIOUS INJURY
DO NOT OPERATE SAW
WITHOUT PROPER TRAINING
& FULL UNDERSTANDING
OF THE OWNER'S MANUAL

WHEN OPERATING THIS MACHINE
KEEP ALL
GUARDS IN
PLACE

ALWAYS WEAR SAFETY APPROVED

- HEARING PROTECTION
- EYE OR FACE PROTECTION
- HEAD PROTECTION
- RESPIRATOR

S.M.I. MASONRY AND CONCRETE
SAW MANUFACTURERS INSTITUTE

541 20 07-22

542 04 61-28

WARNING

DO NOT CHANGE TO A
LARGER BLADE GUARD SIZE
WITHOUT CHANGING TO
PROPER BELT DRIVE, ENGINE
SPEED AND BLADE FLANGES.
FAILURE TO COMPLY COULD
RESULT IN DEATH OR
SERIOUS BODILY INJURY.
SEE OPERATOR'S MANUAL FOR
INSTRUCTIONS. IF YOU DO NOT
HAVE AN OPERATOR'S MANUAL,
CALL TOLL FREE 1-800-288-5040

542 16 39-86



NOTES:

Husqvarna Construction Products N. A.
Corporate Office
17400 West 119th Street
Olathe, Kansas 66061
Tel. 913-928-1000
Fax 913-438-7951

Customer Service: 800-288-5040
Customer Serv. Fax: 800-825-0028



DUST WARNING



Cutting, especially when DRY cutting, generates dust that comes from the material being cut, which frequently contains silica. Silica is a basic component of sand, quartz, brick clay, granite and numerous other minerals and rocks. Exposure to excessive amount of such dust can cause:

- Respiratory diseases (affecting your ability to breath), including chronic bronchitis, silicosis and pulmonary fibrosis from exposure to silica. These diseases may be fatal;
- Skin irritation and rash; and
- Cancer according to NTP* and IARC*
*National Toxicology Program / International Agency for Research on Cancer

Take precautionary steps

- Avoid inhalation of and skin contact with dust, mist and fumes;
- Wet cut when feasible, to minimize dust;
- Wear and ensure that all bystanders wear appropriate respiratory protection such as dust masks designed to filter out microscopic particles. (See OSHA 29 CFR Part 1910.1200)

California Prop 65 Warning:

Use of this product can cause exposure to materials known to the State of California to cause cancer and/or birth defects or other reproductive harm.

 **Husqvarna**[®]

Printed in the USA